

Operating Instructions

**M-417/427/427C/437/
529V/539V/579V**

Sony Corporation © 1996 Printed in China

Owner's Record

The model number is located at the bottom and the serial number is located inside the battery compartment. Record these numbers in the spaces provided below. Refer to these numbers whenever you call upon your Sony dealer regarding this product.

Model No. _____ Serial No. _____

WARNING

To prevent fire or shock hazard, do not expose the unit to rain or moisture.

Welcome!

Thank you for purchasing the Sony Microcassette-Corder. Some features are:

- The BATT lamp indicates when to replace the batteries.
- The VOR (Voice Operated Recording) system (M-529V/539V/579V only) starts and stops recording automatically in response to the sound.
- Edit function—You can start recording directly from the playback mode by pressing the ● button to correct a previously recorded portion.
- Tape counter (M-529V/539V/579V only)
- Automatic shut-off mechanism at the end of the tape (in the recording/playback mode only)
- Stop-pause-release function—The pause switch is released automatically when the ■▲ button is depressed, so that you don't miss a recording chance.

About This Manual

The instructions in this manual are for the M-417, M-427, M-427C, M-437, M-529V, M-539V and M-579V. Before you start reading, check your model number. The M-529V is the model used for illustration purposes. Any differences in operation are clearly indicated in the text, for example, "M-529V only".

This warranty is valid only in the United States.

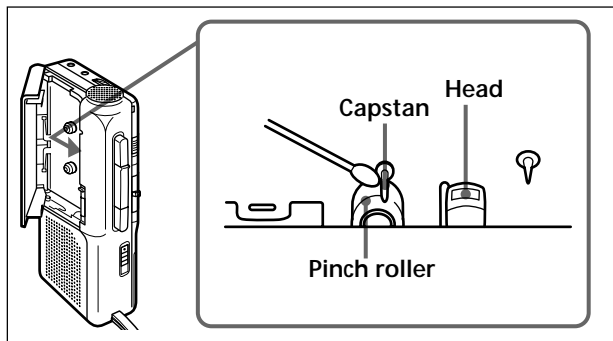
Maintenance**To clean the tape head and path**

Press ◀ and wipe the head, capstan and the pinch roller with a cotton swab, moistened with alcohol every 10 hours of use.

To clean the exterior

Use a soft cloth slightly moistened in water. Do not use alcohol, benzine or thinner.

Specifications

Tape
MICROCASSETTE™ (normal position type)

Recording system
2-track 1-channel monaural

Speaker
Approx. 3.6 cm (1⁷/₁₆ in.) dia.

Tape speed
2.4 cm/s (1⁵/₁₆ ips), 1.2 cm/s (1⁵/₃₂ ips)

Frequency range
300 – 4,000 Hz

Output
Earphone jack (minijack) for 8 – 300 ohms earphone

Power output (at 10% harmonic distortion)
160 mW

Battery life (recording)
See "Preparing Power Sources".

Power requirements

- Two size AA (R6) batteries: 3 V DC
- Sony AC-E30HG AC power adaptor (not supplied): 240V AC, 50Hz (UK model) 220/230 V AC, 50 Hz (European model) 120/220 V AC, 50/60 Hz (model for other countries) (for M-427/427C/437/529V/539V only)

Dimensions (w/h/d)
Approx. 66.7 x 120.8 x 25 mm (2³/₄ x 4⁷/₈ x 1 in.) incl. projecting parts and controls

Mass
Approx. 160 g (5.7 oz) incl. batteries

Supplied accessories

- Microcassette tape MC-30 (1) (M-427C/437 and M-529V (European model) only)
- Microcassette tapes MC-30 (3) (M-539V only) (excluding Chinese model)
- Handstrap (1) (M-529V/539V/579V only) (excluding Chinese model)
- AC power adaptor (1) (M-579V only)
- Charge adaptor (1) (M-579V only)
- Rechargeable batteries NC-AA, 1.2 V, 700 mAh, Ni-Cd (2) (M-579V only)
- Sony batteries LR6 (SG) (2) (M-539V (Canada and European model) only)

Design and specifications are subject to change without notice.

Optional accessories

Microcassette MC-60, MC-30
Earphone ME-81, ME-L82
Connecting cord RK-G64HG (miniplug to miniplug with attenuator)
AC power adaptor AC-E30HG

Troubleshooting

Should any problem persist after you have made these checks, consult your nearest Sony dealer.

A cassette cannot be inserted.

→ The cassette is being inserted in the wrong way. (The cassette should be inserted in the lid with the tape side facing you.)

→ ◀ has been already pressed.

● cannot be pressed.

→ There is no cassette in the cassette compartment.

→ The cassette tab has been removed.

● or ◀ cannot be pressed.

→ The tape has reached the end.

→ After the automatic shut-off, ◀PAUSE is slid in the direction of the arrow.

The unit does not operate.

→ The batteries have been inserted with incorrect polarity.

→ The batteries are weak. Replace both batteries with new ones.

→ ◀PAUSE is slid in the direction of the arrow.

→ The AC power adaptor or car battery cord is connected to the unit only and you are going to use the unit on batteries.

No sound comes from the speaker.

→ The earphone is plugged in.

→ The volume is turned down completely.

The sound drops out or comes with excessive noise.

→ The volume is turned down completely.

→ The batteries are weak. Replace both batteries with new ones.

→ The head is contaminated. See "Maintenance".

Tape speed is too fast or too slow in the playback mode.

→ Improper setting of the TAPE SPEED switch. Set it to the same speed as that used for recording.

Tape speed is faster than the normal playback speed.

→ The TAPE SPEED switch is set between the 1.2 cm and 2.4 cm positions.

Recording cannot be made.

→ Connection is made incorrectly.

→ The batteries are weak. Replace both batteries with new ones.

→ The head is contaminated.

→ Improper setting of the VOR switch (M-529V/539V/579V only). Set it to H or OFF.

Recording is interrupted.

→ The VOR switch (M-529V/539V/579V only) is set to H or L. When you do not use VOR, set it to OFF.

Recording cannot be erased completely.

→ The head is contaminated.

Precautions**On power**

• Operate the unit only on 3 V DC.

For AC operation, use the AC adaptor recommended for the unit. Do not use any other type. For battery operation, use two size AA (R6) batteries.

On the unit

• Use only the MICROCASSETTE™ (standard microcassettes) with this unit. Non-standard cassettes cannot be used because their "L" dimension (see illustration) is different.

Standard

Only standard microcassettes have a small indentation of side A.

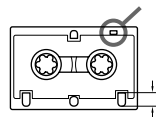

Approx. 5 mm

Non-standard

Non-standard microcassettes do not have the indentation on side A.

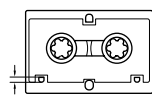

Approx. 2.5 mm

• Do not leave the unit in a location near heat sources, or in a place subject to direct sunlight, excessive dust or mechanical shock.

• Should any solid object or liquid fall into the unit, remove the batteries or disconnect the AC power adaptor, and have the unit checked by qualified personnel before operating it any further.

• Keep personal credit cards using magnetic coding or spring-wound watches etc. away from the unit to prevent possible damage from the magnet used for the speaker.

• When you do not use the unit for long, remove the batteries to avoid damage caused by battery leakage and subsequent corrosion.

• If the unit has not been used for long, set it in the playback mode and warm it up for a few minutes before inserting a cassette.

If you have any questions or problems concerning your unit, please consult your nearest Sony dealer.

Preparing Power Sources

Choose one of the following power sources.

Dry Batteries

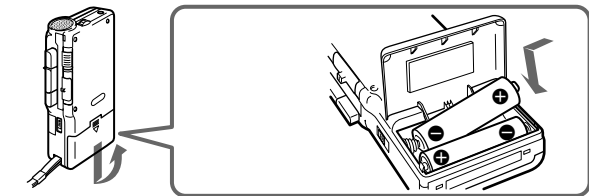

Make sure that nothing is connected to the DC IN 3V jack.

- 1 Open the battery compartment lid.
- 2 Insert two size AA (R6) batteries with correct polarity and close the lid.

If the battery compartment lid is accidentally detached

Attach it as illustrated.

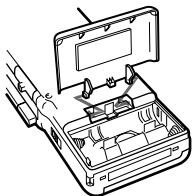

When to replace the batteries

Replace the batteries with new ones when the BATT (battery) lamp dims and the sound is distorted.

Battery life (Approx. hours)

Batteries	Recording
Sony R6P (SR)	5.5
Sony alkaline LR6 (SG)	19
NC-AA (M-579V only)	6.0

House current

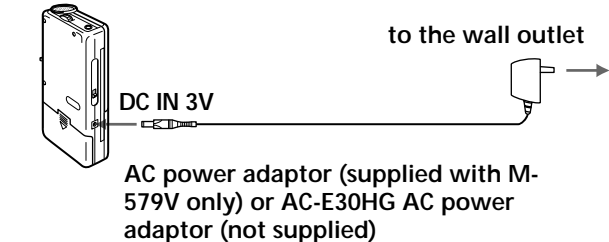

Connect the AC power adaptor to DC IN 3V and to a wall outlet. Use the AC power adaptor (supplied with M-579V only) or the AC-E30HG AC power adaptor (not supplied). Do not use any other AC power adaptor.

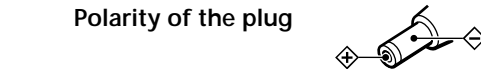

Recording

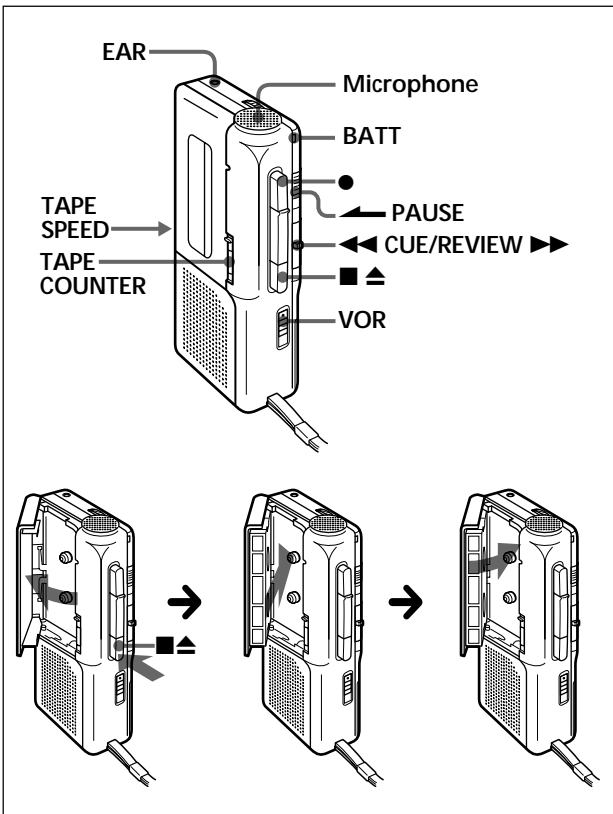

- 1 (M-529V/539V/579V only) Press the reset button of the TAPE COUNTER.
- 2 Press ■▲ and insert a standard microcassette with the side to start recording facing the lid.
- 3 Select the desired tape speed.
2.4 cm for optimum sound (recommended for normal use): A 30-minute recording can be made using both sides of the MC-30 microcassette.
1.2 cm for longer recording time: A 60-minute recording can be made using both sides of the MC-30 microcassette.
- 4 (M-529V/539V/579V only) Set VOR to H, L or OFF. If you set VOR to H or L, the unit automatically starts recording the sound and pauses when there is no sound (you can save tapes and batteries).
H: To record at meeting or in a quiet and/or spacious place.
L: To record for dictation or in a noisy place. When the sound is not loud enough, set it to OFF, or the unit may not start recording.
- 5 Press ●. Recording starts. Recording level is fixed.

To	Press or slide
Stop recording	■▲
Start recording during playback	● during playback (the unit becomes in the recording mode)
Review the portion just recorded	Push up ◀◀CUE/▶▶REVIEW toward ▶▶REVIEW during the recording. Release the button at the point to start playback.
Pause recording	Slide ◀◀PAUSE in the direction of the arrow. The BATT lamp goes off.
Take out a cassette	■▲

Note
Select the 2.4 cm tape speed for recording, if you play back the recorded tape with another unit. Otherwise, the sound quality may be changed.

Notes on VOR (Voice Operated Recording) (M-529V/539V/579V only)

- The VOR system depends on the environmental conditions. If you cannot get the desired results, set VOR to OFF.
- When you use the system in a noisy place, the unit will stay in the recording mode. If the sound is too soft, on the contrary, the unit will not start recording. Set VOR to H (high) or L (low) depending on the conditions.

To monitor the sound
Connect the earphone (not supplied) to EAR jack. The monitor volume cannot be adjusted by VOL.

To prevent a cassette from being accidentally recorded over
Break out and remove the cassette tabs. To reuse the cassette for recording, cover the tab hole with adhesive tape.

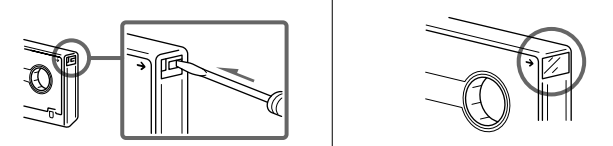

Playing a Tape

- 1 Insert a cassette with the side to start playing facing the lid.
- 2 Select the tape speed to the same speed as that used for recording.
- 3 Press ◀.
- 4 Adjust the volume.

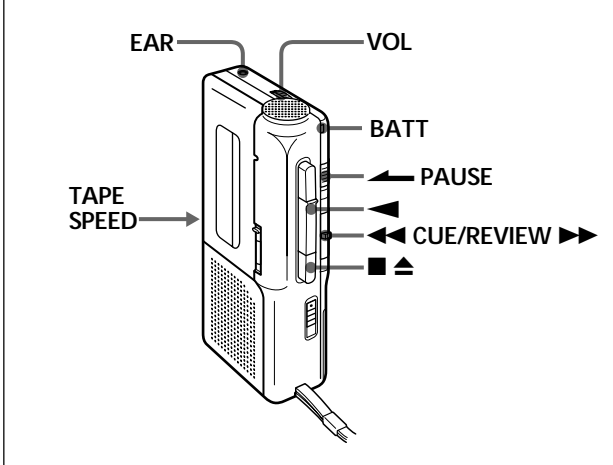

To	Press or slide
Stop playback/stop fast forward or rewind*	■▲
Pause playback	Slide ◀◀PAUSE in the direction of the arrow. The BATT lamp goes off.
Fast forward	Slide ◀◀CUE/▶▶REVIEW toward ◀◀CUE during stop.**
Rewind	Slide ◀◀CUE/▶▶REVIEW toward ▶▶REVIEW during stop.**
Search forward during playback (CUE)	Keep ◀◀CUE/▶▶REVIEW pushed down during playback and release it at the point you want.**
Search backward during playback (REVIEW)	Keep ◀◀CUE/▶▶REVIEW pushed up during playback and release it at the point you want.**

* If you leave the unit after the tape has been wound or rewound, the batteries will be consumed rapidly. Be sure to depress ■▲.
** The tape moves faster in the rewind/REVIEW mode than in the fast forward/CUE mode.

Note
If the tape is completely rewound while searching backward during playback (REVIEW), the ◀◀CUE/▶▶REVIEW switch may not return to the center position when you release the switch. In this case, push back the switch to the center to start playback.

At the end of the tape
In the recording or playback mode, the tape stops at the end of the tape and the locked buttons will be released automatically (Automatic shut-off mechanism). After fast forward or rewind, be sure to return ◀◀CUE/▶▶REVIEW to the center.

Recording/Playback with the Connected Equipment

Dubbing onto another tape recorder

Set this unit to the playback mode and another tape recorder to the recording mode.

