

Mini Hi-Fi Component System

Operating Instructions



***MHC-RG66
MHC-RG55S
MHC-RG55***

WARNING

To prevent fire or shock hazard, do not expose the unit to rain or moisture.

To prevent fire, do not cover the ventilation of the apparatus with news papers, table-cloths, curtains, etc. And don't place lighted candles on the apparatus.

To prevent fire or shock hazard, do not place objects filled with liquids, such as vases, on the apparatus.

Do not install the appliance in a confined space, such as a bookcase or built-in cabinet.

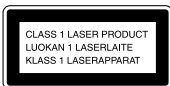

This appliance is classified as a CLASS 1 LASER product. This label is located on the rear exterior.



Don't throw away the battery with general house waste, dispose of it correctly as chemical waste.

Except for European models



ENERGY STAR® is a U.S. registered mark. As an ENERGY STAR® Partner, Sony Corporation has determined that this product meets the ENERGY STAR® guidelines for energy efficiency.

Table of Contents

List of Button Locations and Reference Pages

Main unit	4
Sub woofer	5
Remote Control	6

Getting Started

Hooking up the system	7
Inserting two R6 (size AA) batteries into the remote	10
Setting the clock	11

CD

Loading a CD	11
Playing a CD — Normal Play/ Shuffle Play/Repeat Play	12
Programing CD tracks — Program Play	13

Tuner

Presetting radio stations	14
Listening to the radio — Preset Tuning/ Manual Tuning	16
Using the Radio Data System (RDS)*	17

Tape

Loading a tape	17
Playing a tape	18
Recording to a tape	
— CD Synchro Recording/ Recording Manually/ Program Edit	19
Timer-recording radio programs	20

Sound Adjustment

Selecting the sound system	21
Using the sub woofer	21
Adjusting the sound	22
Selecting the sound effect	22
Adjusting the graphic equalizer and storing	23
Selecting the surround effect	23

Display

Turning off the display	
— Power Saving Mode	24
Using the CD display	24

Other Features

Enhancing video game sound	
— Game Sync	25
Changing the spectrum analyzer display	25
Mixing video game sound with other sound source — Game Mixing	25
Singing along	26
Falling asleep to music	
— Sleep Timer	27
Waking up to music — Daily Timer ...	27

Optional Components

Hooking up optional components	29
Listening to audio from a connected component	30
Recording on a connected component	30

Troubleshooting

Problems and remedies	31
Messages	32

Additional Information

Precautions	33
Specifications	34

* European model only

How to use this page

Use this page to find the location of buttons and other parts of the system that are mentioned in the text.

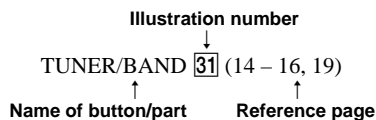

Main unit

ALPHABETICAL ORDER

A – G

AUDIO jacks **26** (29)
 CD **32** (12, 13, 19, 20)
 CD SYNC **17** (19, 20)
 Deck A **23** (17, 18)
 Deck B **16** (17 – 21, 26)
 DIRECTION **6** (18 – 20, 26)
 DISC 1 – 3 **10** (12, 13, 20)
 DISC SKIP/EX-CHANGE **11** (11, 12)
 Disc tray **9** (11)
 DISPLAY **6** (17, 24)
 EDIT **6** (20)
 EFFECT ON/OFF **3** (22)
 ENTER **12** (11, 13 – 15, 20, 23, 27, 28)
 FM MODE **6** (16)
 GAME **28** (25)
 GAME EQ **21** (22)
 GAME MIXING **22** (25)
 GROOVE **2** (22)

M – Z

MD (VIDEO) **29** (30)
 MIC jack*¹ **25** (26)
 MIC LEVEL control*¹ **25** (26)
 MOVIE EQ **7** (22)
 MUSIC EQ **4** (22)
 P FILE **19** (23)
 PHONES jack **14**
 PLAY MODE **6** (12, 13, 20)
 REC PAUSE/START **18** (19, 20, 26)
 REPEAT **6** (12)
 SPECTRUM **6** (25)
 SURROUND SPEAKER MODE*² **8** (21)
 TAPE A/B **30** (17, 19)
 TUNER MEMORY **6** (14, 15)
 TUNER/BAND **31** (14 – 16, 19)
 VIDEO jack **27** (29)
 VOLUME control **13**

BUTTON DESCRIPTIONS

I/O (power) **1**
 ▲/▼/◀/▶ **5**
 ▲ OPEN/CLOSE **11**
 ▲ (deck B) **15**
 ▶▶ **20**
 ◀◀ **20**
 ■ **20**
 ◀▶ **20**
 || **20**
 ▶▶ **20**
 ◀◀ **20**
 ▲ (deck A) **24**

*¹ Except for European models
 *² MHC-RG66 only

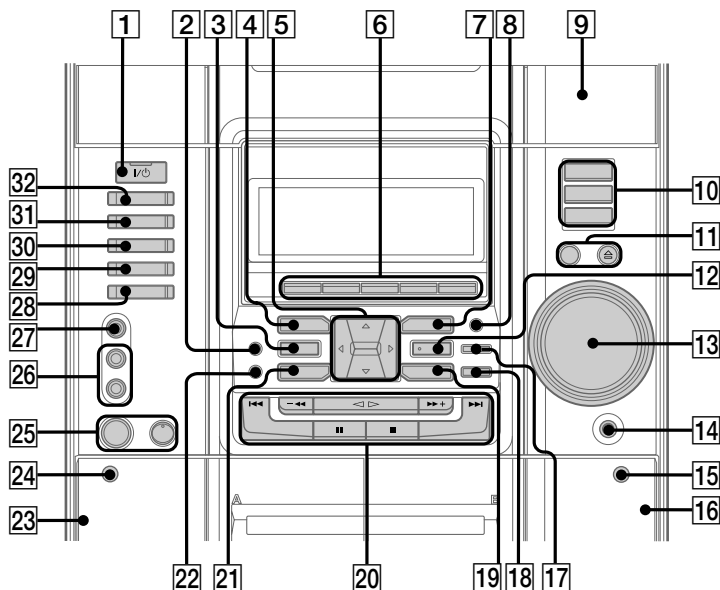

Sub woofer

(MHC-RG55S only)

ALPHABETICAL ORDER

A - Z

Indicator **1** (21)

ON/OFF **2** (21)

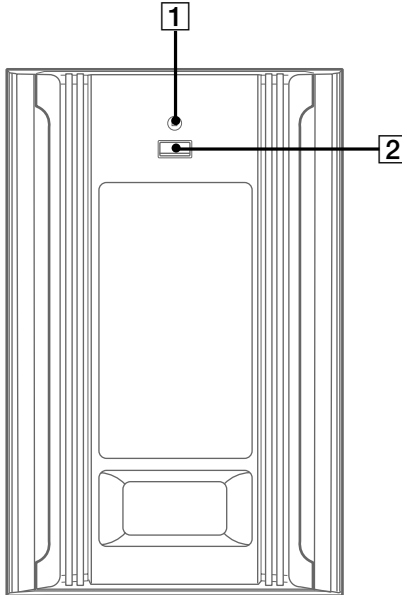

Remote Control

ALPHABETICAL ORDER

A - G

CD **17** (12, 13, 19, 20)
 CLEAR **6** (13)
 CLOCK/TIMER SELECT **2**
 (21, 28)
 CLOCK/TIMER SET **3** (11, 20,
 27)
 D.SKIP **19** (12)
 EFFECT ON/OFF **11** (22)
 ENTER **14** (11, 13 - 15, 20, 23,
 27, 28)
 GAME **18** (25)

M - Z

MD (VIDEO) **9** (30)
 P FILE **13** (23)
 PRESET +/- **5** (14 - 16)
 PRESET EQ **15** (22)
 SLEEP **1** (27)
 SURROUND **10** (23)
 TAPE A/B **8** (17, 19)
 TUNER/BAND **16** (14 - 16, 19)
 TUNING +/- **5** (14 - 16)
 VOL +/- **7**

BUTTON DESCRIPTIONS

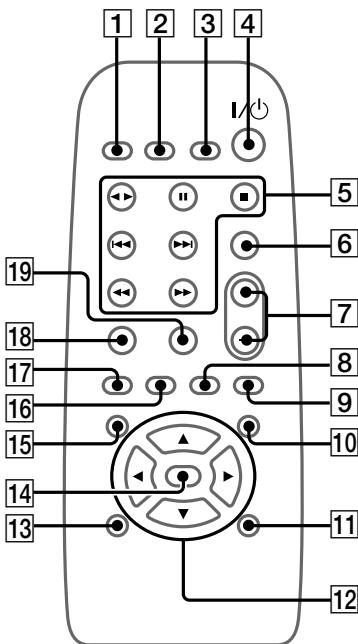
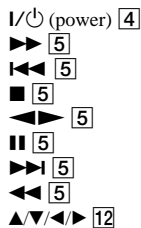

Hooking up the system

Perform the following procedure **1** to **5** to hook up your system using the supplied cords and accessories.

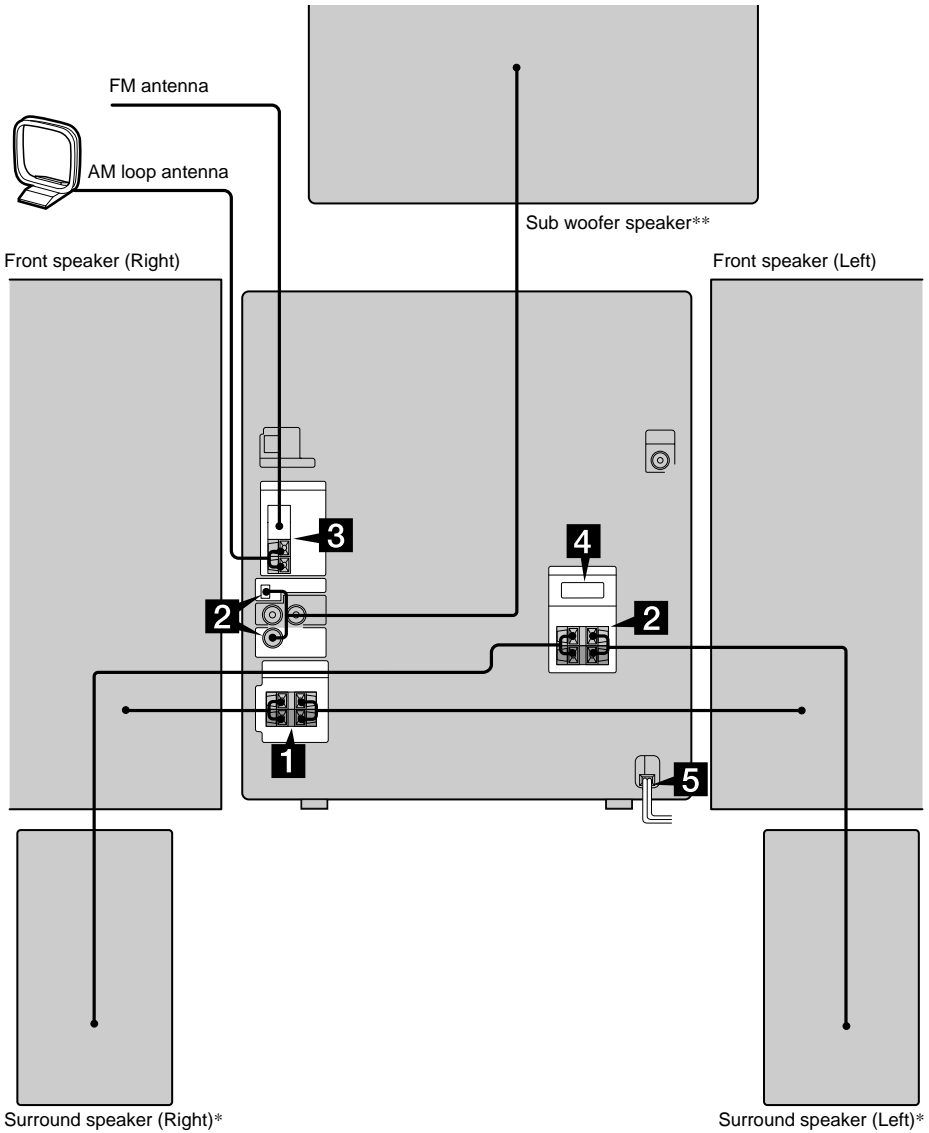

* MHC-RG66 only
** MHC-RG55S only

continued

Hooking up the system (continued)

1 Connect the front speakers.

Connect the speaker cords to the SPEAKER jacks as shown below.

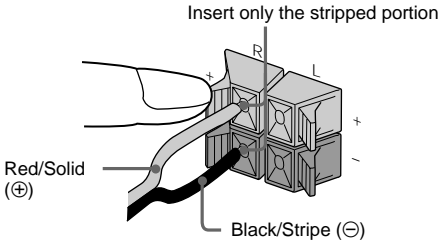

2 For MHC-RG66

Connect the surround speakers.

Connect the speaker cords to the SURROUND SPEAKER jacks as shown below.

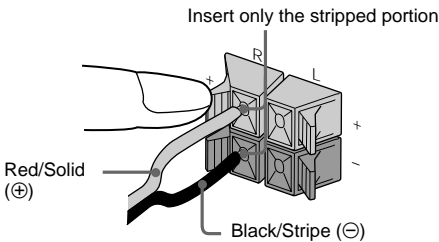

For MHC-RG55S

Connect the sub woofer speaker.

Connect the speaker cords to the SUB WOOFER OUT jack and SUB WOOFER CONTROL jack as shown below.

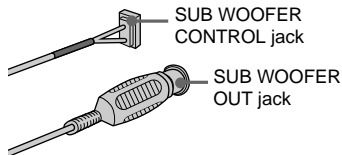

For MHC-RG55

Go to the procedure **3**.

3 Connect the FM/AM antennas.

Set up the AM loop antenna, then connect it.

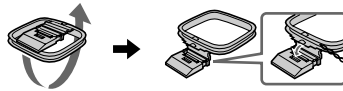

Jack type **A**

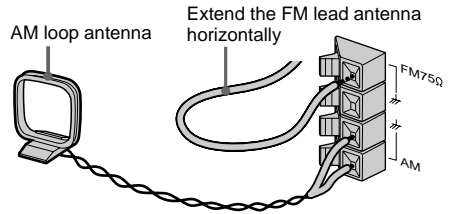

Jack type **B**

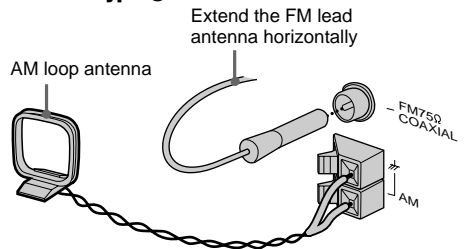

4 For models with a voltage selector, set VOLTAGE SELECTOR to the local power line voltage.

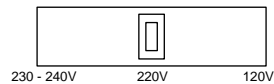

5 Connect the power cord to a wall outlet.

The demonstration appears in the display.

When you press I/Power , the system turns on and the demonstration automatically ends.

If the supplied adapter on the plug does not fit your wall outlet, detach it from the plug (only for models equipped with an adapter).

To connect optional components

See page 29.

To attach the front speaker pads

Attach the supplied front speaker pads to the bottom of the speakers to stabilize the speakers and prevent them from slipping.

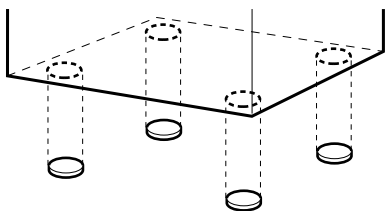
**Notes**

- Keep the speaker cords away from the antennas to prevent noise.
- Do not place the surround speakers on top of a TV. This may cause distortion of the colors in the TV screen.
- Be sure to connect both left and right surround speakers. Otherwise, the sound will not be heard.

Positioning the speakers (MHC-RG66 only)

- 1 Place the front speakers at an angle of 45 degrees from your listening position.**

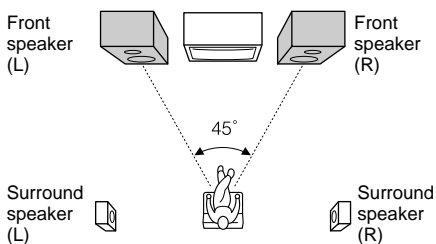

- 2 Place the surround speakers facing each other at about 60 to 90 cm above your listening position.**

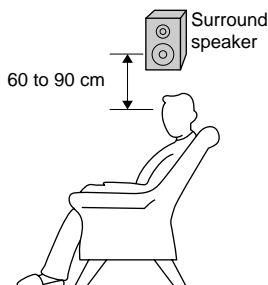

continued

Hooking up the system (continued)

Positioning the sub woofer (MHC-RG55S only)

Since the human ear cannot detect the direction and position where the bass sound being reproduced by a woofer (below 150 Hz) comes from, you can place the woofer wherever you like in your room. To obtain a better bass reproduction, we recommend you to place the woofer on a solid floor where the resonance is unlikely to occur.

Notes

- Always place the woofer vertically, keeping a few centimeters from away the wall.
- If the woofer is placed in the center of a room, the bass could be extremely weakened. This is due to the influence of the standing wave of the room. If this happened, move the woofer away from the center of a room or eliminate the cause of the standing wave, by placing a bookshelf on the wall, etc.

When carrying this system

Perform the following procedure to protect the CD mechanism.

- 1 Make sure that all discs are removed from the system.
- 2 Hold down CD and then press I/⏻ until "STANDBY" appears.
When you release the buttons, "LOCK" appears.
- 3 Unplug the power cord.

Inserting two R6 (size AA) batteries into the remote

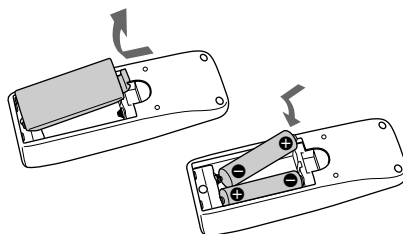

Tip

With normal use, the batteries should last for about six months. When the remote no longer operates the system, replace both batteries with new ones.

Note

If you do not use the remote for a long period of time, remove the batteries to avoid possible damage from battery leakage.

Setting the clock

- 1** Press I/⏻ to turn on the system.
- 2** Press CLOCK/TIMER SET on the remote.
- 3** Press ▲ or ▼ repeatedly to set the hour.
- 4** Press ►.
The minute indication flashes.
- 5** Press ▲ or ▼ repeatedly to set the minute.
- 6** Press ENTER.

The clock starts working.

To adjust the clock

- 1** Press CLOCK/TIMER SET on the remote.
- 2** Press ▲ or ▼ repeatedly to select "CLOCK SET", then press ENTER.
- 3** Do the same procedures as step 3 to 6 above.

Note

The clock settings are canceled when you disconnect the power cord or if a power failure occurs.

Loading a CD

- 1** Press ▲ OPEN/CLOSE.
The disc tray opens.
- 2** Place a CD with the label side up on the disc tray.

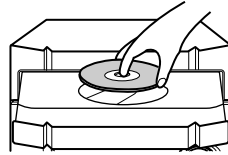

To insert additional discs, press DISC SKIP/EX-CHANGE to rotate the disc tray.

- 3** Press ▲ OPEN/CLOSE to close the disc tray.

Playing a CD

— Normal Play/Shuffle Play/Repeat Play

This system lets you play the CD in different play modes.

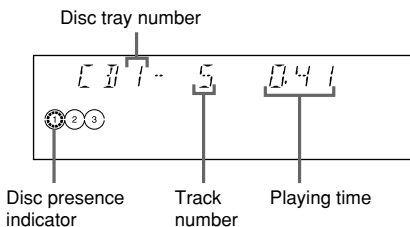

1 Press CD.

2 Press PLAY MODE repeatedly until the mode you want appears.

Select	To play
ALL DISCS (Normal Play)	All CDs in the disc tray continuously.
1DISC (Normal Play)	The tracks on the CD you have selected in original order.
SHUF ALL DISCS (Shuffle Play)	The tracks on all CDs in random order.
SHUF 1DISC (Shuffle Play)	The tracks on the CD you have selected in random order.
PGM (Program Play)	The tracks on all CDs in the order you want them to be played (see "Programing CD tracks" on page 13).

3 Press ◀▶ (or ▶◀ on the remote).

Other Operations

To	Do this
Stop play	Press ■.
Pause	Press II. Press again to resume play.
Select a track	During play or pause, press ▶▶ or ◀◀.
Find a point in a track	During play, press and hold ▶▶ or ◀◀. Release it when you find the desired point.
Select a CD in stop mode	Press DISC 1 – 3 or DISC SKIP/EX-CHANGE (or D.SKIP on the remote).
Switch to CD function from another source	Press DISC 1 – 3 (Automatic Source Selection).
Remove a CD	Press ▲ OPEN/CLOSE.
Exchange other CDs while playing	Press DISC SKIP/EX-CHANGE.
Play repeatedly (Repeat Play)	Press REPEAT during play until "REP" or "REP 1" appears. REP*: For all the tracks on the CD up to five times. REP 1**: For a single track only. To cancel playing repeatedly, press REPEAT until "REP" and "REP 1" disappear.

* You cannot select "REP" and "SHUF ALL DISCS" at the same time.

** When you select "REP 1", that track is repeated endlessly until "REP 1" is canceled.

Note

The play mode cannot be changed while playing a disc. To change the play mode, press ■ first to stop play.

Programing CD tracks

— Program Play

You can make a program of up to 25 tracks from all the CDs in the order you want to play them.

- 1** Press CD.
- 2** Press PLAY MODE repeatedly until “PGM” appears.
- 3** Press one of DISC 1 – 3 to select a CD.
To program all the tracks on a CD at once, proceed to step 5 with “AL” displayed.
- 4** Press ◀▶ or ▶▶ until the desired track appears.

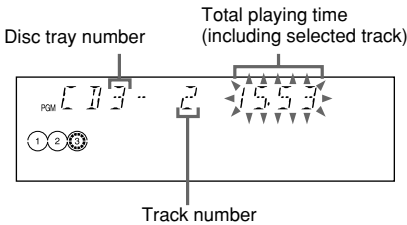

- 5** Press ENTER.
The track is programmed. The program step number appears, followed by the total playing time.

6 Program additional discs or tracks.

To program	Repeat steps
Other discs	3 and 5
Other tracks on the same disc	4 and 5
Other tracks on other discs	3 to 5

7 Press ◀▶ (or ▶▶ on the remote).

Other Operations

To	Do this
Cancel Program Play	Press PLAY MODE repeatedly until “PGM” and “SHUF” disappear.
Clear a track from the end	Press CLEAR on the remote in stop mode.

Tips

- The program you made remains after Program Play finishes. To play the same program again, press CD, then press ◀▶ (or ▶▶ on the remote).
- “- - -” appears when the total CD program time exceeds 100 minutes, or when you select a CD track whose number is 21 or over.

Presetting radio stations

You can preset up to 20 FM stations and 10 AM stations. You can then tune in any of those stations simply by selecting the corresponding preset number.

There are two ways to store the station presets.

To	Method
Automatically tune in all of the stations that can be received in your area and store them manually	Automatic Tuning Preset
Manually tune in and store the radio frequency of your favourite stations	Manual Tuning Preset

Setting presets through automatic tuning

- 1 Press **TUNER/BAND** repeatedly to select “FM” or “AM”.
- 2 Press and hold **◀◀** or **▶▶** (or **TUNING –** or **+** on the remote) until the frequency indication starts to change, then release it.

Scanning stops automatically when the system tunes in a station. “TUNED” and “STEREO” (for an FM stereo program) appear.

If “TUNED” does not appear and the scanning does not stop

Set the frequency of the desired radio station as described in steps 2 through 6 of “Setting presets through manual tuning”.

3 Press **TUNER MEMORY**.

A preset number appears in the display. The stations are stored from preset number 1.

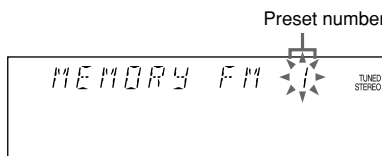

- 4 Press **◀◀** or **▶▶** (or **PRESET –** or **+** on the remote) repeatedly to select the desired preset number.
- 5 Press **ENTER**.
- 6 Repeat steps 1 to 5 to store other stations.

Setting presets through manual tuning

- 1** Press TUNER/BAND repeatedly to select “FM” or “AM”.
- 2** Press ◀◀ or ▶▶ (or TUNING – or + on the remote) repeatedly to tune in the desired station.
- 3** Press TUNER MEMORY.
A preset number appears in the display.
The stations are stored from preset number 1.
- 4** Press ◀◀◀ or ▶▶▶ (or PRESET – or + on the remote) repeatedly to select the desired preset number.
- 5** Press ENTER.
- 6** Repeat steps 1 to 5 to store other stations.

Other Operations

To	Do this
Tune in a station with a weak signal	Follow the procedure described in “Setting presets through manual tuning”.
Set another station to an existing preset number	Start over from step 1. After step 3, press ◀◀◀ or ▶▶▶ (or PRESET – or + on the remote) repeatedly to select the preset number you want to store the other station.

To change the AM tuning interval (except for the European and Middle Eastern models)

The AM tuning interval is factory-set to 9 kHz (10 kHz in some areas). To change the AM tuning interval, tune in any AM station first, then turn off the system. While holding down ENTER, turn the system back on. When you change the interval, all the AM preset stations are erased. To reset the interval, repeat the same procedure.

Note

You cannot change the AM tuning interval in the Power Saving Mode.

Tips

- The preset stations are retained for half a day even if you disconnect the mains lead or if a power failure occurs.
- To improve broadcast reception, reorient or move the supplied antenna near a window or outdoors.

Listening to the radio

You can listen to a radio station either by selecting a preset station, or by manually tuning in the station.

Listening to a preset station

— Preset Tuning

Preset radio stations in the tuner's memory first (see "Presetting radio stations" on page 14).

1 Press TUNER/BAND repeatedly to select "FM" or "AM".

2 Press ◀◀ or ▶▶ (or PRESET – or + on the remote) repeatedly to select the desired preset station.

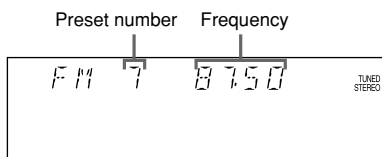

Listening to non-preset radio station

— Manual Tuning

1 Press TUNER/BAND repeatedly to select "FM" or "AM".

2 Press ◀◀ or ▶▶ (or TUNING – or + on the remote) repeatedly to tune in the desired station.

Tips

- To improve broadcast reception, adjust the supplied antennas.
- When an FM stereo program has static noise, press FM MODE repeatedly until "MONO" appears. There will be no stereo effect, but the reception will improve.
- Press and hold ◀◀ or ▶▶ (or TUNING – or + on the remote). The frequency indication changes and scanning stops when the system tunes in a station (Automatic Tuning).
- To record from the radio, see "Recording to a tape" on page 19 or "Timer-recording radio programs" on page 20.

Using the Radio Data System (RDS)

(European model only)

What is the Radio Data System?

Radio Data System (RDS) is a broadcasting service that allows radio stations to send additional information along with the regular program signal. This tuner offers convenient RDS features like station name display and location of stations by program type. RDS is available only on FM stations.*

Note

RDS may not work properly if the station you tuned in is not transmitting the RDS signal properly or if the signal is weak.

* Not all FM stations provide RDS service, nor do they provide the same types of services. If you are not familiar with the RDS system, check with your local radio stations for details on RDS services in your area.

Receiving RDS broadcasts

Simply select a station from the FM band. When you tune in a station that provides RDS services, the station name appears in the display.

To check the RDS information

Each time you press DISPLAY, the display changes cyclically as follows:

Station name* → Frequency → Program type (for one second)* → Clock display (for eight seconds) → Effect status

* If the RDS broadcast is not received, the station name and program type may not appear in the display.

Loading a tape

- 1** Press TAPE A/B repeatedly to select deck A or B.
- 2** Press ▲.
- 3** Insert a tape in deck A or B with the side you want to play/record facing forward.

With the side you want to play/record facing forward.

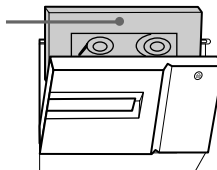

Playing a tape

You can use TYPE I (normal) tape.

- 1 Load a tape.**
- 2 Press DIRECTION repeatedly to select \rightleftarrows to play one side. Select \rightleftarrows * to play both sides.**
To play both decks in succession, select RELAY (Relay Play)**.
- 3 Press $\triangleleft \triangleright$ (or $\blacktriangleleft \blacktriangleright$ on the remote).**
Press the button again to play the reverse side*. The tape starts playing.

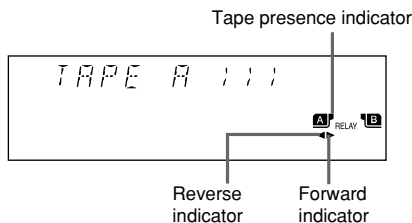

* For MHC-RG55S, deck A doesn't play the reverse side.

** Relay Play always follows this cyclic sequence up to five times, then stops:

- Deck A (front side) → Deck A (reverse side)
- Deck B (front side) → Deck B (reverse side)

For MHC-RG55S, after the playback of the front side of deck A, deck B repeats the sequence five times.

Other Operations

To	Do this
Stop play	Press \blacksquare .
Pause	Press II . Press again to resume play.
Fast-forward or rewind	Press \blacktriangleleft or \blacktriangleright .
Remove the cassette	Press \blacktriangle .

Searching for the beginning of the current or the next track (AMS)*

To go forward

Press \blacktriangleright during playback when \triangleright lights. "TAPE A (or TAPE B) >>> +1" appears.

Press \blacktriangleleft during playback when \triangleleft lights. "TAPE A** (or TAPE B) <<< +1" appears.

To go back

Press \blacktriangleleft during playback when \triangleright lights. "TAPE A (or TAPE B) <<< -1" appears.

Press \blacktriangleright during playback when \triangleleft lights. "TAPE A** (or TAPE B) >>> -1" appears.

* AMS (Automatic Music Sensor)

** For MHC-RG55S, deck A doesn't play the reverse side.

Tip

When a tape is inserted, corresponding forward/reverse indicators light.

Note

The AMS function may not operate correctly under the following circumstances:

- When the unrecorded space between songs is less than 4 seconds long.
- When the system is placed near a television.

Recording to a tape

— CD Synchro Recording/Recording Manually/Program Edit

You can record from a CD, tape (or connected components) or radio. You can use TYPE I (normal) tapes. The recording level is adjusted automatically.

Steps	Recording from a CD (CD Synchro Recording)	Recording from a CD/tape/radio manually
1	Load a recordable tape into deck B.	
2	Press CD.	Press CD, TAPE A/B or TUNER/BAND.
3	Load the CD you want to record.	Load the CD or tape (or other audio source), or tune in the station you want to record.
4	Press CD SYNC.	Press REC PAUSE/START.
	Deck B stands by for recording. “REC” flashes.	
5	Press DIRECTION repeatedly to select \rightleftarrows to record on one side. Select \leftrightarrow (or RELAY) to record on both sides.	
6	Press REC PAUSE/START. Recording starts.	Press REC PAUSE/START, and then start playing the desired source to record.

To stop recording

Press **■**.

Note

You cannot listen to other sources while recording.

Tips

- If you want to record from the reverse side, press TAPE A/B to select deck B after step 1. Press $\triangleleft \triangleright$ to start playback of the reverse side, then press **■** when you want to start recording. The TAPE B reverse side indicator lights up.
- When you record on both sides, be sure to start from the front side. If you start from the reverse side, recording stops at the end of the reverse side.
- For recording from the radio:
If noise is heard while recording from the radio, move the respective antenna to reduce the noise.

continued

Recording to a tape (continued)

Recording a CD by specifying track order

— Program Edit

When programing, make sure the playing time for each side do not exceed the length of one side of the tape.

- 1** Load a CD and load a recordable tape into deck B.
- 2** Press CD.
- 3** Press PLAY MODE repeatedly until "PGM" appears.
- 4** Press one of DISC 1 – 3 to select a CD.
- 5** Press ◀◀ or ▶▶ until the desired track appears.
- 6** Press ENTER.
The track is programed. The program step number appears, followed by the total playing time.
- 7** Repeat steps 5 and 6 for the same disc or 4 to 6 for tracks from another disc to program additional discs or tracks.
- 8** Press CD SYNC.
Deck B stands by to record in the direction of the indication on ◀▶ (the right indicator lights to record on the forward side and the left indicator lights to record on the reverse side). The CD player stands by for playback.
- 9** Press DIRECTION repeatedly to select ⇌ to record on one side. Select ⇔ (or RELAY) to record on both sides.
- 10** Press REC PAUSE/START.
Recording starts.

Tip

To check the required tape length for recording a CD, press EDIT until "EDIT" flashes after you have loaded CD and pressed CD. The required tape length for the currently selected CD appears, followed by the total playing time for side A and side B respectively (**Tape Select Edit**).

Note

You cannot use Tape Select Edit for discs containing over 20 tracks.

Timer-recording radio programs

You can record a preset radio station from a specified time.

To timer-record, you must first preset the radio station (see "Presetting radio stations" on page 14) and set the clock (see "Setting the clock" on page 11).

- 1** Tune in the preset radio station (see "Listening to the radio" on page 16).
- 2** Press CLOCK/TIMER SET on the remote.
"DAILY 1 SET" appears.
- 3** Press ▲ or ▼ repeatedly to select "REC SET", then press ENTER.
"ON" appears and the hour indication flashes.
- 4** Set the time to start recording.
Press ▲ or ▼ repeatedly to set the hour, then press ▶.
The minute indication starts flashing.
Press ▲ or ▼ repeatedly to set the minute, then press ENTER.

Selecting the sound system

(MHC-RG66 only)

You can enjoy different sounds by selecting the sound mode you want.

Press SURROUND SPEAKER MODE to select the sound you want.

LINK: Reproduces the same sound with the different output level.

MATRIX SURR: Reproduces a wide range of sound that actually can sense the size of the room.

Using the sub woofer

(MHC-RG55S only)

You can use the sound of the sub woofer to suit the sound source.

Press ON/OFF on the sub woofer.

The indicator lights up while the sub woofer turns on.

Press the button again to turn off the sub woofer.

Tip

You can use VOLUME (VOL – or + on the remote) to adjust the volume of the sub woofer linked to the front speakers.

5 Repeat step 4 to set the time to stop recording.

The start time appears, followed by the stop time, the preset radio station to be recorded (e.g., “TUNER FM 5”), then the original display appears.

6 Load a recordable tape into deck B.

7 Press I/⏻ to turn off the system.

When the recording starts, the volume level is set to the minimum.

Other Operations

To	Do this
Check the setting	Press CLOCK/TIMER SELECT on the remote and press ▲ or ▼ repeatedly to select “REC SELECT”. Then, press ENTER. To change the setting, start over from step 1.
Cancel the timer	Press CLOCK/TIMER SELECT on the remote and press ▲ or ▼ repeatedly to select “TIMER OFF”, then press ENTER.

Notes

- If the system is on at the preset time, the recording will not be made.
- When you used the Sleep Timer, Daily Timer and Timer recording will not turn on the system until the Sleep Timer turns it off.
- You cannot activate Daily Timer and Timer-recording at the same time.

Adjusting the sound

You can reinforce the bass and create a more powerful sound.

The GROOVE setting is ideal for music sources, and the V-GROOVE setting is ideal for video sources (movies, VCDs).

Press GROOVE.

Each time you press the button, the display changes cyclically as follows:

GROOVE ON* → V-GROOVE ON*
→ GROOVE OFF

* The volume switches to power mode, the equalizer curve changes, and the “GROOVE” indicator lights up.

Selecting the sound effect

Selecting the effect from the music menu

Press **MUSIC EQ***, **MOVIE EQ*** or **GAME EQ*** (or **PRESET EQ**** on the remote) repeatedly to select the preset you want.

The preset name appears.

See the chart “Sound effect options”.

* You can select from a variety of effects for each equalizer.

** You can select all of the effects in order.

To cancel the effect

Press **EFFECT ON/OFF** repeatedly until “EFFECT OFF” appears.

Sound effect options

“SURR” appears if you select an effect with surround effects.

MUSIC EQ

Effect

ROCK	Standard music sources
POP	
JAZZ	
DANCE	
SOUL	
ORIENTAL	

MOVIE EQ

Effect

ACTION	Soundtracks and special listening situations
DRAMA	
MUSICAL	

GAME EQ

Effect

ADVENTURE	PlayStation 1, 2 and other video game music sources
ARCADE	
RACING	

Adjusting the graphic equalizer and storing

You can adjust the sound by raising or lowering the levels of specific frequency ranges, then store up to three personal files (P FILE) in the memory.

Before operation, first select the audio emphasis you want for your basic sound.

- 1 Press ◀ or ▶ repeatedly to select a frequency band, then press ▲ or ▼ to adjust the level.**

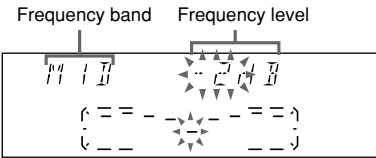

- 2 Press and hold P FILE on the unit.**

A personal file number appears.

- 3 Press P FILE repeatedly to select P FILE 1 – 3 you want to store the equalizer setting.**

- 4 Press ENTER.**

“COMPLETE” appears.

This setting is automatically stored as the personal file you selected in step 3.

Other Operations

To	Press
Call up a personal file	P FILE repeatedly to select the desired personal file number.
Cancel a personal file	EFFECT ON/OFF repeatedly until “EFFECT OFF” appears.

Selecting the surround effect

Press SURROUND on the remote.

“SURR” appears.

Press the button again to cancel SURROUND.

Note

When you select other sound effect, the surround effect will be canceled.

Turning off the display

— Power Saving Mode

The demonstration display (display window and buttons lighting and flashing even when the system power is off) and the clock display can be turned off to minimize the amount of power consumed during standby (Power Saving Mode).

Press DISPLAY repeatedly while the system is off until the demonstration display or the clock display disappears.

To cancel the Power Saving Mode

Press DISPLAY while the system is off. Each time you press the button, the display switches cyclically as follows:

Demonstration display → Clock display* → No display (Power Saving Mode)

* The clock is displayed only if you set the clock.

Tip

The timer continues to operate in Power Saving Mode.

Using the CD display

Checking the remaining time

Press DISPLAY repeatedly during play.

Each time you press the button, the display changes cyclically as follows:

Elapsed playing time on the current track → Remaining time on the current track → Remaining time on the current CD (1DISC mode) or “--.--” display (ALL DISCS mode) → Clock display (for eight seconds) → Effect status

Checking the total playing time

Press DISPLAY repeatedly in stop mode.

Each time you press the button, the display changes cyclically as follows:

Total number of tracks and total playing time → Clock display (for eight seconds) → Effect status

Enhancing video game sound

— Game Sync

You need to connect a video game machine (see “Hooking up optional components” on page 29).

Press GAME.

Tips

- In the standby mode, the system automatically turns on.
- The GAME EQ (previously selected effect) is automatically selected.
- These operations cannot be performed in the Power Saving Mode.

Changing the spectrum analyzer display

Press SPECTRUM.

Each time you press the button, the display changes as follows:

PATTERN 1 → PATTERN 2* →
PATTERN 3 → PATTERN OFF (No display)

* “PATTERN 2” may not be displayed according to the audio signal.

Mixing video game sound with other sound source

— Game Mixing

1 Select the desired source sound.

2 Press GAME MIXING.

Each time you press the button, the level of the game sound changes cyclically as follows:

MIXING LOW → MIXING MID →
MIXING HIGH → MIXING OFF

Tips

- The GAME MIXING indicator lights up while Game Mixing is activated.
- Once Game Mixing is activated, it will remain active while the power is on even if the source sound is changed.

Note

If you start recording while Game Mixing is activated, Game Mixing is canceled. To record the mixed sound, press GAME MIXING after step 5 of “Recording from a CD/tape/radio manually” on page 19 and then press REC PAUSE/START to start the recording.

Singing along

(Except for European models)

You can sing along by turning down the singer's voice. You need to connect an optional microphone.

- 1 Turn MIC LEVEL to MIN to turn down the microphone control level.**
- 2 Connect an optional microphone to MIC.**
- 3 Start playing the music.**
- 4 Adjust the microphone volume by turning MIC LEVEL.**

After you have finished

Turn MIC LEVEL to MIN and disconnect the microphone from MIC.

Notes

- The instrumental sound may be reduced as well as the singer's voice when the sound is recorded in monaural.
- The singer's voice may not be reduced when:
 - only a few instruments are playing.
 - a duet is being played.
 - the source has strong echoes or chorus.
 - the singer's voice deviates from the center.
 - the voice on the source is singing in high soprano or tenor.

Mixing and recording sounds

You can "mix" sounds by playing one of the components and singing or speaking into a microphone (not supplied).

The mixed sound can be recorded on a tape.

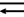
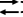
- 1 Prepare the source you want to mix. Then, load a recordable tape in deck B.**
- 2 Press the function button of the source you want to record (e.g., CD).**
When you want to record from TAPE A, press TAPE A/B repeatedly until TAPE A is selected.
- 3 Press REC PAUSE/START.**
Deck B stands by for recording. "REC" flashes.
- 4 Press DIRECTION repeatedly to select  to record on one side. Select  (or RELAY) to record on both sides.**
- 5 Press REC PAUSE/START, and then start singing, speaking or playing the desired source.**
Recording starts.

To stop recording

Press .

Tips

- If acoustic feedback (howling) occurs, move the microphone away from the speakers or change the direction of the microphone.
- If you want to record your voice through the microphone only, you can do so by selecting the CD function and not playing a CD.
- When high level sound signals are input, the system automatically adjusts the recording level to prevent distortion of the recorded sound signal (Auto Level Control function).

Falling asleep to music

— Sleep Timer

You can set the system to turn off after a certain time, so that you can fall asleep to music.

Press SLEEP on the remote.

Each time you press the button, the minute display (the turn-off time) changes cyclically as follows:

AUTO* → 90 MIN → 80 MIN → 70 MIN
→ ... → 10 MIN → OFF

* The system turns off when the current CD or tape finishes playback (for up to 100 minutes).

Other Operations

To	Press
Check the remaining time**	SLEEP on the remote once.
Change the time to turn off	SLEEP on the remote repeatedly to select the time you want.
Cancel the Sleep Timer function	SLEEP on the remote repeatedly until "SLEEP OFF" appears.

** You cannot check the remaining time when you select "AUTO".

Waking up to music

— Daily Timer

You can wake up to music at a preset time. Make sure you have set the clock (see "Setting the clock" on page 11).

1 Prepare the music source you want to play.

- CD: Load a CD. To start from a specific track, make a program (see "Programing CD tracks" on page 13).
- Tape: Load a tape with the side you want to play facing forward.
- Radio: Tune in the preset station you want (see "Listening to the radio" on page 16).

2 Adjust the volume.

3 Press CLOCK/TIMER SET on the remote.

"DAILY 1 SET" appears.

4 Press ▲ or ▼ repeatedly to select "DAILY 1 (or 2) SET", then press ENTER.

"ON" appears and the hour indication flashes.

continued

Waking up to music (continued)

5 Set the time to start playing.

Press ▲ or ▼ repeatedly to set the hour, then press ►.

The minute indication flashes.

Press ▲ or ▼ repeatedly to set the minute, then press ENTER.

6 Repeat step 5 to set the time to stop playback.

7 Press ▲ or ▼ repeatedly until the music source you want appears.

The indication changes as follows:

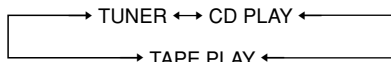

8 Press ENTER.

The type of timer (DAILY 1 or DAILY 2), followed by the start time, stop time, and the music source appear, then the original display appears.

9 Press I/⏻ to turn off the system.

Other Operations

To	Do this
Check the setting	Press CLOCK/TIMER SELECT on the remote and press ▲ or ▼ repeatedly to select the respective mode (DAILY 1 or DAILY 2), then press ENTER.
Change the setting	Start over from step 1.
Cancel the timer	Press CLOCK/TIMER SELECT on the remote and press ▲ or ▼ repeatedly to select "TIMER OFF", then press ENTER.

Tip

The system turns on 15 seconds before the preset time.

Notes

- You cannot activate DAILY 1 and DAILY 2 Timer at the same time.
- When you use the Sleep Timer, the Daily Timer will not turn on the system until the Sleep Timer turns it off.
- You cannot activate Daily Timer and Timer-recording at the same time.
- If the system is on at the preset time, you cannot activate the Daily Timer.

Hooking up optional components

To enhance your system, you can connect optional components. Refer to the operating instructions provided with each component.

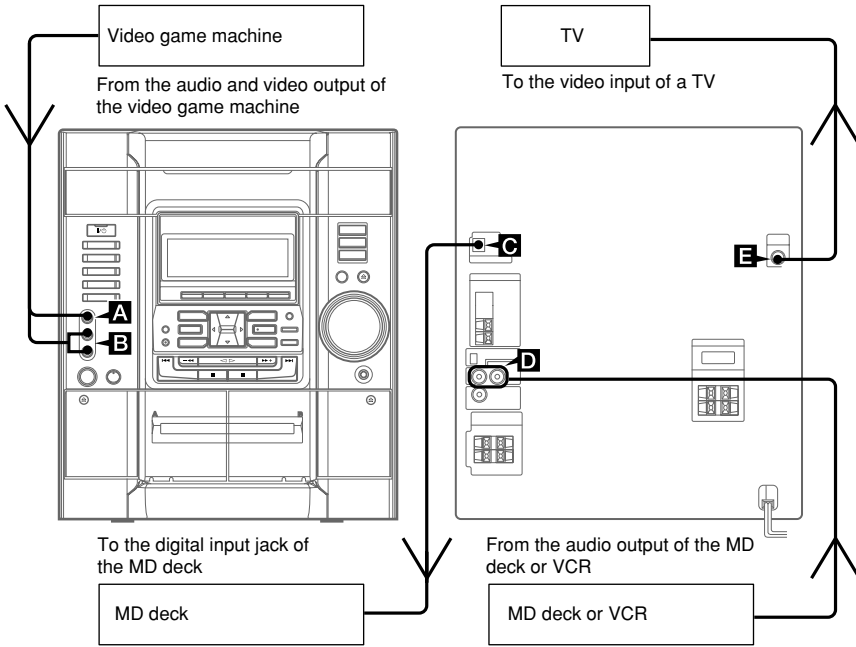

A VIDEO INPUT jack

Use a video cable (not supplied) to connect the video output of the optional video game machine to this jack.

B AUDIO INPUT jacks

Use audio cords (not supplied) to connect the audio output of the optional video game machine to these jacks. You can then output audio through this system.

Note

To enjoy video game sound, see “Enhancing video game sound” on page 25, or see “Selecting the sound effect” on page 22 for video game sound effects.

C CD DIGITAL OUT jack

Use a digital optical cable (square, not supplied) to connect the audio input of the optional MD deck to this jack. You can then record digital audio from this system.

D MD (VIDEO) IN jacks

Use audio cords (not supplied) to connect the audio output of the optional component (such as MD deck or VCR) to these jacks. You can then output audio through this system.

E VIDEO OUT jack

Use a video cable (not supplied) to connect the video input of TV to this jack.

Note

The video game machine image may appear on the TV screen even if the system is turned off.

Listening to audio from a connected component

Listening to a connected MD deck

1 Connect the audio cords.

See “Hooking up optional components” on page 29.

2 Press MD (VIDEO).

Start playing the connected component.

Listening to a connected VCR

1 Connect the audio cords.

See “Hooking up optional components” on page 29.

2 Press MD (VIDEO).

Hold down MD (VIDEO) and press I/⏪.

This switches the “MD” function to “VIDEO”. Once you enable the “VIDEO” function, just press MD (VIDEO).

Notes

- If you cannot select “MD” when you press MD (VIDEO), press I/⏪ while holding down MD (VIDEO) when the system is on. “VIDEO” will be switched to “MD”. To return to “VIDEO”, do the same procedure.
- When you connect a VIDEO CD deck, set to “MD”.

Recording on a connected component

Making a digital recording from CD to a connected MD deck

1 Connect the optional optical cable.

See “Hooking up optional components” on page 29.

2 Start recording.

Refer to the operating instructions provided with connected component.

Problems and remedies

If you have any problem using this system, use the following check list.

First, check that the power cord is connected firmly and the speakers are connected correctly and firmly.

Should any problem persist, consult your nearest Sony dealer.

General

The display starts flashing as soon as you plug in the power cord even though you haven't turned on the system (see step 5 of "Hooking up the system" on page 9).

- Press DISPLAY twice when the system is turned off. The demonstration disappears.

"- -:--" appears in the display.

- A power interruption occurred. Set the clock and timer settings again.

The clock setting/radio presetting/timer is canceled.

- The power cord is disconnected or a power failure occurs longer than half a day. Redo the following:
 - "Setting the clock" on page 11
 - "Presetting radio stations" on page 14

If you have set the timer, also redo "Waking up to music" on page 27 and "Timer-recording radio programs" on page 20.

There is no sound.

- Turn VOLUME clockwise.
- The headphones are connected.
- Insert only the stripped portion of the speaker cord into the SPEAKER jack. Inserting the vinyl portion of the speaker cord will obstruct the speaker connections.
- There is no audio output during timer recording.

There is severe hum or noise.

- A TV or VCR is placed too close to the stereo system. Move the stereo system away from the TV or VCR.

The sound from the connected source is distorted.

- If "VIDEO" appears in the display when you press MD (VIDEO), switch the display to "MD" (see "Listening to audio from a connected component" on page 30).

The timer does not function.

- Set the clock correctly.

DAILY 1, DAILY 2, and REC do not appear when you press CLOCK/TIMER SET.

- Set the timer correctly.
- Set the clock.

The remote does not function.

- There is an obstacle between the remote and the system.
- The remote is not pointing in the direction of the system's sensor.
- The batteries have run down. Replace the batteries.

There is acoustic feedback.

- Decrease the volume level.
- Move the microphone away from the speakers or change the direction of the microphone.

The color irregularity on a TV screen persists.

- Turn off the TV set once, then turn it on after 15 to 30 minutes. If the color irregularity still persists, place the speakers farther away from the TV set.

Speakers

Sound comes from one channel or unbalanced left and right volume.

- Check the speaker connection and speaker placement.

Sound lacks bass.

- Check that the speaker's + and - jacks are connected correctly.

continued

Problems and remedies (continued)

CD Player

The disc tray does not close.

- The CD is not placed properly.
-

The CD will not play.

- The CD is not lying flat in the disc tray.
 - The CD is dirty.
 - The CD is inserted label side down.
 - There is moisture on the CD.
-

Play does not start from the first track.

- The player is in program or shuffle mode. Press PLAY MODE repeatedly until “PGM” or “SHUF” disappears.
-

The disc tray does not open and “LOCKED” appears.

- Contact your Sony dealer or local authorized Sony service facility.
-

Tape Deck

The tape does not record.

- No tape in the cassette holder.
 - The tab has been removed from the cassette (see “To save a tape permanently” on page 33).
 - The tape has reeled to the end.
-

The tape does not record nor play or there is a decrease in sound level.

- The heads are dirty (see “Cleaning the tape heads” on page 34).
 - The record/playback heads are magnetized (see “Demagnetizing the tape heads” on page 34).
-

The tape does not erase completely.

- The record/playback heads are magnetized (see “Demagnetizing the tape heads” on page 34).
-

There is excessive wow or flutter, or the sound drops out.

- The capstans or pinch rollers are dirty (see “Cleaning the tape heads” on page 34).
-

Noise increases or the high frequencies are erased.

- The record/playback heads are magnetized (see “Demagnetizing the tape heads” on page 34).
-

Tuner

There is severe hum or noise (“TUNED” or “STEREO” flashes in the display).

- Adjust the antenna.
 - The signal strength is too weak. Connect the external antenna.
-

A stereo FM program cannot be received in stereo.

- Press FM MODE so that “STEREO” appears.
-

If other troubles not described above occur, reset the system as follows:

- 1 Unplug the power cord.
- 2 Plug the power cord back in.
- 3 Press ■, ENTER, and I/⏻ at the same time.
- 4 Press I/⏻ to turn on the system.

The system is reset to the factory settings. All the settings you made are cleared.

Messages

One of the following messages may appear or flash in the display during operation.

NO DISC

- There is no CD on the disc tray.
-

OVER

- You have reached the end of the CD.
-

“PROTECT” and “PUSH POWER” appear alternately.

- A strong signal was input. Press I/⏻ to turn off the system, leave the system turned off for a while, then press I/⏻ again to turn on the system. If “PROTECT” and “PUSH POWER” appear alternately even after the system is turned on again, press I/⏻ to turn off the system and check the speaker cord.
-

Precautions

On operating voltage

Before operating the system, check that the operating voltage of your system is identical with the voltage of your local power supply.

On safety

- The unit is not disconnected from the AC power source (mains) as long as it is connected to the wall outlet, even if the unit itself has been turned off.
- Unplug the system from the wall outlet (mains) if it is not to be used for an extended period of time. To disconnect the cord (mains lead), pull it out by the plug. Never pull the cord itself.
- Should any solid object or liquid fall into the component, unplug the system and have it checked by qualified personnel before operating it any further.
- The AC power cord must be changed only at the qualified service shop.

On placement

- Do not place the system in an inclined position.
- Do not place the system in locations where it is:
 - Extremely hot or cold
 - Dusty or dirty
 - Very humid
 - Subject to vibrations
 - Subject to direct sunlight.
- Use caution when placing the unit or speakers on surfaces that have been specially treated (with wax, oil, polish, etc.) as staining or discoloration of the surface may result.

On heat build up

- Although the system heats up during operation, this is not a malfunction.
- Place the system in a location with adequate ventilation to prevent heat build up in the system.
- If you continuously use this system at a large volume, the cabinet temperature of the top, side and bottom rises considerably. To avoid burning yourself, do not touch the cabinet.
- To prevent a malfunction, do not cover the ventilation hole for the cooling fan.

On operation

- If the system is brought directly from a cold to a warm location, or is placed in a very damp room, moisture may condense on the lens inside the CD player. Should this occur, the system will not operate properly. Remove the CD and leave the system turned on for about an hour until the moisture evaporates.
- When you move the system, take out any discs.

If you have any questions or problems concerning your stereo system, please consult your nearest Sony dealer.

Notes on CDs

- Before playing, clean the CD with a cleaning cloth. Wipe the CD from the center out.
- Do not use solvents.
- Do not expose the CD to direct sunlight or heat sources.
- Discs with non-standard shapes (e.g., heart, square, star) cannot be played on this system. Attempting to do so may damage the system. Do not use such discs.

Note on CD-R/CD-RW playback

Discs recorded on CD-R/CD-RW drives may not be played back because of scratches, dirt, recording condition or the drive's characteristics. Besides, the discs, which are not yet finalized at the end of recording, cannot be played back.

Cleaning the cabinet

Use a soft cloth slightly moistened with mild detergent solution.

To save a tape permanently

To prevent a tape from being accidentally recorded over, break off the cassette tab from side A or B as illustrated. If you later want to reuse the tape for recording, cover the broken tab with adhesive tape.

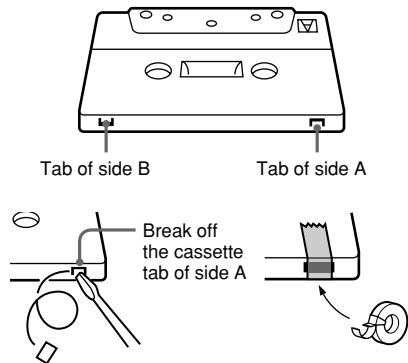

continued

Precautions (continued)

Before placing a cassette in the tape deck

Take up any slack in the tape. Otherwise the tape may get entangled in the parts of the tape deck and become damaged.

When using a tape longer than 90 minutes

The tape is very elastic. Do not change the tape operations such as play, stop, and fast-winding frequently. The tape may get entangled in the tape deck.

Cleaning the tape heads

Clean the tape heads after every 10 hours of use.

Be sure to clean the tape heads before you start an important recording or after playing an old tape. Use a separately sold dry-type or wet-type cleaning cassette. For details, refer to the instructions of the cleaning cassette.

Demagnetizing the tape heads

Demagnetize the tape heads and the metal parts that have contact with the tape every 20 to 30 hours of use with a separately sold demagnetizing cassette. For details, refer to the instructions of the demagnetizing cassette.

Specifications

Amplifier section

European model:

MHC-RG66

DIN power output (rated) 115 + 115 watts (6 ohms at 1 kHz, DIN)

Continuous RMS power output (reference)
140 + 140 watts (6 ohms at 1 kHz, 10% THD)

Music power output (reference)
280 + 280 watts (6 ohms at 1 kHz, 10% THD)

MHC-RG55S

Front speaker

DIN power output (rated) 50 + 50 watts (6 ohms at 1 kHz, DIN)

Continuous RMS power output (reference)
60 + 60 watts (6 ohms at 1 kHz, 10% THD)

Music power output (reference)
120 + 120 watts (6 ohms at 1 kHz, 10% THD)

Sub woofer

DIN power output (rated) 100 watts (12 ohms at 40 Hz, DIN)

Continuous RMS power output (reference)
120 watts (12 ohms at 40 Hz, 10% THD)

Music power output (reference)
120 watts (12 ohms at 40 Hz, 10% THD)

Other models:

MHC-RG66

The following measured at AC 120, 220, 230 – 240 V, 50/60 Hz

DIN power output (rated) 115 + 115 watts (6 ohms at 1 kHz, DIN)

Continuous RMS power output (reference)
140 + 140 watts (6 ohms at 1 kHz, 10% THD)

MHC-RG55

The following measured at AC 120, 220, 230 – 240 V, 50/60 Hz

DIN power output (rated) 100 + 100 watts (6 ohms at 1 kHz, DIN)

Continuous RMS power output (reference)
120 + 120 watts (6 ohms at 1 kHz, 10% THD)

Inputs	
MD/VIDEO (AUDIO) IN (phono jacks):	voltage 450/250 mV, impedance 47 kilohms
GAME (AUDIO) IN (phono jack):	voltage 250 mV, impedance 47 kilohms
MIC (phone jack) (except for European models):	sensitivity 1 mV, impedance 10 kilohms
Outputs	
PHONES (stereo mini jack):	accepts headphones of 8 ohms or more
Front speaker:	accepts impedance of 6 to 16 ohms
Surround speaker (MHC-RG66 only):	accepts impedance of 24 ohms
Sub woofer speaker (MHC-RG55 only):	accepts impedance of 12 to 16 ohms

CD player section

System	Compact disc and digital audio system
Laser	Semiconductor laser ($\lambda=780$ nm) Emission duration: continuous
Frequency response	2 Hz – 20 kHz (± 0.5 dB)
Wavelength	780 – 790 nm
Signal-to-noise ratio	More than 90 dB
Dynamic range	More than 90 dB
CD OPTICAL DIGITAL OUT (Square optical connector jack, rear panel)	
Wavelength	660 nm
Output Level	-18 dBm

Tape deck section

Recording system	4-track 2-channel stereo
Frequency response	50 – 13,000 Hz (± 3 dB), using Sony TYPE I cassette
Wow and flutter	$\pm 0.15\%$ W.Peak (IEC) 0.1% W.RMS (NAB) $\pm 0.2\%$ W.Peak (DIN)

Tuner section

FM stereo, FM/AM superheterodyne tuner

FM tuner section

Tuning range	87.5 – 108.0 MHz
Antenna	FM lead antenna
Antenna terminals	75 ohm unbalanced
Intermediate frequency	10.7 MHz

AM tuner section

Tuning range	European and Middle Eastern models: 531 – 1,602 kHz (with the interval set at 9 kHz)
Other models:	531 – 1,602 kHz (with the interval set at 9 kHz) 530 – 1,710 kHz (with the interval set at 10 kHz)
Antenna	AM loop antenna
Antenna terminals	External antenna terminal
Intermediate frequency	450 kHz

continued

Specifications (continued)

Speaker

Front speaker SS-RG66 for MHC-RG66/RG55

Speaker system	3-way, 3-unit, bass-reflex type
Speaker units	
Sub Woofer:	13 cm, cone type
Woofer:	13 cm, cone type
Tweeter:	5 cm, cone type
Nominal impedance	6 ohms
Dimensions (w/h/d)	Approx. 215 × 356 × 285 mm
Mass	Approx. 4.5 kg net per speaker

Surround speaker SS-RS66 for MHC-RG66

Speaker system	2-way, 2-unit, bass-reflex type
Speaker units	
Woofer:	10 cm, cone type
Tweeter:	5 cm, cone type
Nominal impedance	24 ohms
Dimensions (w/h/d)	Approx. 150 × 325 × 220 mm
Mass	Approx. 2.3 kg net per speaker

Front speaker SS-RG55 for MHC-RG55S

Speaker system	3-way, 3-unit, bass-reflex type
Speaker units	
Woofer:	13 cm, cone type
Tweeter:	5 cm, cone type
Supertweeter:	2 cm, dome type
Nominal impedance	6 ohms
Dimensions (w/h/d)	Approx. 200 × 325 × 237 mm
Mass	Approx. 3.6 kg net per speaker

Sub woofer speaker SS-WG99 for MHC-RG55S

Speaker system	Passive sub woofer
Speaker units	
Woofer:	15 cm, cone type
Nominal impedance	12 ohms
Dimensions (w/h/d)	Approx. 210 × 325 × 239 mm
Mass	Approx. 4.0 kg

General

Power requirements	
European model:	230 V AC, 50/60 Hz
Australian models:	230 – 240 V AC, 50/60 Hz
Mexican model:	120 V AC, 50/60 Hz
Argentine models:	220 V AC, 50/60 Hz
Korean model:	220 V AC, 60 Hz
Other models:	120 V, 220 V or 230 – 240 V AC, 50/60 Hz
	Adjustable with voltage selector
Power consumption	
European models:	
MHC-RG66:	220 watts
	0.5 watts (at the Power Saving Mode)
MHC-RG55S:	150 watts
	0.5 watts (at the Power Saving Mode)
Other models:	
MHC-RG66:	220 watts
MHC-RG55:	200 watts
Dimensions (w/h/d)	Approx. 280 × 325 × 421 mm
Mass	
HCD-RG66:	Approx. 10.5 kg
HCD-RG55S:	Approx. 9.0 kg
HCD-RG55:	Approx. 10.0 kg
Supplied accessories:	AM loop antenna (1) Remote Commander (1) Batteries (2) FM lead antenna (1) Front speaker pads (8)

Design and specifications are subject to change without notice.