

# *Micro Hi-Fi Component System*

---

## Operating Instructions

### Owner's Record

The model and serial numbers are located on the bottom of the unit. Record the serial number in the space provided below. Refer to them whenever you call upon your Sony dealer regarding this product.

Model No. \_\_\_\_\_ Serial No. \_\_\_\_\_



***CMT-EP505  
CMT-EP404***

## WARNING

### To prevent fire or shock hazard, do not expose the unit to rain or moisture.

To avoid electrical shock, do not open the cabinet. Refer servicing to qualified personnel only.

Do not install the appliance in a confined space, such as a bookcase or built-in cabinet.

CLASS 1 LASER PRODUCT  
LUOKAN 1 LASERLAITE  
KLASS 1 LASERAPPARAT

This appliance is classified as a CLASS 1 LASER product.

This label is located on the bottom.

To prevent fire, do not cover the ventilation of the apparatus with newspapers, table-cloths, curtains, etc. And don't place lighted candles on the apparatus.

To prevent fire or shock hazard, do not place objects filled with liquids, such as vases, on the apparatus.



Don't throw away the battery with general house waste, dispose of it correctly as chemical waste.

### NOTICE FOR THE CUSTOMERS IN THE U.S.A.

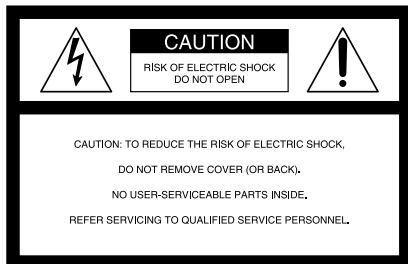

This symbol is intended to alert the user to the presence of uninsulated "dangerous voltage" within the product's enclosure that may be of sufficient magnitude to constitute a risk of electric shock to persons.



This symbol is intended to alert the user to the presence of important operating and maintenance (servicing) instructions in the literature accompanying the appliance.

### CAUTION

The use of optical instruments with this product will increase eye hazard.

### WARNING

This equipment has been tested and found to comply with the limits for a Class B digital device, pursuant to Part 15 of the FCC Rules. These limits are designed to provide reasonable protection against harmful interference in a residential installation. This equipment generates, uses, and can radiate radio frequency energy and, if not installed and used in accordance with the instructions, may cause harmful interference to radio communications. However, there is no guarantee that interference will not occur in a particular installation. If this equipment does cause harmful interference to radio or television reception, which can be determined by turning the equipment off and on, the user is encouraged to try to correct the interference by one or more of the following measures:

- Reorient or relocate the receiving antenna.
- Increase the separation between the equipment and receiver.
- Connect the equipment into an outlet on a circuit different from that to which the receiver is connected.
- Consult the dealer or an experienced radio/TV technician for help.

### CAUTION

You are cautioned that any changes or modifications not expressly approved in this manual could void your authority to operate this equipment.

### Note to CATV system installer:

This reminder is provided to call the CATV system installer's attention to Article 820-40 of the NEC that provides guidelines for proper grounding and, in particular, specifies that the cable ground shall be connected to the grounding system of the building, as close to the point of cable entry as practical.

### NOTICE FOR THE CUSTOMERS IN CANADA

### CAUTION

TO PREVENT ELECTRIC SHOCK, DO NOT USE THIS POLARIZED AC PLUG WITH AN EXTENSION CORD, RECEPTACLE OR OTHER OUTLET UNLESS THE BLADES CAN BE FULLY INSERTED TO PREVENT BLADE EXPOSURE.

## About this manual

The instructions in this manual are for the CMT-EP404 and CMT-EP505. CMT-EP505 is the model used for illustration purposes.

# Table of Contents

## List of Button Locations and Reference Pages

Main unit .....	4
Remote control .....	5

---

## Getting Started

Hooking up the system .....	6
Inserting two size AA (R6) batteries into the remote .....	7
Setting the clock .....	7

---

## CD

Loading the CD .....	8
Playing the CD	
— Normal Play/Shuffle Play/Repeat Play .....	8
Programing the CD tracks	
— Program Play .....	9

---

## Tuner

Presetting radio stations .....	10
Listening to the radio	
— Preset Tuning .....	11
— Manual Tuning .....	12
Using the Radio Data System (RDS)*	12

---

## Tape

Loading a tape .....	14
Playing a tape .....	14
Recording to a tape	
— CD Synchro Recording/Recording Manually .....	15
Timer-recording radio programs .....	16

---

## Sound Adjustment

Adjusting the sound	
— MEGA BASS .....	17
Turning off the sound	
— Muting .....	17

---

## Timer

Falling asleep to music	
— Sleep Timer .....	17
Waking up to music	
— Daily Timer .....	18

---

## Display

Using the CD display .....	19
----------------------------	----

---

## Troubleshooting

Problems and remedies .....	19
-----------------------------	----

---

## Additional information

Precautions .....	21
Specifications .....	22

\* For European model only

How to use this page

Use this page to find the location of buttons and other parts of the system that are mentioned in the text.

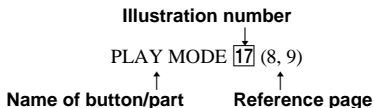

## Main unit

### ALPHABETICAL ORDER

#### A - M

Cassette compartment **15** (14)  
 CD **4** (8, 9, 15)  
 DIR\* **17** (14, 15)  
 DISPLAY **2** (12, 19)  
 Display Window **5** (8, 9, 10, 11)  
 ENTER **16** (7, 9, 10, 11, 13)  
 MEGA BASS **8** (17)  
 MUSIC MENU **9** (17)

#### P - Z

PHONES jack **18**  
 PLAY MODE **17** (8, 9)  
 PRESET +/- **13** (11, 13)  
 RDS/DIR\*\* **17** (13, 14, 15)  
 Remote sensor **10**  
 TAPE **3** (14)  
 TIMER indicator **1** (16, 18)  
 TUNER **6** (10, 11, 12, 15)  
 TUNER MEM **16** (10, 11)  
 TUNING +/- **11** (10, 11, 12, 13)  
 VOLUME control **12**

### BUTTON DESCRIPTIONS

**I** (power) **23** (7, 16, 18)

CD

**◀◀◀** (go back) **11** (8, 9, 14)  
**▶▶▶** (go forward) **11** (8, 9, 14)

**▶◀\*** (play) **20** (8, 9)

**▶\*\*\*** (play) **20** (8, 9)

**||** (pause) **22** (8)

**▲** PUSH OPEN/CLOSE **7** (8)

**■** (stop) **19** (8, 9)

TAPE

**▶▶▶▶** (fast forward) **11** (14)

**||** (pause) **22** (14)

**▶◀\*** (play) **20** (14, 15, 16)

**▶\*\*\*** (play) **20** (14)

**●** (recording) **21** (15, 16)

**◀◀◀** (rewind) **11** (14)

**▲** PUSH OPEN/CLOSE **14** (14)

**■** (stop) **19** (14, 15)

\* CMT-EP505 only

\*\* CMT-EP505, European model only

\*\*\*CMT-EP404 only

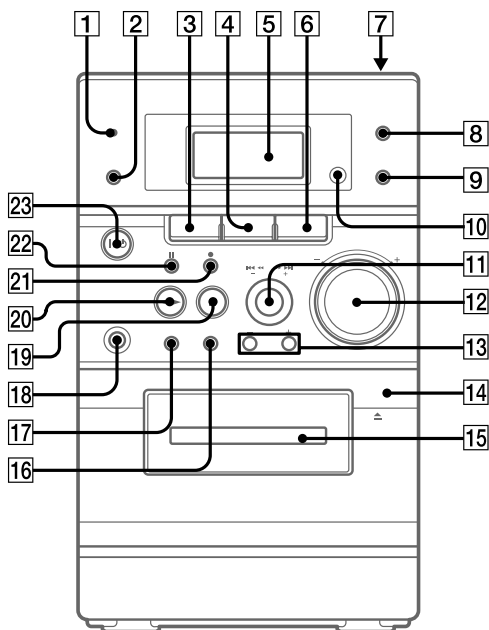

# Remote control

## ALPHABETICAL ORDER

### A - M

CD **24** (8, 9, 15)  
 CLOCK/TIMER +/- **20** (16, 18)  
 CLOCK/TIMER ON/OFF **2** (16, 18)  
 CLOCK/TIMER SET **3** (7, 16, 18)  
 DISPLAY **11** (12, 19)  
 ENTER **14** (7, 9, 10, 11, 13, 18)  
 MEGA BASS **13** (17)  
 MUSIC MENU +/- **16** (17)  
 MUTING **15** (17)

### P - Z

PLAY MODE/RDS/DIR\* **7** (8, 9, 13, 14, 15)  
 PRESET +/- **9** (11, 13)  
 REPEAT **8** (8)  
 SLEEP **1** (17)  
 TAPE **23** (14)  
 TUNER/BAND **5** (10, 11, 12, 15)  
 TUNER MEMORY **17** (10, 11)  
 TUNING + **10** (10, 11, 12, 13)  
 TUNING - **18** (10, 11, 12, 13)  
 VOL (volume) +/- **12**

## BUTTON DESCRIPTIONS

◀◀ (rewind) ▶▶ (fast forward) **19** (8, 14)  
 ◀◀ (go back) ▶▶▶ (go forward) **20** (7, 8, 14, 15)  
 || (pause) **22** (8, 14)  
 ◀▶▶▶ (play) **21** (8, 9, 14, 15, 16)  
 I/⏻ (power) **4** (7, 16, 18)  
 ■ (stop) **6** (8, 9, 14, 15)

- \* The DIR function works for CMT-EP505 only.  
 The RDS function works for CMT-EP505, European model only.
- \*\* The ◀ (reverse play) function works for CMT-EP505 only.
- \*\*\* The ◀◀/▶▶ button does not work for CMT-EP404 tape function.

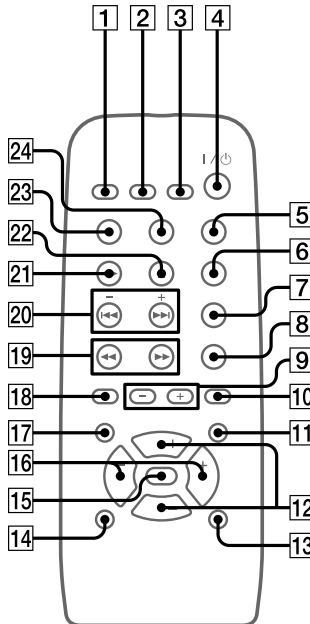

## Hooking up the system

Do the following procedure **1** to **3** to hook up your system using the supplied cords and accessories.

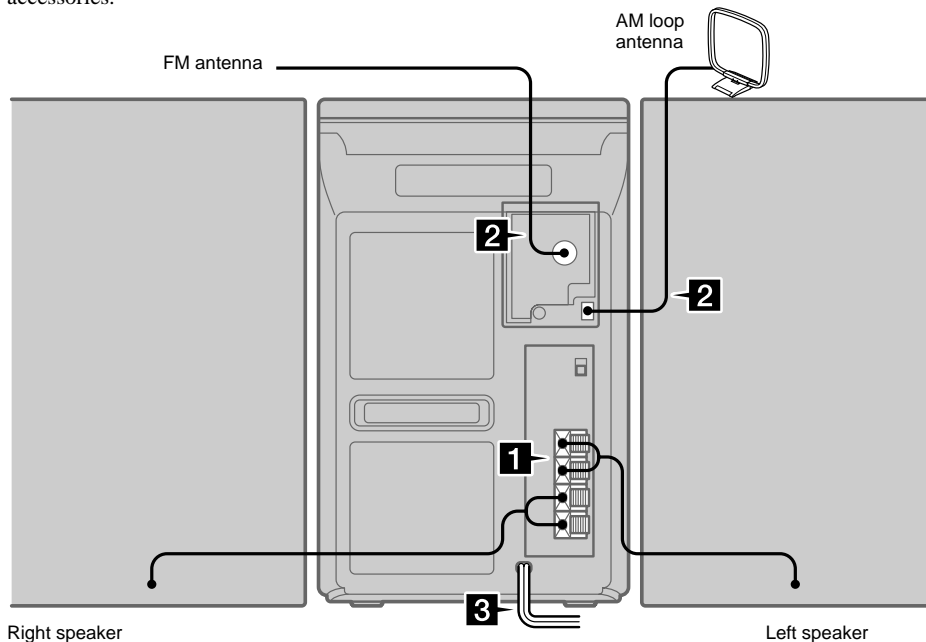

### **1** Connect the speakers.

Connect the speaker cords to the SPEAKER terminals as shown below.

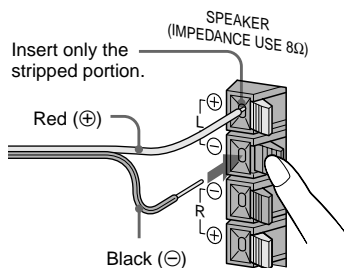

### **2** Connect the FM/AM antennas (CMT-EP505 only).

Set up the AM loop antenna, then connect it.

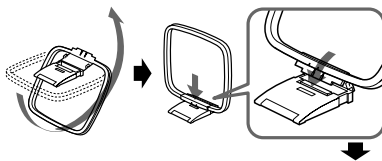

#### Jack type **A**

Extend the FM lead antenna horizontally.

AM loop antenna

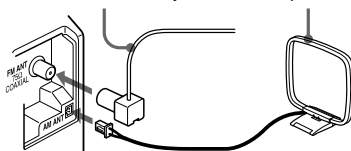

**Jack type ②**

Extend the FM lead antenna horizontally.

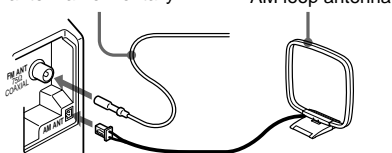
**3 Connect the power cord to a wall outlet.**

If the supplied adaptor on the plug does not fit your wall outlet, detach it from the plug (only for models equipped with the adaptor).

To turn on the system, press **I** / **⏻** (power).

## Inserting two size AA (R6) batteries into the remote

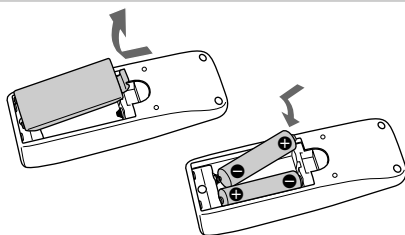
**Tip**

When the remote no longer operates the system, replace both batteries with new ones.

**Note**

If you do not use the remote for a long period of time, remove the batteries to avoid possible damage from battery leakage.

## Setting the clock

- 1 Turn on the system.
- 2 Press **CLOCK/TIMER SET** on the remote.
- 3 Press **◀◀** or **▶▶** on the remote repeatedly to set the hour.
- 4 Press **ENTER**.
- 5 Press **◀◀** or **▶▶** on the remote repeatedly to set the minute.
- 6 Press **ENTER**.  
The clock starts working.

To adjust the clock

- 1 Press **CLOCK/TIMER SET** on the remote.
- 2 Press **◀◀** or **▶▶** on the remote to select "SET CLK", then press **ENTER**.
- 3 Do the same procedures as step 3 to 6 above.

**Note**

The clock settings are canceled when you disconnect the power cord or if a power failure occurs.

## Loading the CD

- 1 Press **▲ PUSH OPEN/CLOSE** down to open the lid of the CD compartment.
- 2 Place a CD with the label side up on the compartment.

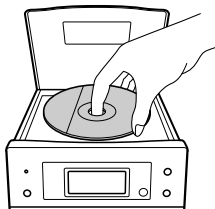

- 3 Press **▲ PUSH OPEN/CLOSE** down to close the lid of the CD compartment.

## Playing the CD

### — Normal Play/Shuffle Play/Repeat Play

This system lets you play the CD in different play modes.

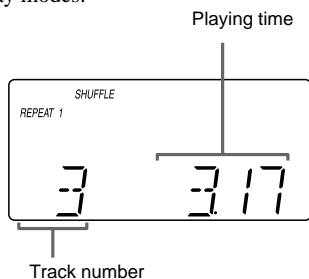

- 1 Press **CD**.
- 2 Press **PLAY MODE (PLAY MODE/RDS/DIR on the remote)** repeatedly until the mode you want appears in the display.

Select	To play
No display (Normal Play)	The CD in original order.
SHUFFLE (Shuffle Play)	The tracks on the CD in random order.
PROGRAM (Program Play)	The tracks on the CD in the order you want them to be played (see "Programing the CD tracks" on page 9).

- 3 Press **◀▶ (CMT-EP505)** or **▶ (◀▶ on the remote, CMT-EP404)**.

## Other Operations

To	Do this
Stop playback	Press <b>■</b> .
Pause	Press <b>⏸</b> . Press again to resume play.
Select a track	Turn <b>◀▶/▶▶</b> clockwise or counterclockwise (or press <b>◀◀</b> or <b>▶▶</b> on the remote).
Find a point in a track	During play, turn and hold <b>◀▶/▶▶</b> clockwise or counterclockwise (or keep pressing <b>◀◀</b> or <b>▶▶</b> on the remote). Release it when you find the desired point.
Play repeatedly (Repeat Play)	Press <b>REPEAT</b> on the remote during play until "REPEAT" or "REPEAT 1" appears. REPEAT: For all the tracks on the CD up to five times. REPEAT 1: For a single track only. To cancel playing repeatedly, press <b>REPEAT</b> on the remote until "REPEAT" or "REPEAT 1" disappears.
Remove the CD	Press <b>▲ PUSH OPEN/CLOSE</b> .



# Programming the CD tracks

## — Program Play

You can make a program of up to 32 tracks in the order you want them to be played.

- 1 Press **CD**, then place a CD.
- 2 Press **PLAY MODE (PLAY MODE/RDS/DIR on the remote)** repeatedly until **“PROGRAM”** appears in the display.
- 3 Turn **◀▶/▶▶** clockwise or counterclockwise (or press **◀◀** or **▶▶** on the remote) until the desired track appears in the display.

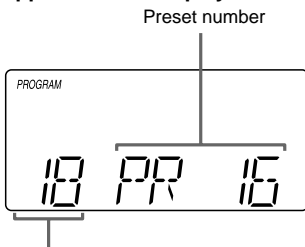

- 4 Press **ENTER**.  
The track is programmed. The program step number appears.
- 5 To program additional tracks, repeat steps 3 to 4.
- 6 Press **◀▶** (CMT-EP505) or **▶** (**◀▶** on the remote, CMT-EP404).  
Program Play starts.

To	Do this
Cancel Program Play	Press <b>PLAY MODE (PLAY MODE/RDS/DIR on the remote)</b> until <b>“PROGRAM”</b> disappears from the display.
Add a track to the end of the program	Do steps 3 and 4 with Program Play stopped.
Erase the entire program	Press <b>■</b> once, when Program Play is in stop mode, or twice during Program Play.

### Tip

The program you made remains in the system's memory even after it has been played back. Press **CD**, then press **◀▶** (CMT-EP505) or **▶** (**◀▶** on the remote, CMT-EP404) to play the same program again.

## Presetting radio stations

You can preset up to 30 stations for FM and AM. You can then tune in any of those stations simply by selecting the corresponding preset number.

There are two ways to store the station presets.

To	Method
Automatically tune all of the stations that can be received in your area and then store them manually	Automatic Tuning Preset
Manually tune and store the radio frequency of your favourite stations	Manual Tuning Preset

Setting presets through automatic tuning

- 1 Press **TUNER (TUNER/BAND on the remote)** repeatedly to select “FM” or “AM”.
- 2 Turn and hold **TUNING +/-** (or press and hold **TUNING +** or **TUNING -** on the remote) until the frequency indication starts to change, then release it.

Scanning stops automatically when the system tunes in a station. “STEREO” (for a stereo program) appears.

### If the scanning doesn't stop

Set the frequency of the desired radio station as described in steps 2 through 5 of “Setting presets through manual tuning”.

- 3 Press **TUNER MEM (TUNER MEMORY on the remote)**.

The preset number starts flashing.

The stations are stored from preset number 1.



- 4 Press **ENTER**.  
The station is stored.
- 5 Repeat steps 1 to 4 to store other stations.

## Setting presets through manual tuning

- 1 Press **TUNER (TUNER/BAND on the remote)** repeatedly to select “FM” or “AM”.
- 2 Turn and hold **TUNING +/-** (or press and hold **TUNING +** or **TUNING -** on the remote) repeatedly to tune in the desired station.
- 3 Press **TUNER MEM (TUNER MEMORY on the remote)**.

The preset number starts flashing.

The stations are stored from preset number 1.

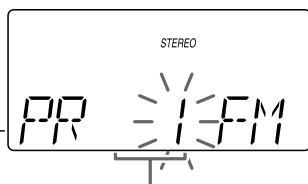

Preset number

- 4 Press **ENTER**.  
The station is stored.
- 5 Repeat steps 1 to 4 to store other stations.

### Other Operations

To	Do this
Tune in a station with a weak signal	Follow the procedure described in “Setting presets through manual tuning”.
Change the preset number	Start over from step 1.
Set another station to an existing preset number	Start over from step 1. After step 3, press <b>PRESET +</b> or <b>-</b> repeatedly to select the preset number where you want to store the other station and then press <b>ENTER</b> .

To erase all preset stations

- 1 Press and hold **TUNER MEM (TUNER MEMORY on the remote)** until “ERASE” and “PRESET” appear alternately.
- 2 Press **ENTER**.  
All preset stations are cleared.

To change the AM tuning interval (except for the European model)

Disconnect the power cord from the wall outlet first, and then set the **AM FREQ STEP** switch at the rear to 9 kHz or 10 kHz.

Tip

The preset stations are retained for half a day even if you unplug the power cord or if a power failure occurs.

## Listening to the radio

You can listen to a radio station either by selecting a preset station, or by manually tuning in the station.

### Listening to a preset station

#### — *Preset Tuning*

Preset radio stations in the tuner’s memory first (see “Presetting radio stations” on page 10).

- 1 Press **TUNER (TUNER/BAND on the remote)**.
- 2 Press **PRESET +** or **-** repeatedly to tune in the desired preset station (or **RDS station name**\*).

The preset number appears in the display for a few seconds.

When only one station is preset, only that station is tuned.

\* European model only.

continued

## Listening to the radio (continued)

Listening to non-preset radio station

### — Manual Tuning

- 1 Press **TUNER (TUNER/BAND on the remote)** repeatedly to select **“FM”** or **“AM”**.
- 2 Turn and hold **TUNING +/- (or press and hold TUNING + or TUNING – on the remote)** repeatedly to tune in the desired station.

#### Tips

- To improve FM broadcast reception, adjust the antennas.
- To improve AM broadcast reception, adjust the antenna (for CMT-EP505) or reorient the main unit itself (for CMT-EP404).
- You can change the display into the clock display (for five seconds) by pressing **DISPLAY**.

## Using the Radio Data System (RDS)

(CMT-EP505, European model only)

What is the Radio Data System?

Radio Data System (RDS) is a broadcasting service that allows radio stations to send additional information along with the regular program signal. This tuner offers convenient RDS features like station name display and location of stations by program type. RDS is available only on FM stations.\*

#### Note

RDS may not work properly if the station you are tuned in is not transmitting the RDS signal properly or if the signal strength is weak.

\* Not all FM stations provide RDS service, nor do they provide the same types of services. If you are not familiar with the RDS system, check with your local radio stations for details on RDS services in your area.

## Receiving RDS broadcasts

Simply select a station from the FM band.

When you tune in a station that provides RDS services, “RDS” appears in the display.

To check the RDS information

Each time you press **DISPLAY**, the display changes as follows:

Frequency → RDS name\* → RDS TEXT\*  
→ RDS type\* → Clock display (for five seconds) → Frequency → ...

\* If the RDS broadcast is not received, the RDS name, RDS TEXT and RDS type may not appear in the display.

## Locating a station by program type (PTY)

You can locate a station you want by selecting a program type. The system tunes in the type of programs currently being broadcast from the RDS stations stored in the tuner's preset memory.

The types of programs include NEWS, AFFAIRS (current news), INFO, SPORT, EDUCATE (education programs), DRAMA, CULTURE, SCIENCE, VARIED (interviews, games and comedy), POP M, ROCK M, EASY M, LIGHT M, CLASSICS, OTHER M, WEATHER, FINANCE, CHILDREN, SOCIAL, RELIGION, PHONE IN, TRAVEL, LEISURE, JAZZ, COUNTRY, NATION M, OLDIES, FOLK M, DOCUMENT, TEST ALARM and NONE (any programs not defined above).

- 1 Press **RDS/DIR (PLAY MODE/RDS/DIR on the remote)** while listening to the radio.
- 2 Press **PRESET + or –** repeatedly to select the program type you want.
- 3 Turn and hold **TUNING +/-** (or press and hold **TUNING + or TUNING –** on the remote).

When the tuner receives a program, "PTY" flashes.

### Tip

"TYPE NOT FOUND" appears when the program type you select is not currently being broadcast.

To cancel PTY

Press **RDS/DIR (PLAY MODE/RDS/DIR on the remote)** again.

## Listening to a traffic information

When the tuner receives traffic information signal, "TRAFFIC INFORMATION" will be scrolled in the display.

- 1 Press **RDS/DIR (PLAY MODE/RDS/DIR on the remote)** repeatedly until "INFO OFF" or "INFO ON" appears while listening to an FM program.
- 2 Press **ENTER** to set "INFO ON".

## Setting the time to the broadcast

You can set the time to the clock information received.

- 1 Press **RDS/DIR (PLAY MODE/RDS/DIR on the remote)** repeatedly until "SYNC OFF" or "SYNC ON" appears while listening to an FM program.
- 2 Press **ENTER** to set "SYNC ON".

## Loading a tape

- 1 Press **▲** PUSH OPEN/CLOSE.
- 2 Insert a tape in deck with the side you want to play/record facing forward.

Insert with the side you want to play/record facing forward.

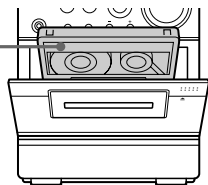

## Playing a tape

You can use TYPE I (normal), TYPE II (CrO<sub>2</sub>) (CMT-EP505 only) or TYPE IV (metal) (CMT-EP505 only) tape.

- 1 Load a recorded tape.
- 2 Press **TAPE**.
- 3 Press **RDS/DIR (PLAY MODE/RDS/DIR on the remote) repeatedly to select** **↔** to play one side, **↔↔** to play both sides, or **↔↔\*** to play both sides repeatedly (CMT-EP505 only).

\* The tape automatically stops after playing back five times.

- 4 Press **◀▶** (CMT-EP505) or **▶** (**◀▶** on the remote, CMT-EP404).

Press **◀▶** again to play the reverse side (CMT-EP505 only).

Finding the beginning of a track (AMS\*) (CMT-EP505 only)

During playback, turn **◀◀/▶▶** clockwise or counterclockwise (or press **◀◀** or **▶▶** on the remote).

The tape is wound or rewound to the beginning of the next or current track, and play will start automatically. The search direction, “+” (forward) or “-” (back), and “1” appear in the display.

\* AMS (Automatic Music Sensor)

### Note

The AMS function may not operate correctly under the following circumstances:

- When the unrecorded space between tracks is less than 4 seconds long.
- When the system is placed near a television.

To	Do this
Stop play	Press <b>■</b> .
Pause	Press <b>  </b> . Press again to resume play.
Fast-forward or rewind	With the tape stopped, turn <b>◀◀/▶▶</b> clockwise or counterclockwise (or press <b>◀◀</b> or <b>▶▶</b> on the remote).
Remove the cassette	Press <b>▲</b> PUSH OPEN/CLOSE.

# Recording to a tape

## — CD Synchro Recording/Recording Manually

You can record from a CD or radio. You can use TYPE I (normal) tape.

Steps	Recording from a CD (CD Synchro Recording)	Recording from the radio
1	Load a blank tape.	
2	Press CD.	Press TUNER (TUNER/BAND on the remote).
3	Load the CD you want to record.	Tune in the station you want to record.
4	<p>Press ●.</p> <p>The deck stands by for recording.</p> <p>When you want to record on the reverse side, press ◀▶ (CMT-EP505 only).</p>	
5	<p>Press RDS/DIR (PLAY MODE/RDS/DIR on the remote) repeatedly to select ⇐⇒ to record on one side, ⇔ to record on both sides (CMT-EP505 only).</p>	
6	<p>Press ● again.</p> <p>Recording starts.</p>	

Tape

To stop recording

Press ■.

### Tips

- For recording from a CD to a tape manually, you can turn ◀▶/▶▶ clockwise or counterclockwise (or press ◀▶ or ▶▶ on the remote) to select tracks during recording pause mode (after step 4 and before step 6).
- When you record on both sides, be sure to start from the front side. If you start from the reverse side, recording stops at the end of the reverse side (CMT-EP505 only).
- When an AM program is noisy while recording, set the ISS switch at the rear of the unit to select the position that most decreases the noise (CMT-EP404 only).

## Timer-recording radio programs

To timer-record, you must preset the radio station (see “Presetting radio stations” on page 10) and set the clock (see “Setting the clock” on page 7) beforehand.

- 1 **Tune in the preset radio station (see “Listening to the radio” on page 11).**
- 2 **Press CLOCK/TIMER SET on the remote repeatedly until “SET TMR” appears, then press ENTER on the remote.**  
 “ON” appears, and the hour indication flashes.
- 3 **Set the starting time.**  
**Press CLOCK/TIMER + or – on the remote repeatedly to set the hour, then press ENTER on the remote.**  
 The minute indication begins flashing next.  
**Press CLOCK/TIMER + or – on the remote repeatedly to set the minute, then press ENTER on the remote.**  
 The hour indication flashes again.
- 4 **Set the time to stop the recording following the procedure in step 3.**
- 5 **Press CLOCK/TIMER + or – on the remote repeatedly until “RECORD” appears, then press ENTER on the remote.**  
 The TIMER indicator lights up.
- 6 **Press CLOCK/TIMER + or – on the remote repeatedly to adjust the volume\* for listening to the radio when it is activated by the timer, then press ENTER on the remote.**  
 \* This does not affect the recording volume; it only adjusts the volume for when the radio turns on at the preset time.
- 7 **Insert a recordable tape with the side you want to record on facing towards you.**

- 8 Press ●.
- 9 Press ◀▶, if you want to switch the direction (CMT-EP505 only).
- 10 **Press RDS/DIR (PLAY MODE/RDS/DIR on the remote) repeatedly to select ⇌ to record on one side, ⇌ to record on both sides (CMT-EP505 only).**
- 11 **Press I/⏻ to turn off the system.**

To	Do this
Check or change the setting	Turn on the system and then start over from step 1 when the TIMER indicator appears.
Activate the timer operation	Press CLOCK/TIMER ON/OFF on the remote until the TIMER indicator goes on.
Cancel the timer operation	Press CLOCK/TIMER ON/OFF on the remote until the TIMER indicator goes off.

### Notes

- When you use the recording timer at the same time as the Sleep Timer, the Sleep Timer setting has priority.
- You cannot activate the Daily Timer and the recording timer at the same time.
- Do not operate the system from the time the system turns on until the recording starts (about 30 seconds before the preset time).
- If the system is on about 30 seconds before the preset time, the timer-recording will not be activated.
- The volume is reduced to minimum during recording.
- If the system is in the recording or recording-pause mode at the preset time, the timer recording will not be made.
- If the system is playing back a tape at the preset time, the system will switch to the tuner, but the timer recording will not be made.



## Adjusting the sound

Reinforcing the bass sound

### — **MEGA BASS**

You can listen to music with stronger bass tones.

#### **Press MEGA BASS.**

“MEGA BASS” appears in the display and the bass is reinforced.

Press again to cancel MEGA BASS.

Selecting the preset effect from the music menu

#### **Press MUSIC MENU repeatedly to select the preset effect you desire.**

Each time you press the button, the display changes cyclically as follows:

ROCK → POP → JAZZ → FLAT\* → ROCK → ...

\* “FLAT” is displayed for a few seconds.

## Turning off the sound

### — **Muting**

You can turn off the sound temporarily.

#### **Press MUTING on the remote.**

Press again to cancel muting.

Tip

You can also turn up the volume by turning VOLUME clockwise or turning off the power and turning it on again.

## Falling asleep to music

### — **Sleep Timer**

You can set the system to turn off after certain amount of time, so that you can fall asleep to music.

#### **Press SLEEP on the remote.**

Every time you press the button, the minute display (the turn-off time) changes as follows:  
90 → 80 → 70 → ... → 10 → OFF → 90 → ...

While the Sleep Timer is on, “TIMER” flashes in the display.

To	Press
Check the remaining time	SLEEP on the remote once.
Change the time to turn off	SLEEP on the remote repeatedly to select the time you want.
Cancel the Sleep Timer function	SLEEP on the remote repeatedly until “SLEEP OFF” appears.

# Waking up to music

## — Daily Timer

You can wake up to music at a preset time. Make sure you have set the clock (see “Setting the clock” on page 7).

### 1 Prepare the sound source you want to play.

- CD: Place a CD.
- Tape: Insert a tape with the side you want to play on facing towards you.
- Radio: Tune in the preset station you want (see “Listening to the radio” on page 11).

### 2 Press **CLOCK/TIMER SET** on the remote repeatedly until “**SET TMR**” appears, then press **ENTER** on the remote.

“ON” appears, and the hour indication flashes.

### 3 Set the starting time.

**Press **CLOCK/TIMER + or –** on the remote repeatedly to set the hour, then press **ENTER** on the remote.**

The minute indication begins flashing next.

**Press **CLOCK/TIMER + or –** on the remote repeatedly to set the minute, then press **ENTER** on the remote.**

The hour indication flashes again.

### 4 Set the time to stop the playback following the procedure in step 3.

### 5 Press **CLOCK/TIMER + or –** on the remote to select the desired sound source.

The indication changes as follows:

TUNER → RECORD (tuner) → CD →  
TAPE → TUNER → ...

The **TIMER** indicator lights up.

### 6 Press **ENTER** on the remote.

### 7 Press **CLOCK/TIMER + or –** on the remote to adjust the volume, then press **ENTER** on the remote.

The start time, the stop time, and the sound source appear in turn, before the original display returns.

### 8 Press **I/O** to turn off the system.

To	Do this
Check or change the setting	Turn on the system and then start over from step 1 when the <b>TIMER</b> indicator appears.
Activate the timer operation	Press <b>CLOCK/TIMER ON/OFF</b> on the remote until the <b>TIMER</b> indicator goes on.
Cancel the timer	Press <b>CLOCK/TIMER ON/OFF</b> on the remote until the <b>TIMER</b> indicator goes off.

## Using the CD display

### Press DISPLAY repeatedly.

The display changes as follows:

During normal play

Elapsed playing time on the current track →

Remaining time on the current track →

Remaining time on the current CD → Clock display (for five seconds) → Elapsed playing time on the current track → ...

In the stop mode

Total number of tracks and total playing time → Clock display (for five seconds) → Total number of tracks and total playing time → ...

## Problems and remedies

If you have any problem using this system, use the following check list.

First, check that the power cord is connected firmly and the speakers are connected correctly and firmly.

Should any problem persist, consult your nearest Sony dealer.

### General

---

#### The display or button remains lighted or flashes even after the system was turned off.

- Press DISPLAY on the remote repeatedly until the clock display appears.

---

#### The clock indication does not show the correct time.

- A power interruption occurred. Set the clock and timer settings again.

---

#### The clock setting/radio presetting/timer is canceled.

- The power cord is disconnected or a power failure occurs longer than half a day. Redo the following:
  - “Setting the clock” on page 7
  - “Presetting radio stations” on page 10
 If you have set the timer, also redo “Timer-recording radio programs” on page 16 and “Waking up to music” on page 18.

---

#### There is no sound.

- Turn VOLUME clockwise and hold.
- The headphones are connected.
- Insert only the stripped portion of the speaker cord into the SPEAKER terminal. Inserting the vinyl portion of the speaker cord will obstruct the speaker connections.

---

#### There is severe hum or noise.

- A TV or VCR is placed too close to the stereo system. Move the stereo system away from the TV or VCR.

---

#### The timer does not function.

- Set the clock correctly.
- You cannot activate the Timer-recording and Daily Timer at the same time.
- When you used the Sleep Timer, Daily Timer and Timer-recording will not turn on the system until the Sleep Timer turns it off.

## Problems and remedies (continued)

---

### The remote does not function.

- There is an obstacle between the remote and the system.
  - The remote is not pointing in the direction of the system's sensor.
  - The batteries have run down. Replace the batteries.
- 

### The color irregularity on a TV screen persists.

- Turn off the TV set once, then turn it on after 15 to 30 minutes. If the color irregularity still persists, place the speakers farther away from the TV set.
- 

## Speakers

---

### Sound comes from one channel or unbalanced left and right volume.

- Check the speaker connection and speaker placement.
- 

### Sound lacks bass.

- Check that the speaker's + and – terminals are connected correctly.
- 

## CD Player

---

### The CD compartment does not close.

- The CD is not placed properly.
- 

### The sound drops out.

- The lens is dirty. Clean it with a commercially available blower.
- 

### The CD will not play.

- The CD is not lying flat in the CD compartment.
  - The CD is dirty.
  - The CD is inserted label side down.
  - Moisture condensation has built up. Remove the CD and leave the system turned on for about an hour until the moisture evaporates.
- 

## Tape Deck

---

### The tape does not record.

- No tape in the cassette compartment.
  - The tab has been removed from the cassette.
  - The tape has reeled to the end.
- 

### The tape does not record nor play or there is a decrease in sound level.

- The heads are dirty. Clean them (see "Cleaning the tape heads" on page 22).
  - The record/playback heads are magnetized. Demagnetize them (see "Demagnetizing the tape heads" on page 22).
- 

### The tape does not erase completely.

- The record/playback heads are magnetized. Demagnetize them (see "Demagnetizing the tape heads" on page 22).
- 

### There is excessive wow or flutter, or the sound drops out.

- The capstans or pinch rollers are dirty. Clean them (see "Cleaning the tape heads" on page 22).
- 

### Noise increases or the high frequencies are erased.

- The record/playback heads are magnetized. Demagnetize them (see "Demagnetizing the tape heads" on page 22).
- 

## Tuner

---

### Noise is heard.

- Adjust the antennas.
- 

## Messages

---

The following message may appear in the display during operations.

---

### NO DISC

- There is no disc on the CD compartment.
-

## Precautions

### On operating voltage

Before operating the system, check that the operating voltage of your system is identical with the voltage of your local power supply.

### On safety

- The system is not disconnected from the AC power source (mains) as long as it is connected to the wall outlet, even if the system itself has been turned off.
- Unplug the system from the wall outlet (mains) if it is not to be used for an extended period of time. To disconnect the cord (mains lead), pull it out by the plug. Never pull the cord itself.
- Should any solid object or liquid fall into the component, unplug the stereo system and have the component checked by qualified personnel before operating it any further.
- The AC power cord must be changed only at a qualified service shop.
- The nameplate is located on the bottom exterior.

### On placement

- Place the system in a location with adequate ventilation to prevent heat build-up the system.
- Do not place the system in an inclined position.
- Do not place the system in locations where it is;
  - Extremely hot or cold
  - Dusty or dirty
  - Very humid
  - Vibrating
  - Subject to direct sunlight.
- Use caution when placing the unit or speakers on surfaces that have been specially treated (with wax, oil, polish, etc.) as staining or discoloration of the surface may result.

### On heat buildup

- Although the system heats up during operation, this is not malfunction.
- Place the system in a location with adequate ventilation to prevent heat build-up in the system.

If you continuously use this system at a large volume, the cabinet temperature of the top, side and bottom rises considerably. To avoid burning yourself, do not touch the cabinet.

To prevent a malfunction, do not cover the ventilation hole.

### On operation

- If the system is brought directly from a cold to a warm location, or is placed in a very damp room, moisture may condense on the lens inside the CD player. Should this occur, the system will not operate properly. Remove the CD and leave the system turned on for about an hour until the moisture evaporates.
- When you move the system, take out any discs.

If you have any questions or problems concerning your stereo system, please consult your nearest Sony dealer.

### Notes on CDs

- Before playing, clean the CD with a cleaning cloth. Wipe the CD from the center out.
- Do not use solvents.
- Do not expose the CD to direct sunlight or heat sources.
- Discs with non-standard shapes (e.g., heart, square, star) cannot be played on this system. Attempting to do so may damage the system. Do not use such discs.

### Note on CD-R/CD-RW playback

Discs recorded on CD-R/CD-RW drives may not be played back because of scratches, dirt, recording condition or the drive's characteristics. Besides, the discs, which are not yet finalized at the end of recording cannot be played back.

### Cleaning the cabinet

Use a soft cloth slightly moistened with mild detergent solution.

### To save a tape permanently

To prevent a tape from being accidentally recorded over, break off the cassette tab from side A or B as illustrated.

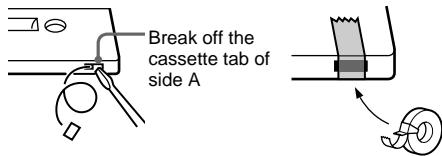

If you later want to reuse the tape for recording, cover the broken tab with adhesive tape.

**continued**

## Precautions (continued)

Before placing a cassette in the tape deck

Take up any slack in the tape. Otherwise the tape may get entangled in the parts of the tape deck and become damaged.

When using a tape longer than 90 minutes

The tape is very elastic. Do not change the tape operations such as play, stop, and fast-winding (etc.) frequently. The tape may get entangled in the tape deck.

Cleaning the tape heads

Clean the tape heads after every 10 hours of use.

Make sure to clean the tape heads before you start an important recording or after playing an old tape. Use separately sold dry-type or wet-type cleaning cassette. For details, refer to the instructions of the cleaning cassette.

Demagnetizing the tape heads

Demagnetize the tape heads and the metal parts that have contact with the tape every 20 to 30 hours of use with a separately sold demagnetizing cassette. For details, refer to the instructions of the demagnetizing cassette.

## Specifications

AUDIO POWER SPECIFICATIONS:

(CMT-EP505, U.S.A. model only)

POWER OUTPUT AND TOTAL

HARMONIC DISTORTION:

with 8  $\Omega$  loads both channels driven, from 120 - 10,000 Hz; rates 14 W per channel minimum RMS power, with no more than 10% total harmonic distortion from 250 mW to rated output.

### Amplifier section

#### Canadian model (CMT-EP505):

Continuous RMS power output (reference)  
14 + 14 W  
(8  $\Omega$  at 1 kHz, 10% THD)

#### European model (CMT-EP505):

DIN power output (rated) 11 + 11 W  
(8  $\Omega$  at 1 kHz, DIN)  
Continuous RMS power output (reference)  
14 + 14 W  
(8  $\Omega$  at 1 kHz, 10% THD)  
Music power output (reference)  
27 + 27 W

#### European model (CMT-EP404):

DIN power output (rated) 6 + 6 W  
(8  $\Omega$  at 1 kHz, DIN)  
Continuous RMS power output (reference)  
8 + 8 W  
(8  $\Omega$  at 1 kHz, 10% THD)  
Music power output (reference)  
16 + 16 W

#### Other model (CMT-EP505):

The following measured at AC 230 V or AC 120 V, 50/60 Hz

DIN power output (rated) 11 + 11 W  
(8  $\Omega$  at 1 kHz, DIN)  
Continuous RMS power output (reference)  
14 + 14 W  
(8  $\Omega$  at 1 kHz, 10% THD)

Outputs

PHONES: Accepts headphones of  
(stereo mini jack) 8  $\Omega$  or more  
SPEAKER: Accepts impedance of 8 to  
16  $\Omega$

## CD player section

System	Compact disc and digital audio system
Laser	Semiconductor laser ( $\lambda=780$ nm) Emission duration: continuous
Frequency response	20 Hz - 20 kHz ( $\pm 0.5$ dB)

## Tape player section

Recording system	4-track 2-channel stereo
Frequency response	50 - 13 000 Hz ( $\pm 3$ dB), using Sony TYPE I cassette
Wow and flutter	$\pm 0.15\%$ W.Peak (IEC) 0.1% W.RMS (NAB) $\pm 0.2\%$ W.Peak (DIN)

## Tuner section

FM stereo, FM/AM superheterodyne tuner

### FM tuner section

Tuning range	87.5 - 108.0 MHz
Antenna	FM lead antenna
Antenna terminal (CMT-EP505)	75 $\Omega$ coaxial
Intermediate frequency	10.7 MHz

### AM tuner section

Tuning range	530 - 1 710 kHz
Pan-American model:	530 - 1 710 kHz (with the interval set at 10 kHz) 531 - 1 710 kHz (with the interval set at 9 kHz)
European model:	531 - 1 602 kHz (with the interval set at 9 kHz)
Other models:	531 - 1 602 kHz (with the interval set at 9 kHz) 530 - 1 710 kHz (with the interval set at 10 kHz)
Antenna	
CMT-EP505:	Supplied AM loop antenna
CMT-EP404:	Built-in ferrite bar antenna
Intermediate frequency	450 kHz

## Speaker

Speaker system	Bass-reflex type
Speaker units	Full range 10 cm, cone type 8 $\Omega$
Nominal impedance	
Dimensions (w/h/d)	Approx. 145 $\times$ 238 $\times$ 165 mm
CMT-EP505:	Approx. 145 $\times$ 237 $\times$ 170 mm
CMT-EP404:	
Mass	
CMT-EP505:	Approx. 1.5 kg
CMT-EP404:	Approx. 1.3 kg

## General

Power requirements	
North American model :	120 V AC, 60 Hz
European model:	230 V AC, 50/60 Hz
Mexican model:	120 V AC, 60 Hz
Argentine model:	220 - 230 V AC, 50/60 Hz
Hong Kong model:	230 V AC, 50/60 Hz
Other models:	230 V AC, 50/60 Hz

## Power consumption

U.S.A. model:	
CMT-EP505:	35 W
Canadian model:	
CMT-EP505:	35 W
European model:	
CMT-EP505:	40 W
CMT-EP404:	38W
CMT-EP505/EP404:	0.5 W (in the standby mode)

Other models:	
CMT-EP505:	40 W

Dimensions (w/h/d):	Approx. 145 $\times$ 240 $\times$ 252 mm
---------------------	--

Mass:	
CMT-EP505:	Approx. 3.5 kg
CMT-EP404:	Approx. 3.1 kg

Supplied accessories:	AM loop antenna (1) (CMT-EP505 only) Remote Commander (1) Batteries (2) FM lead antenna (1) (CMT-EP505 only)
-----------------------	---

Design and specifications are subject to change without notice.

