

A

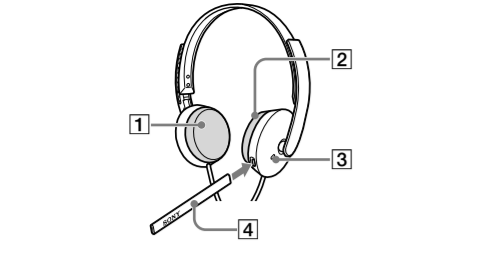

B

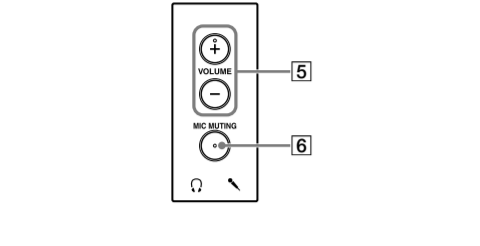

C

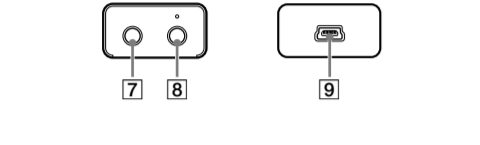

D

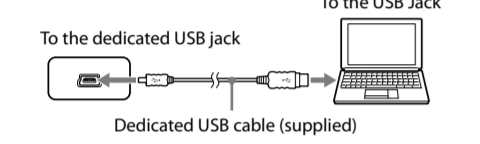

E

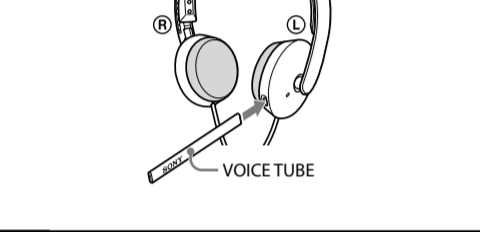

F

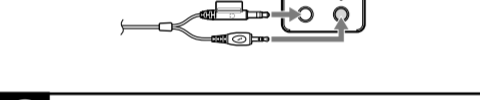

G

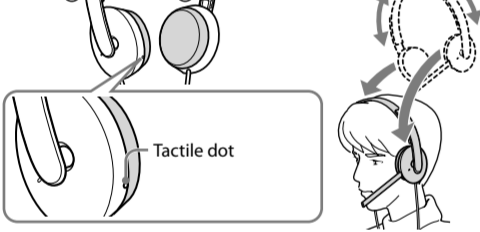

H

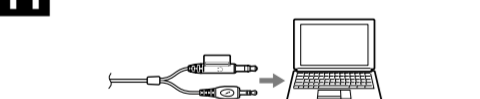

I

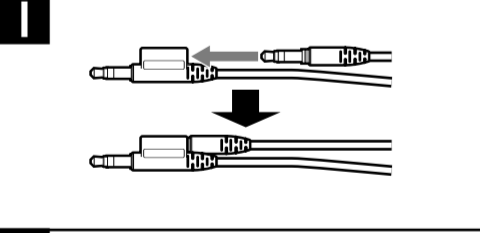

J

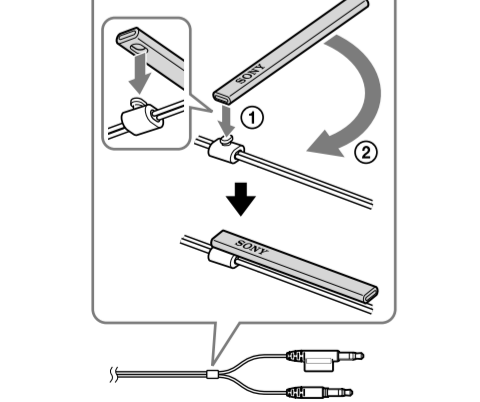

English

Stereo headset

WARNING

To prevent fire or shock hazard, do not expose the unit to rain or moisture.

To prevent fire or shock hazard, do not place objects filled with liquids, such as vases, on the apparatus.

To avoid electrical shock, do not open the cabinet. Refer servicing to qualified personnel only.

CE mark

The validity of the CE marking is restricted to only those countries when it is legally enforced, mainly in the countries EEA (European Economic Area).

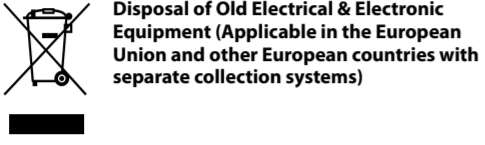

- Microsoft and Windows are registered trademarks or trademarks of Microsoft Corporation in the United States and/or other countries.
- Macintosh and Mac OS are registered trademarks of Apple Inc. in the U.S. and other countries.
- IBM and PC/AT are trademarks and registered trademarks of International Business Machines Corporation.
- Pentium is a trademark or registered trademark of Intel Corporation.
- ™WALKMAN™ and WALKMAN™ logo are registered trademarks of Sony Corporation.
- Skype™ is a trademark of Skype Limited.
- In this manual, Windows® 2000 Professional is referred to as Windows 2000.
- In this manual, Windows® XP Home Edition, Windows® XP Professional and Windows® XP Media Center Edition are referred to as Windows XP.
- In this manual, Windows Vista® is referred to as Windows Vista.
- In this manual, Windows® 7 Edition is referred to as Windows 7.
- In this manual, Macintosh® is referred to as Macintosh.
- All other names of systems and products are trademarks or registered trademarks of their respective owners. ™ and ® marks are omitted in this manual.
- PC screen terms depicted in this manual may differ from the actual terms.

Welcome!

Thank you for purchasing the Sony DR-350USB Stereo Headset. Before operating the unit, please read this manual thoroughly and retain it for future reference.

Some features are:

- Ideal PC Headset for voice chatting, PC Gaming, and music listening.
- Built-in high sensitivity microphone, plus detachable VOICE TUBE for superior communications.
- Smart design and low pressure ear pad for long lasting wearing comfort.
- Practical dual use both mini plug and USB.
- Handy operation via USB Audio Box functions, such as volume control and mic muting.

Specifications

Stereo Headset DR-350	
Cord	1.2 m (47 1/4 in.)
Plug	Gold plated stereo mini plug (for headphone) Gold plated mini plug (for microphone)
Mass	Approx. 110 g (3.9 oz.) (without cord)

Headphones	
Type	Open air dynamic
Driver unit	30 mm, dome type (CCAW adopted)
Power handling capacity	1,000 mW (IEC**)
Impedance	24 Ω at 1 kHz
Sensitivity	100 dB/mW
Frequency response	14 - 22,000 Hz

Microphone	
Design	Built-in microphone
Type	Electret condenser
Open circuit voltage level	-38 dB (0 dB = 1 V/Pa)
Effective frequency rage	20 - 10,000 Hz

USB Audio Box UAB-350	
Frequency range	20 - 20,000 Hz (headphone) 200 - 10,000 Hz (microphone)
Input/Output jacks	Output for headphone (mini jack/stereo) Impedance load: 24 Ω Input for microphone (mini jack/monaural) Plug-in-power system Dedicated USB jack
Power supply	USB bus power compliant (5 V, 100 mA)
Dimensions (excluding projection)	Approx. 31 × 16 × 73 mm (w/h/d) (1 1/4 × 2 3/16 × 2 7/8 in.)
Mass	Approx. 25 g (0.9 oz.)
Operating environment	Compliant computer: IBM PC/AT or compatible computers Apple Macintosh Compliant OS: Windows 7 Starter/Home Basic/Home Premium/Professional/Ultimate Windows Vista Home Basic/Home Premium/Business/Ultimate Windows XP Home Edition (SP2 or later)/Professional (SP2 or later)/Media Center Edition 2004 (SP2 or later)/Media Center Edition 2005 (SP2 or later) Windows 2000 Professional (SP4) Mac OS X (10.3 or later) CPU: Pentium II 266 MHz or better USB port**
Supplied accessories	Dedicated USB cable (1) VOICE TUBE (1) Operating Instructions (1)

- For the operating environment mentioned above, the headset is not guaranteed to operate with all computers.
- The headset is not guaranteed to operate with home built computers, operating systems that are personally up-graded, or multiple operating systems.
- The headset is not guaranteed to operate with functions such as system suspend, sleep and hibernation, on all computers.

* IEC (International Electronic Committee) tested.

** The USB Audio Box supports USB 2.0 (USB 2.0 Full Speed).

Design and specifications are subject to change without notice.

Identifying parts

Headset DR-350 (see fig. **A)**

- Ear pad (Right)**
- Ear pad (Left)**
- Microphone**
- VOICE TUBE**
Attach the VOICE TUBE to the headset.
- PHONE VOLUME + / - button (for headphone)**
Adjust the volume level of the headset.
- MIC MUTING button**
(light out) OFF: The microphone is set to MUTING OFF mode.
(light up) MUTING: The microphone is set to MUTING ON mode.

USB Audio Box connection parts (see fig. **C)**

- Headphone jack**
- Microphone jack* (Plug-in-power system)**
- Dedicated USB jack**

* There is a tactile dot on the USB Audio Box for easy recognition.

Step 1: Connection

Connect your USB Audio Box and computer with the supplied dedicated USB cable (see fig. **D**).

Notes

- The headset supports the USB 2.0 version (USB 2.0 Full Speed).
- The headset is not guaranteed to operate with a USB hub or USB extension cable. Use the supplied dedicated USB cable only.
- When the headset is connected to the computer, the volume level of the computer may be set to maximum. Turn down the volume of the computer beforehand.
- When you use the USB Audio Box, the voice of a digital broadcast is not output from the computer. To listen to the voice, connect the headset to the computer directly without using the USB Audio Box.

Step 2: Installing the USB driver

USB drivers are included in operating systems if you are using Windows 2000, Windows XP, Windows Vista, Windows 7, and Macintosh. USB drivers will be installed when the system is connected to a computer for the first time. Follow the on-screen instructions to install. For details, refer to the operating instructions of your computer.

Note

When connecting to different USB ports, you may have to install USB drivers.

For Windows 2000/Windows XP

When the system is connected to a computer, the USB Composite Device, USB Human Interface Device and USB Audio Device are installed automatically.

For Windows Vista/Windows 7

When the system is connected to a computer, the USB Composite Device, USB Human Interface Device and UAB-350 are installed automatically.

For Macintosh

When the system is connected to a computer, the UAB-350 is installed automatically.

Step 3: Setting for music CD playback

This setting is necessary when playing back a music CD in the CD-ROM drive.

Follow the instructions below according to your operating system and click the check box of **[Enable digital CD audio for this CD-ROM device]**. For Windows Vista, Windows 7 and Macintosh, setting for music CD playback is not necessary.

For Windows 2000

Click the **[Start]** menu, and select **[Settings]**, **[Control Panel]**, **[Sounds and Multimedia]**, and **[Hardware]** tab. Select the CD-ROM drive for playing music, click **[Properties]**, and then click the **[Properties]** tab again. Click the check box of **[Enable digital CD audio for this CD-ROM device]**.

For Windows XP

Click the **[start]** menu, and select **[Control Panel]**, **[Sounds, Speech and Audio Devices]**, **[Sounds and Audio Devices]**, and **[Hardware]** tab. Select the CD-ROM drive for playing music, click **[Properties]**, and then click the **[Properties]** tab again. Click the check box of **[Enable digital CD audio for this CD-ROM device]**.

How to use

- Attach the VOICE TUBE to the headset, with the Sony logo facing outwards (see fig. **E**).**
The VOICE TUBE helps the microphone more effectively pick up your voice.
- Connect the headphone plug (black) to the headphone jack and connect the microphone plug (pink) to the microphone jack (see fig. **F**).**
UAB-350 is for only the headset (DR-350). If another headset is connected to the USB Audio Box, malfunction may occur.
- Adjust the band of the headset, and then wear the ear pad marked on your right ear, and the one marked on your left ear.**
There is a tactile dot on the unit marked to distinguish the left side (see fig. **G**).

Adjusting the volume level of the microphone
Check and adjust the volume level of the microphone by the computer. Follow the instructions below according to your operating system, and check/adjust the volume level. For details on the operation of your computer, refer to the operating instructions of your computer.

■ For Windows

For Windows 2000

Click the **[Start]** menu, select **[Programs]**, **[Accessories]**, **[Entertainment]**, **[Sound Recorder]**. Check the volume level after recording with the **[Sound Recorder]**. If the volume level is too high or too low, click the **[Start]** menu and select **[Settings]**, **[Control Panel]**, **[Sounds and Multimedia]**, and **[Audio]** tab. Check that **[Preferred device]** in the **Sound Recording** menu is set to **[UAB-350]**, and click **[Volume]** in **Sound Recording** menu, and adjust the microphone input level.

For Windows XP

Click the **[start]** menu, select **[All Programs]**, **[Accessories]**, **[Entertainment]**, and **[Sound Recorder]**. Check the volume level after recording with the **[Sound Recorder]**. If the volume level is too high or too low, click the **[start]** menu and select **[Control Panel]**, **[Sounds, Speech and Audio Devices]**, **[Sounds and Audio Devices]**, and **[Audio]** tab. Check that **[Default device]** in the **Sound recording** menu is set to **[UAB-350]** and click **[Volume]** in **Sound recording** menu, and adjust the microphone input level.

For Windows Vista

Click the **[Start]** menu, select **[All Programs]**, **[Accessories]**, **[Sound Recorder]**. Record with the **[Sound Recorder]**. Click the **[Start]** menu and select **[Control Panel]**, **[Hardware and Sound]**, **[Sound]**, **[Recording]** tab, and select **[UAB-350]** for the recording device and click **[Set Default]**. Select **[UAB-350]** again, click **[Properties]**, select the **[Levels]** tab, and adjust the microphone input level.

For Windows 7

Click the **[Start]** menu, select **[All Programs]**, **[Accessories]**, **[Sound Recorder]**. Record with the **[Sound Recorder]**. Click the **[Start]** menu and select **[Control Panel]**, **[Hardware and Sound]**, **[Sound]**, **[Recording]** tab, and select **[UAB-350]** for the recording device and click **[Set Default]**. Select **[UAB-350]** again, click **[Properties]**, select the **[Levels]** tab, and adjust the microphone input level.

■ For Macintosh

Click the **[Apple]** menu, select **[System Preferences]**, **[Sound]**, **[Input]** tab, and adjust the microphone input level.

- The microphone does not support muting on the audio recording device of your computer. Set MUTING OFF mode by pressing the MIC MUTING button on the USB Audio Box to mute the microphone.
- You may have to perform settings depending on the software. For details, refer to the operating instructions of your software.

Using the headset separately

You can also use the headset without the USB Audio Box. Connect the headphone plug (black) to the headphone jack of the computer and connect the microphone plug (pink) to the microphone jack of the computer (see fig. **F**).

Notes

- When you connect the headset to the computer directly, this headset does not operate for Apple Macintosh or Mac OS.
- When you control the volume of the headset, adjust it on the computer.

When you do not use the microphone plug

When listening to a Walkman, etc., but not using the microphone, you can insert the microphone plug into the plug holder attached to the headphone plug so that it does not dangle (see fig. **F**).

When you do not use the VOICE TUBE
When storing the VOICE TUBE, you can attach it to the headset to avoid losing it (see fig. **F**).

① Insert the convex section of the cord in the hole of the VOICE TUBE.

② Rotate the VOICE TUBE 90-degrees to secure in place.

Precautions

On Safety

- UAB-350 is for only the headset (DR-350). If another headset is connected to the USB Audio Box, malfunction may occur.
- Listening with the headset at high volume may affect your hearing. For traffic safety, do not use while driving or cycling.
- Be careful not to use the headset at too loud a volume level. Otherwise, audio feedback (howling) may occur as the microphone picks up the sound from the headphone unit.
- Do not drop your headset or subject it to external shock, as it may cause a malfunction.
- Do not disassemble or attempt to open any parts of the system.
- Grasp the plug part of the dedicated USB cable or headset cord when you disconnect from the connectors or jacks.
- After operating the headset with the dedicated USB cable or headset cord, disconnect the USB cable from the computer if the headset is not to be used for an extended period of time.
- Do not use alcohol, benzene, or thinner to clean the cabinet.
- Sound from the headset may be interrupted depending on the communication conditions of the network.
- Do not put weight or pressure on the headset, especially the VOICE TUBE, as it may cause the headset to deform during long storage.
- Do not clean the VOICE TUBE before detaching it from the headset. It may damage the VOICE TUBE.
- The following should be considered regarding placement to avoid malfunctions.**
- Do not leave the system in a location near heat sources, radios or TV receivers, or a place subject to direct sunlight, excessive dust, moisture, rain or mechanical shock.
- Do not leave the system in a bathroom or other high-humidity location.
- Although this system is magnetically shielded, do not leave recorded tapes, watches, personal credit cards or floppy disks using magnetic coding in front of the system for an extended period of time.

About headset usage

Act considerably

If the volume is too high, sound may leak outside the headset. Be careful not to raise the volume so high that it bothers people around you. There is a tendency to raise the volume when listening in noisy places. However, the volume should be kept at a level where you can respond when called, etc.

About the ear pads

The ear pads are replaceable. Replace them when they are worn out. To replace the ear pads, consult your nearest Sony dealer.

If you have any questions or problems concerning your system that are not covered in this manual, please consult your nearest Sony dealer.

Troubleshooting

Sound of the headset is low.

- The headphone plug is not connected to the jack properly.
→ Connect the headphone plug properly.
- The volume control of your computer or the volume level of the music playback software is turned down.
→ Adjust the volume control.
→ Turn up the volume level of the music playback software.

There is no sound from the headset.

- The dedicated USB cable is not connected to your computer.
→ Connect the dedicated USB cable to your computer.
- The headphone plug is not connected to the headphone jack.
→ Connect the headphone plug to the headphone jack.
- The system is connected while music software is in use.
→ Stop playback of the music software and start again.
- The audio device of your computer is not set correctly.
→ **For Windows 2000**
Click the **[Start]** menu, and select **[Settings]**, **[Control Panel]**, **[Sounds and Multimedia]**, **[Audio]** tab, and then select **[UAB-350]** for **[Preferred device]** in the **Sound Playback** menu.
→ **For Windows XP**
Click the **[start]** menu, select **[Control Panel]**, **[Sounds, Speech and Audio Devices]**, **[Sounds and Audio Devices]**, **[Audio]** tab, and then select **[UAB-350]** for **[Default device]** in the **Sound playback** menu.
→ **For Windows Vista**
Click the **[Start]** menu, select **[Control Panel]**, **[Hardware and Sound]**, **[Sound]**, **[Playback]** tab, select **[UAB-350]** for the playback device, and then click **[Set default]**.

For Windows 7

Click the **[Start]** menu, select **[Control Panel]**, **[Hardware and Sound]**, **[Sound]**, **[Playback]** tab, select **[UAB-350]** for the playback device, and then click **[Set default]**.

For Macintosh

Click the **[Apple]** menu, select **[System Preferences]**, **[Sound]**, **[Output]** tab, and then select **[UAB-350]** for **[Select a device for sound output]**.

- The volume control of your computer or the music playback software, etc., is set to mute.
→ Unset mute.

- Your computer does not recognize the headset as a USB device.
→ Restart your computer.

- The CD-ROM drive of your computer does not support the digital play function of WDM.
→ Use a CD-ROM drive that supports the digital play function of WDM.

Sound is disrupted.

- The CPU of your computer is overloaded.
→ Exit other applications.

- Other USB devices are connected to your computer and being used simultaneously.
→ Quit operating other USB devices.

You cannot record sound from the microphone.

- The microphone plug is not connected to the microphone jack.
→ Connect the microphone plug to the microphone jack.
- The MIC MUTING button is set to MUTING mode.
→ Set the MIC MUTING button to OFF.

- The audio recording device of your computer is not set correctly.

→ **For Windows 2000**

Click the **[Start]** menu, and select **[Settings]**, **[Control Panel]**, **[Sounds and Multimedia]**, **[Audio]** tab, and then select **[UAB-350]** for **[Preferred device]** in the **Sound Recording** menu.

→ **For Windows XP**

Click the **[start]** menu, select **[Control Panel]**, **[Sounds, Speech and Audio Devices]**, **[Sounds and Audio Devices]**, **[Audio]** tab, and then select **[UAB-350]** for **[Default device]** in the **Sound recording** menu.

→ **For Windows Vista**

Click the **[Start]** menu, select **[Control Panel]**, **[Hardware and Sound]**, **[Sound]**, **[Recording]** tab, select **[UAB-350]** for the recording device, and then click **[Set Default]**.

→ **For Windows 7**

Click the **[Start]** menu, select **[Control Panel]**, **[Hardware and Sound]**, **[Sound]**, **[Recording]** tab, select **[UAB-350]** for the recording device, and then click **[Set Default]**.

→ **For Macintosh**

Click the **[Apple]** menu, select **[System Preferences]**, **[Sound]**, **[Input]** tab, and then select **[UAB-350]** for **[Select a device for sound input]**.

Recorded sound is low.

- The microphone plug is not connected to the microphone jack properly.
→ Connect the microphone plug properly.

- The VOICE TUBE is not attached.
→ Attach the VOICE TUBE to the headset.

- The volume level of the microphone is set too low on the computer.
→ Increase the volume level of the microphone on the computer.

There is noise in recorded sound.

- There are electrical wires, fluorescent lights or mobile phones near the headset (especially the microphone).
→ Move away from any possible sources of electromagnetic interference.

Recorded sound is distorted.

- The volume level of the microphone is set too high on the computer.
→ Decrease the volume level of the microphone on the computer.

The MIC MUTING button does not work.

- The MUTING mode cannot be unset by the MIC MUTING button, if setting on the computer.
→ Unset mute on the computer.

For details on operation of your computer, refer to the operating instructions of your computer.

Some problems may not be solved even with Troubleshooting. In such cases, contact your nearest Sony dealer.