

# HT-SF360

## Quick Setup Guide 快速設定指南



Sony Corporation © 2009 Printed in Malaysia

### 1: Installing the speakers/ 1: 安裝揚聲器

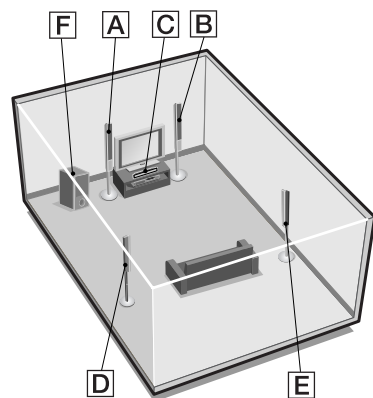

#### English

This Quick Setup Guide describes how to connect a DVD player, satellite tuner or set-top box, TV, Blu-ray disc player, speakers, and a subwoofer so that you can enjoy multi channel surround sound. Refer to the operating instructions supplied with the receiver for details.

The illustrations in the guide designate speakers as **A** through **F**.

- A** Front speaker (left)
- B** Front speaker (right)
- C** Center speaker
- D** Surround speaker (left)
- E** Surround speaker (right)
- F** Subwoofer

### 1: Installing the speakers

The illustrations above show an example of a 5.1 channel speaker system (five speakers and one subwoofer) configuration. Refer to the operating instructions supplied with the receiver.

#### About speaker placement

The center speaker are magnetically shielded to allow it to be installed near a TV set. However, as the front speakers, surround speakers and subwoofer are not magnetically shielded, we recommend that you place them slightly further away from a TV set.

### 2: Connecting the speakers

The illustrations above show how to connect the speakers. Before you connect the speakers, check the speaker label on the rear panel of the speakers for the speaker type. Refer to "2: Connecting the speakers" in the operating instructions supplied with the receiver for details.

### 2: Connecting the speakers/ 2: 連接揚聲器

**A B**

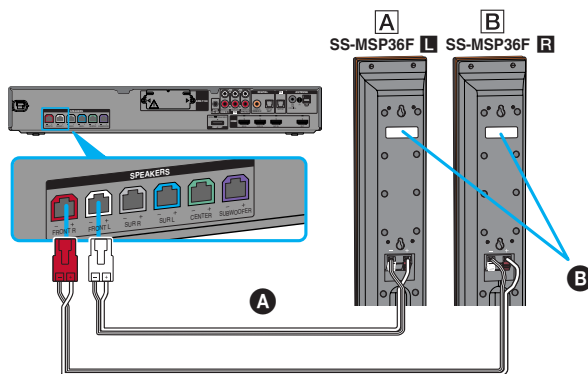

**D E**

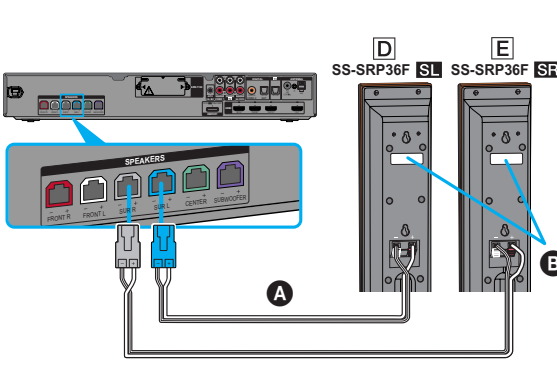

**C**

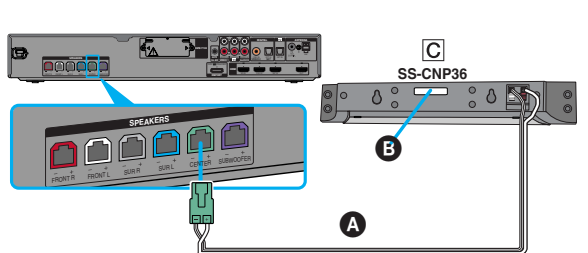

**F**

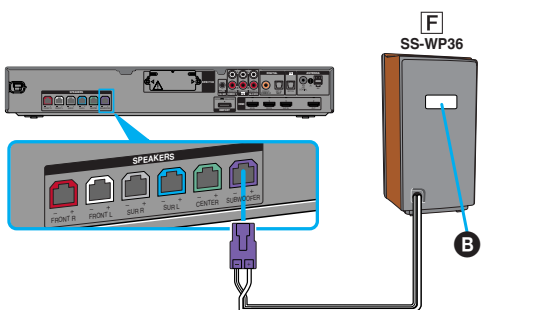

- A** Speaker cord (supplied)/揚聲器線 (附帶)
- B** Speaker label/揚聲器標籤

#### About speaker jacks

- Connect the same color speaker connector to the same color jack of the receiver.
- Refer to the illustration above for details of connecting speaker cords.

### 3: Connecting other components

This is an example of how to connect this receiver and your components. Refer to step 3 and 4 of "Getting started" of the operating instructions supplied with this receiver for details on other connections and other components.

### 4: Connect all power cords last

Connect the AC power cord to a wall outlet. Refer to "Connecting the AC power cord" in the operating instructions supplied with the receiver.

#### 中文

此快速設定指南詳細敘述如何連接 DVD 播放機、衛星調諧器或數碼電視接收器、電視機、藍光影碟播放機、揚聲器與超低音揚聲器，讓您享受多聲道環繞音響的效果。詳情請參閱隨接收機附帶的使用說明書。

指南中的圖示將揚聲器以 **A** 至 **F** 標明。

- A** 前置揚聲器 (左)
- B** 前置揚聲器 (右)
- C** 中置揚聲器
- D** 環繞揚聲器 (左)
- E** 環繞揚聲器 (右)
- F** 超低音揚聲器

### 1: 安裝揚聲器

上圖說明了 5.1 聲道揚聲器系統 (五個揚聲器和一個超低音揚聲器) 配置的一個例子。請參閱隨接收機附帶的使用說明書。

#### 關於揚聲器放置

中置揚聲器已被磁性化屏蔽，以便安裝於電視機附近。然而，由於前置揚聲器、環繞揚聲器和超低音揚聲器並未被磁性化屏蔽，我們建議您將前置揚聲器、環繞揚聲器和超低音揚聲器稍微遠離電視機放置。

### 2: 連接揚聲器

上圖說明如何連接揚聲器。在您連接揚聲器前，請檢查揚聲器背面板上的揚聲器標籤以查看揚聲器類型。詳情請參閱隨接收機附帶使用說明書中的 "2: 連接揚聲器"。

### 3: Connecting other components/ 3: 連接其他組成機

#### Video components/ 視頻組成機

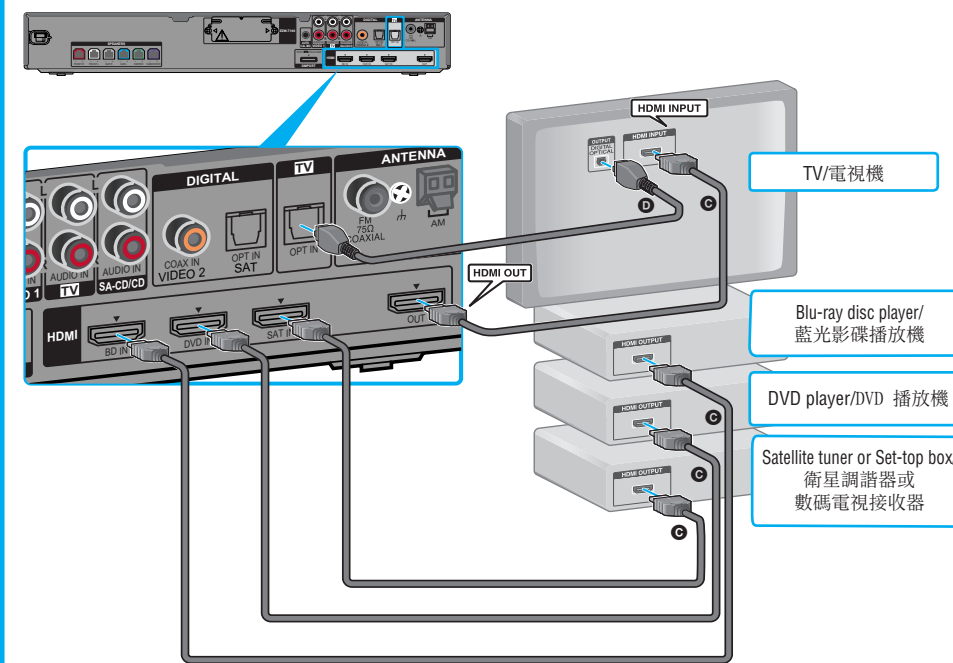

- C** HDMI cable (not supplied)/HDMI 連接線 (無附帶)
- D** Optical digital cord (not supplied)/光纖數位線 (無附帶)

#### 關於揚聲器插孔

- 將相同顏色的揚聲器接頭連接到相同顏色的接收機插孔。
- 關於連接揚聲器線的詳情，請參考上圖。

### 3: 連接其他組成機

此為如何連接本接收機和其他組成機的例子。關於其他連接和其他組成機的詳情，請參閱隨接收機附帶使用說明書中 "準備工作" 的步驟 3 和 4。

### 4: 最後連接所有電源線

將交流電源線連接到牆壁插座。請參閱隨接收機附帶使用說明書中的 "連接交流電源線"。

## 5: Calibrating the speaker settings automatically/

### 5: 自動校準揚聲器設定

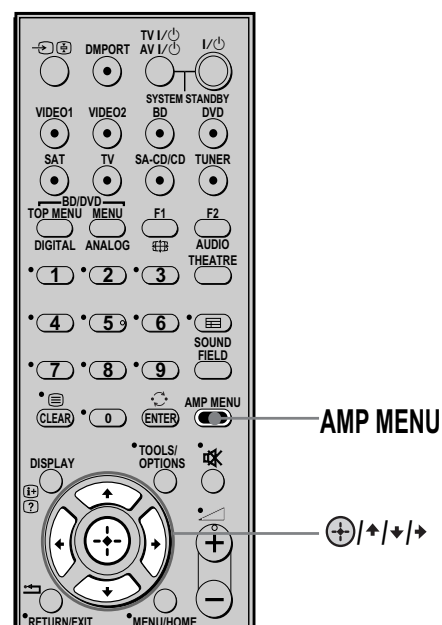
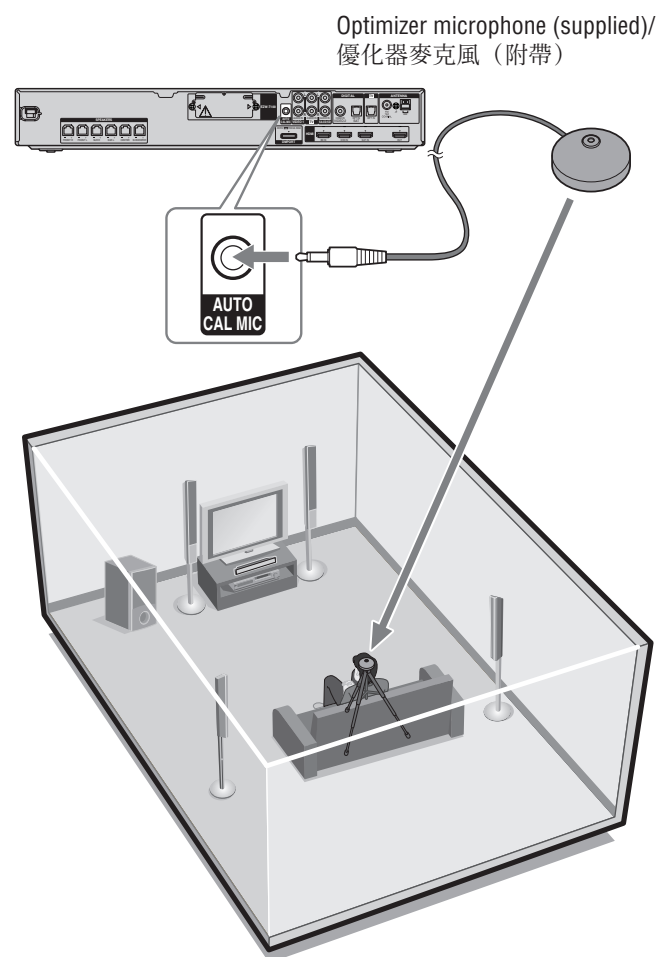

## English

### 5: Calibrating the speaker settings automatically

You can set up the speakers to obtain the sound you want from all connected speakers automatically by using the Auto Calibration function. The Auto Calibration function will:

- Check the connection between each speaker and the receiver.
- Adjust the speaker level.
- Measure the distance of each speaker from your listening position.
- Measure the frequency characteristics.

**1 Connect the supplied optimizer microphone to the AUTO CAL MIC jack on the receiver.**

**2 Set up the optimizer microphone.**

Place the optimizer microphone at your listening position. You can also use a stool or tripod so that the optimizer microphone remains at the same height as your ears.

**3 Press AMP MENU.**

**4 Press  $\uparrow/\downarrow$  repeatedly to select "A.CAL", then press  $\oplus$  or  $\rightarrow$  to enter the menu.**

"START" appears on the display.

**5 Press  $\oplus$  to start measurement.**

The Auto Calibration function starts.

When the measurement ends, a beep sounds and "SAVE" appears on the display.

**6 Press  $\oplus$  on the remote to save the measurement result.**

For details on the Auto Calibration function, refer to step 7 of "Getting started" of the operating instructions supplied with this receiver.

#### Notes

- If there are any obstacles in the path between the optimizer microphone and the speakers, the calibration cannot be performed correctly. Remove any obstacles from the measurement area to avoid measurement error.
- During the calibration, the sound that comes out of the speakers is very loud. Pay attention to the presence of children or to the effect on your neighborhood.
- Perform the Auto Calibration in a quiet environment to avoid the effect of noise and get a more accurate measurement.

## 中文

### 5: 自動校準揚聲器設定

您可以使用自動校準功能設定揚聲器，以自動從所有連接的揚聲器獲得您想要的聲音。自動校準功能將執行以下步驟：

- 檢查每個揚聲器和本接收機之間的連接。
- 調整揚聲器電平。
- 測量每個揚聲器到聆聽位置的距離。
- 測量頻率特徵。

**1 將附帶的優化器麥克風連接到接收機上的 AUTO CAL MIC 插孔。**

**2 設定優化器麥克風。**

將優化器麥克風放置在聆聽位置。您也可以使用凳子或三腳架將優化器麥克風放置到與您耳朵相同高度的位置。

**3 按下 AMP MENU。**

**4 反覆按下  $\uparrow/\downarrow$  以選擇 "A.CAL"，然後按下  $\oplus$  或  $\rightarrow$  以進入選單。**

"START" 出現在顯示屏上。

**5 按下  $\oplus$  以開始測量。**

自動校準功能開始。

當測量結束時，響起嘟嘟聲並且顯示屏上出現 "SAVE"。

**6 按下遙控器上的  $\oplus$  以保存測量結果。**

關於自動校準功能的詳情，請參閱隨接收機附帶使用說明書中 "準備工作" 的步驟 7。

#### 註

- 如果優化器麥克風和揚聲器之間有任何阻礙物，便無法準確進行校準。請移開測量區域內的任何阻礙物，以避免出現測量錯誤的情況。
- 校準時，從揚聲器發出的聲音會十分大聲。請留意是否有兒童在場或是否會影響到鄰居。
- 請於安靜環境下進行自動校準，以避免噪音的影響並獲取更準確的測量。

### 6: Setting up other components

You should set up each component so that the sound is output from the speakers correctly when you play back a connected component. Refer to the operating instructions supplied with each component.

#### After the setting

The receiver is now ready to use. Press the input button on the remote to select the component you want to play back. Refer to the operating instructions supplied with the receiver for details.

### 6: 設定其他組成機

您應該設定每個組成機，以便當您播放連接的組成機時，聲音從揚聲器正確輸出。請參閱隨每個組成機附帶的使用說明書。

#### 設定之後

即可使用接收機。按下遙控器上的輸入按鈕以選擇您要播放的組成機。詳情請參閱隨接收機附帶的使用說明書。