

Portable MiniDisc Player

Operating instructions
Mode d'emploi (au dos)

MZ-E32/E33

Sony Corporation ©1998 Printed in Japan



WARNING

To prevent fire or shock hazard, do not expose the unit to rain or moisture.

To avoid electrical shock, do not open the cabinet. Refer servicing to qualified personnel only.

Caution
The use of optical instruments with this product will increase eye hazard.

Listening for many hours at maximum volume may damage your hearing.

Information

IN NO EVENT SHALL SELLER BE LIABLE FOR ANY DIRECT, INCIDENTAL OR CONSEQUENTIAL DAMAGES OF ANY NATURE, OR LOSSES OR EXPENSES RESULTING FROM ANY DEFECTIVE PRODUCT OR THE USE OF ANY PRODUCT.

*MD WALKMAN® is a trademark of Sony Corporation.

Playing an MD right away!

Prepare one LR6 (size AA) alkaline battery. You can also use this player on a rechargeable battery or house current (see "Power sources"). Playback will switch automatically between stereo and monaural according to the sound source.

1 Insert a battery or a rechargeable battery.

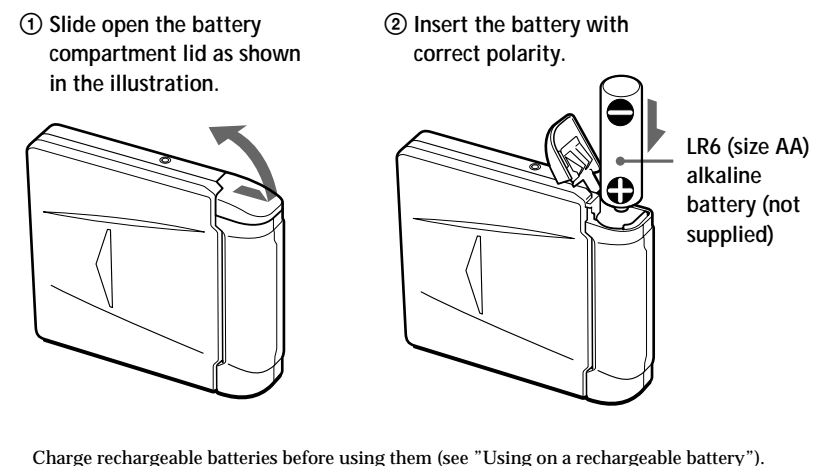

Charge rechargeable batteries before using them (see "Using on a rechargeable battery").

2 Insert an MD.

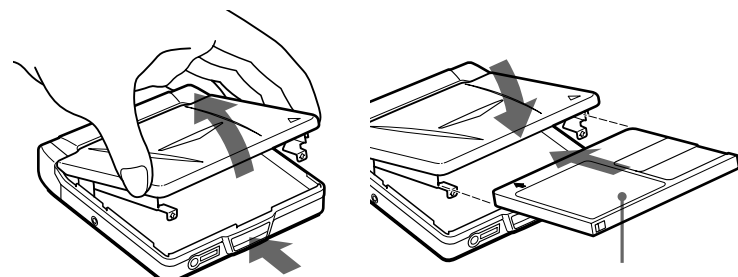

3 Play an MD.

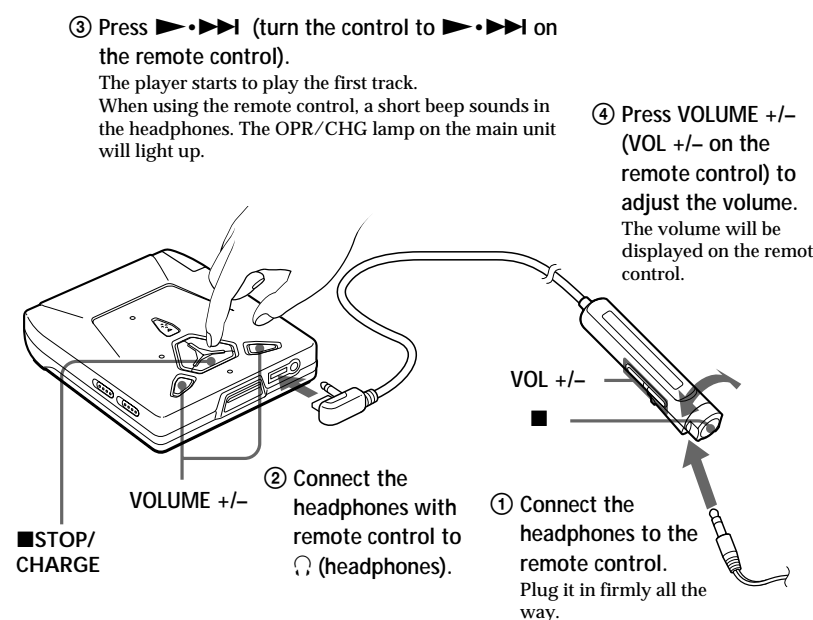

To stop play, press . When using the remote control, a short beep sounds in the headphones. The OPR/CHG lamp on the main unit will go off. The display on the remote control will disappear after a while.

To	Press (Beeps in the headphones)
Pause	on the remote control (Continuous short beeps) Press again to resume play.
Find the beginning of the current track	or turn the control to on the remote control once (Three short beeps)
Find the beginning of the next track	or turn the control to on the remote control once (Two short beeps)
Go backwards while playing ¹⁾	keep pressing or keep the control turned to on the remote control
Go forward while playing ²⁾	keep pressing or keep the control turned to on the remote control
Remove the MD	and push OPEN to open the lid. ³⁾

When using the headphones
Wear the "L" marked side to the left ear and the "R" marked side to the right ear.

If playback does not start
Make sure the player is not locked. See "To lock the controls."

Display window while playing back

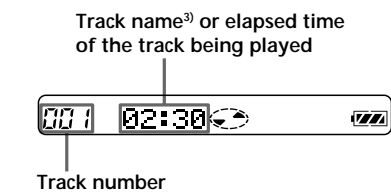

Tips
• The OPR/CHG lamp will light up on the main unit during playback. It will go off when is pressed.
• The display on the remote control will disappear after a few seconds after you have pressed .

Note
Do not push OPEN during playback. If you do, the lid opens and playback will stop.

When using optional headphones
Use the headphones that have stereo-miniplug. You cannot use other types of headphones (microplug).

- If you press or during pause, the player will resume playback. If you keep pressing or during pause (keep the control turned to or on the remote control), you can fast forward/rewind without listening to the playback sound.
- Once you open the lid, the point to start play will change to the beginning of the first track.
- Appears only with MDs that have been electronically labeled.

▶ Various ways of playback

Playing tracks repeatedly

You can play tracks repeatedly in three ways — all repeat, single repeat, and shuffle repeat.

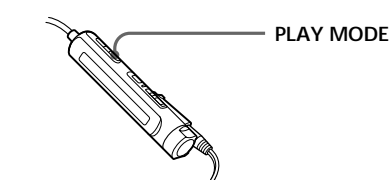

Press PLAY MODE while the player is playing an MD. Each time you press PLAY MODE, the play mode indication changes as follows.

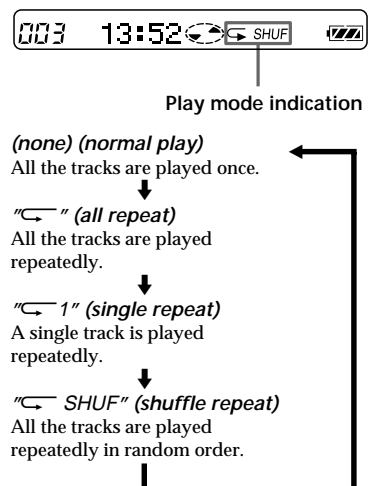

Tips on playback

To know the track name and time
Press DISPLAY on the remote control while the player is playing an MD.

Each time you press DISPLAY, the display changes as follows.

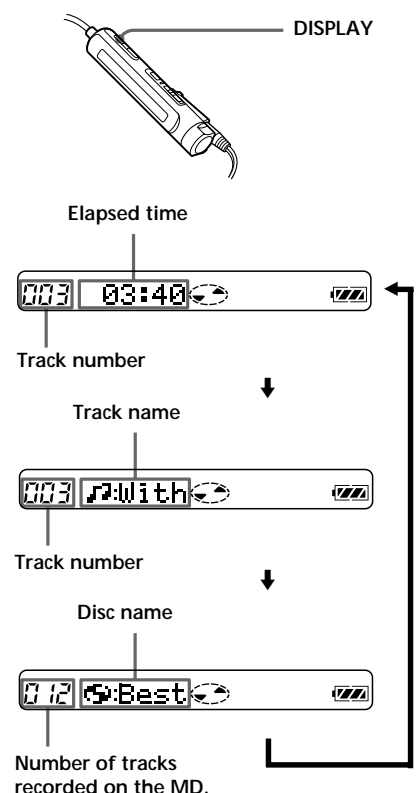

Note
Disc and track names appear only with MDs that have been electronically labeled.

To lock the controls (HOLD)
To prevent the buttons from being accidentally operated when you carry the player, use this function.

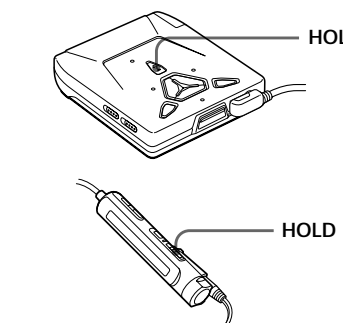

Slide the HOLD switch on the main unit in the direction of the to lock the controls of the unit. Slide the HOLD switch on the remote control in the direction of the to lock the controls of the remote control.

To emphasize bass (DIGITAL MEGA BASS)
The DIGITAL MEGA BASS function intensifies low frequency sound for richer quality audio reproduction.

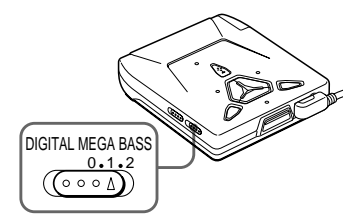

Slide DIGITAL MEGA BASS. Choose 1 (slight effect) or 2 (strong effect). To cancel the effect, set DIGITAL MEGA BASS to 0.

Note
If the sound becomes distorted when emphasizing bass, turn down the volume.

To protect your hearing (AVLS)
The AVLS (Automatic Volume Limiter System) function keeps down the maximum volume to protect your ears.

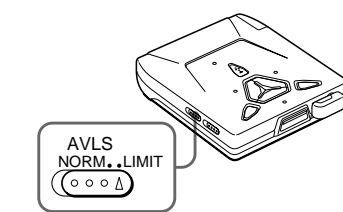

Set AVLS to LIMIT. The volume is kept to a moderate level, even if you try to turn the volume above the limited level.

▶ Power sources

When to replace or charge the batteries

You can check the battery condition with the battery indication, which is displayed while using the player.

- Battery power decreasing
- Weak batteries. Replace/recharge the batteries

The batteries have gone out. "LoBATT" flashes in the display of the remote control, and the power goes off.

Battery life*

Batteries	Playback
LR6 (SG) (size AA) Sony alkaline battery	Approx. 9.5 hours
R-6 sized Ni-MH rechargeable battery NH-MDAA	Approx. 8 hours
Chewing gum type Ni-MH rechargeable battery NH-14WM	Approx. 7 hours
Chewing gum type Ni-MH rechargeable battery NH-9WM(N)	Approx. 6.5 hours

* The battery life may be shorter due to operating conditions and the temperature of the location.

Using on a rechargeable battery

1 Plug the AC power adaptor AC-E30HG (not supplied) to the wall outlet, then to the DC IN 3V jack.

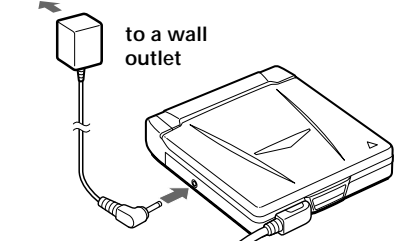

to DC IN 3V

2 Insert the R6-sized rechargeable battery NH-MDAA*, or a chewing-gum type rechargeable battery NH-9WM or NH-14WM (not supplied) in the battery compartment.
* NH-MDAA may not be available in some areas.

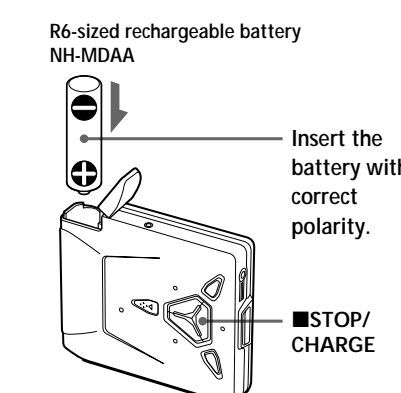

You cannot charge other R-6 sized rechargeable batteries than the NH-MDAA on this unit.

3 Press . The OPR/CHG lamp flashes on the main unit. "Charge" flashes and the indication appears on the remote control. Charging starts.

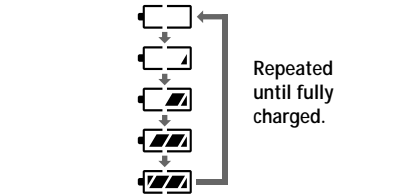

Disappears when fully charged.

Full charging of a completely discharged battery takes about 3 hours. To cancel charging, press again.

4 Disconnect the AC power adaptor at both ends. The player will not switch to battery power while the AC power adaptor is plugged into the DC IN 3V jack.

Notes
• You cannot charge a rechargeable battery on the player while playing back.
• Use only the recommended rechargeable batteries. You may not be able to charge other rechargeable batteries.

Using on house current

Before using the player, remove the rechargeable battery if it is installed.

1 Connect the AC power adaptor AC-E30HG (not supplied) to the DC IN 3V jack of the player.

2 Connect the AC power adaptor to a wall outlet.

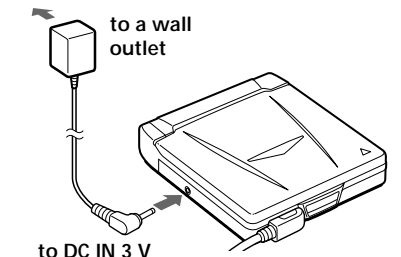

Note
The battery indication mark is displayed when the AC power adaptor is being used.

▶ Additional information

Precautions

- On safety**
 - Do not put any foreign objects in the DC IN 3V jack.
- On power sources**
 - For use in your house: Use the AC power adaptor AC-E30HG (not supplied). Do not use any other AC power adaptor since it may cause the player to malfunction.

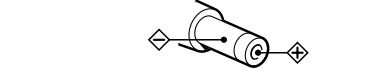

- Polarity of the plug**
 - The player is not disconnected from the AC power source (mains) as long as it is connected to the wall outlet, even if the player itself has been turned off.
 - If you are not going to use this player for a long time, be sure to disconnect the power supply (AC power adaptor, dry battery, or rechargeable battery). To remove the AC power adaptor from the wall outlet, grasp the adaptor plug itself; never pull the cord.

On rechargeable batteries

- When charging the rechargeable battery, be sure to use the AC-E30HG AC power adaptor (not supplied). Do not use any other AC power adaptor.
- Charging time may vary depending on the battery condition.
- When you use the battery for the first time or after a long period of disuse, the battery life may be shorter. In this case, charge and discharge the battery several times. The battery life will be restored.
- If the rechargeable battery capacity becomes half the normal life, replace it with a new one.
- When carrying the rechargeable battery, be sure to put it in the battery carrying case (not supplied). Carrying it exposed in your pocket or a bag, etc., with metallic objects such as key rings is dangerous, as it may cause a short-circuit.
- Recharge the rechargeable battery when the unit is not to be used for a long time.
- Use only the recommended rechargeable batteries. You may not be able to charge other rechargeable batteries.

On heat build-up
• Heat may build up in the player if it is used for an extended period of time. In this case, leave the player to cool down.

- On installation**
 - Never use the player where it will be subjected to extremes of light, temperature, moisture or vibration.
 - Never wrap the player in anything when it is being used with the AC power adaptor. Heat build-up in the player may cause malfunction or injury.

On the headphones

Road safety
Do not use headphones while driving, cycling, or operating any motorized vehicle. It may create a traffic hazard and is illegal in many areas. It can also be potentially dangerous to play your player at high volume while walking, especially at pedestrian crossings. You should exercise extreme caution or discontinue use in potentially hazardous situations.

Preventing hearing damage
Avoid using headphones at high volume. Hearing experts advise against continuous, loud and extended play. If you experience a ringing in your ears, reduce the volume or discontinue use.

Caring for others
Keep the volume at a moderate level. This will allow you to hear outside sounds and to be considerate to the people around you.

- On the MiniDisc cartridge**
 - Do not break open the shutter.
 - Do not place the cartridge where it will be subject to light, temperature, moisture or dust.

- On cleaning**
 - Clean the player casing with a soft cloth slightly moistened with water or a mild detergent solution. Do not use any type of abrasive pad, scouring powder or solvent such as alcohol or benzene as it may mar the finish of the casing.
 - Wipe the disc cartridge with a dry cloth to remove dirt.
 - Dust on the lens may prevent the unit from operating properly. Be sure to close the disc compartment lid after inserting or ejecting an MD.

On dry batteries and the battery carrying case
Incorrect battery usage may lead to leakage of battery fluid or bursting batteries. To prevent such accidents, observe the following precautions:

- Install batteries with the + and - poles aligned correctly.
- When the player is not to be used for a long time, be sure to remove the batteries.
- If a battery leak should develop, carefully and thoroughly wipe away battery fluid from the battery compartment before inserting new ones.
- Do not carry the dry battery in your pocket or a bag, etc., with metallic objects such as key rings. The terminals of the battery or the battery carrying case may heat up from a short-circuit and can be dangerous.

Note on mechanical noise
The player gives out mechanical noise while operating, which is caused by the power-saving system of the player and is not a malfunction.

If you have any questions or problems concerning your player, please consult your nearest Sony dealer.

Troubleshooting

Should any problem persist after you have made these checks, consult your nearest Sony dealer.

The player does not work or works poorly.

- You tried to play with no disc in the player ("No DISC" flashes).
 - Insert an MD.
 - The player is locked.
 - Slide HOLD against the arrow to unlock the player.
 - Moisture has condensed inside the player.
 - Take the MD out and leave the player in a warm place for several hours until the moisture evaporates.
- The rechargeable battery or dry battery is weak ("LoBATT" flashes).
 - Replace the dry battery or recharge the battery.
 - The rechargeable battery or dry battery have been installed incorrectly.
 - Install the battery correctly.
 - An MD with no recording on it is inserted ("BLANK" flashes).
 - Insert a recorded MD.
 - The player cannot read the disc (it's scratched or dirty) ("ERROR" flashes on the remote control).
 - Reinsert or replace the disc.
 - While operating, the player received a mechanical shock, too much static, abnormal power voltage caused by lightning, etc.
 - Restart the operation as follows.
 - Disconnect all the power sources.
 - Leave the player for about 30 seconds.
 - Connect the power source.

The MD is not played normally.
• The player is set to the repeat mode ("") is displayed).
• Press PLAY MODE repeatedly until disappears, then start playing.

An MD is not played from the first track.
• Disc playing stopped before it came to the last track.
• Press repeatedly or eject and reinsert the MD once to go back to the beginning of the disc, and restart playing after checking the track number in the display.

Playback sound skips.
• The player is placed where it receives continuous vibration.
• Put the player on a stable place.
• A very short track may cause sound to skip.

Sound has a lot of static.
• Strong magnetism from a television or such device is interfering with operation.
• Move the player away from the source of strong magnetism.

No sound comes through the headphones.

- The headphones plug is not firmly connected.
 - Connect the headphones plug firmly to the remote control. Then connect the remote control plug firmly to the (headphones) jack.
- Volume is too low.
 - Adjust the volume by pressing VOLUME +/- (VOL +/- on the remote control).
- AVLS is on.
 - Slide AVLS to NORM.

Specifications

System
Audio playing system
MiniDisc digital audio system
Laser diode properties
Material: GaAlAs
Wavelength: $\lambda = 790 \text{ nm}$
Emission duration: continuous
Laser output: less than $44.6 \mu\text{W}$
* This output is the value measured at a distance of 200 mm from the objective lens surface on the optical pick-up block with 7mm aperture.

Revolutions
400 rpm to 900 rpm (CLV)
Error correction
Advanced Cross Interleave Reed Solomon Code (ACIRC)
Sampling frequency
44.1 kHz
Coding
Adaptive Transform Acoustic Coding (ATRAC)
Modulation system
EFM (Eight to Fourteen Modulation)
Number of channels
2 stereo channels
Frequency response
20 to 20,000 Hz $\pm 3 \text{ dB}$
Wow and Flutter
Below measurable limit
Outputs
Headphones: stereo mini-jack, maximum output level 5 mW + 5 mW, load impedance 16 ohm

General
Power requirements
One LR6 (size AA) battery (not supplied)
Ni-MH rechargeable battery NH-9WM/NH-14WM (not supplied)
R-6 sized Ni-MH rechargeable battery NH-MDAA (not supplied)
Sony AC power adaptor ¹⁾ (not supplied) connected at the DC IN 3 V jack
Battery operation time
See "When to replace or charge the batteries"
Dimensions
Approx. 80 × 17.3 × 92 mm (w/h/d) (3 1/4 × 1 1/16 × 3 7/8 in.) not including projecting parts and controls
Mass
Approx. 113 g (4.0 oz.) the player only
Approx. 155 g (5.5 oz.) incl. a premastered MD and a Sony alkaline LR6 (SG) battery
Supplied accessories
Headphones with a remote control (1)
Carrying pouch (1) (E33 only)

Optional accessories
AC power adaptor AC-E30HG
Chewing-gum type Ni-MH rechargeable battery NH-9WM, NH-14WM
R-6 sized Ni-MH rechargeable battery NH-MDAA
MDR-series Stereo Headphones ²⁾
SRS-A41 Sony Active Speakers
CK-MD4 MiniDisc Carrying Case
CK-MD10 MiniDisc Filing Box

1) The operative voltage for the AC power adaptor varies depending upon the country in which it is sold. Therefore, purchase the AC power adaptor in the country you intend to use it.

2) Whether you should plug the headphones directly to (headphones) on the main unit or to a remote control, use only headphones with stereo mini plugs.

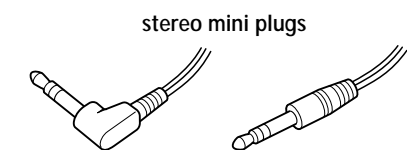

Your dealer may not handle some of the above listed accessories. Please ask the dealer for detailed information about the accessories in your country.

US and foreign patents licensed from Dolby Laboratories Licensing Corporation.

Design and specifications are subject to change without notice.

