

# **Trinitron<sup>®</sup> Color TV**

---

Operating Instructions \_\_\_\_\_ **EN**

#### \_\_\_\_\_ **C1**

#### \_\_\_\_\_ **C2**

*KV-J25*  
*KV-J29*

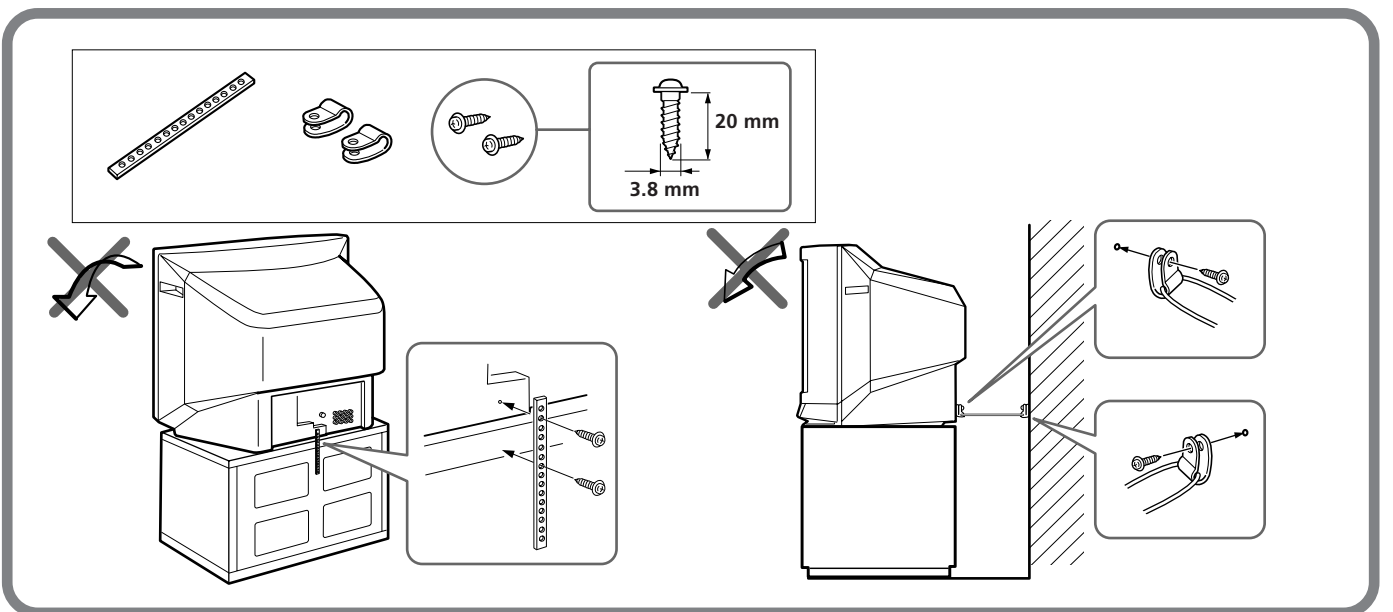
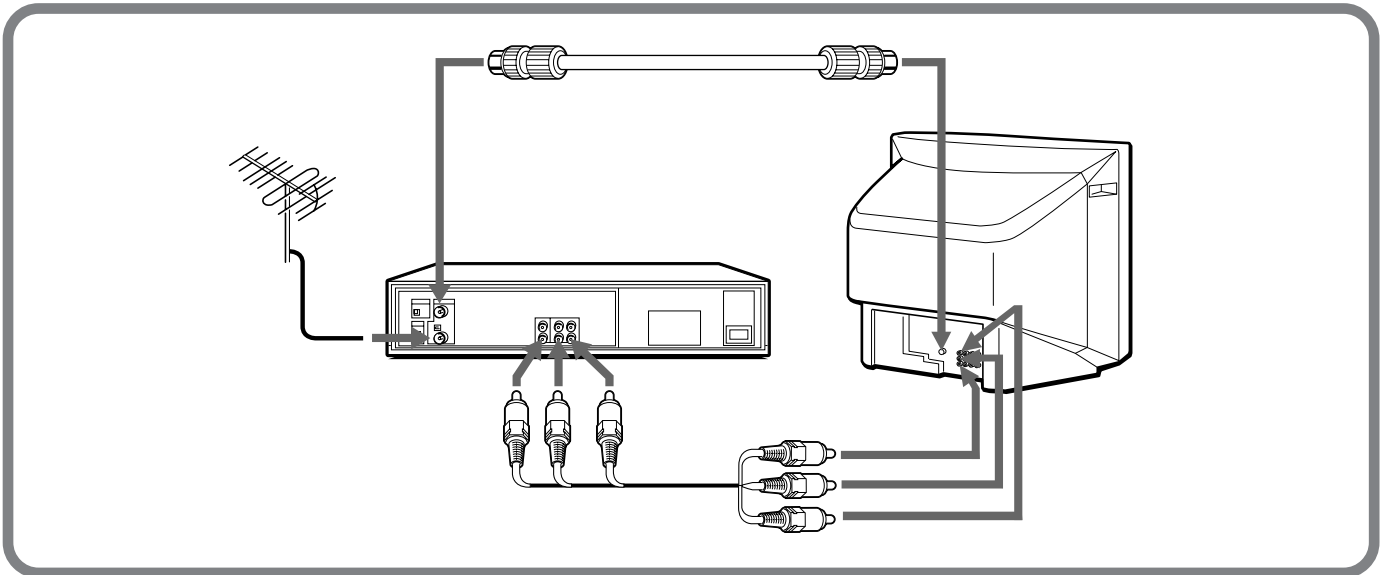
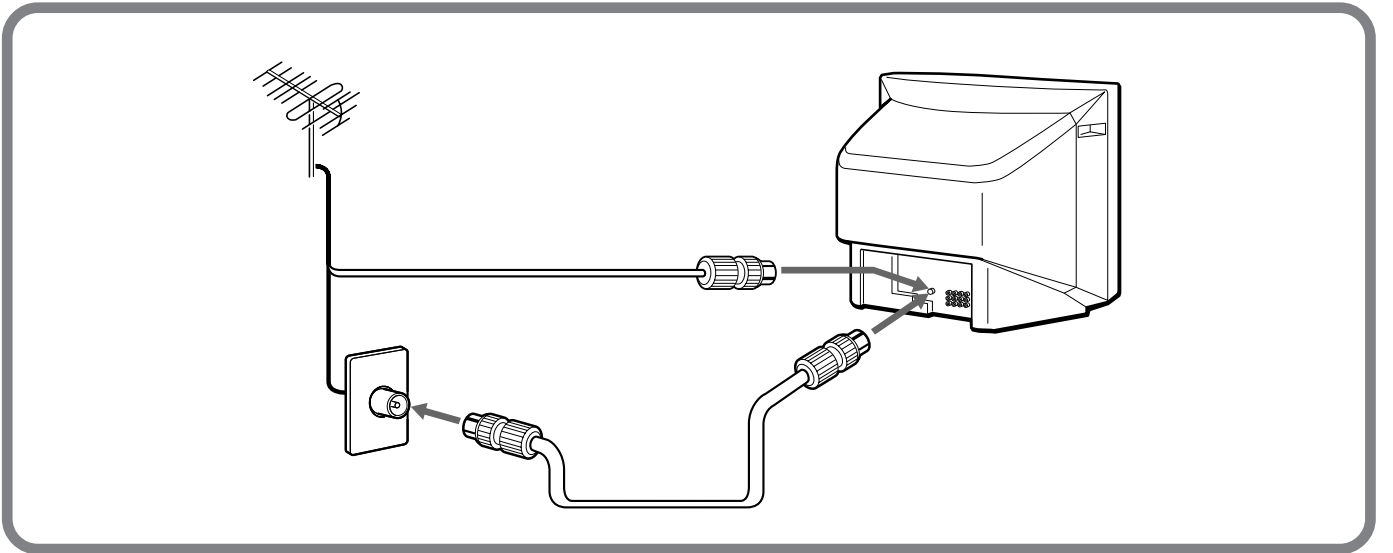

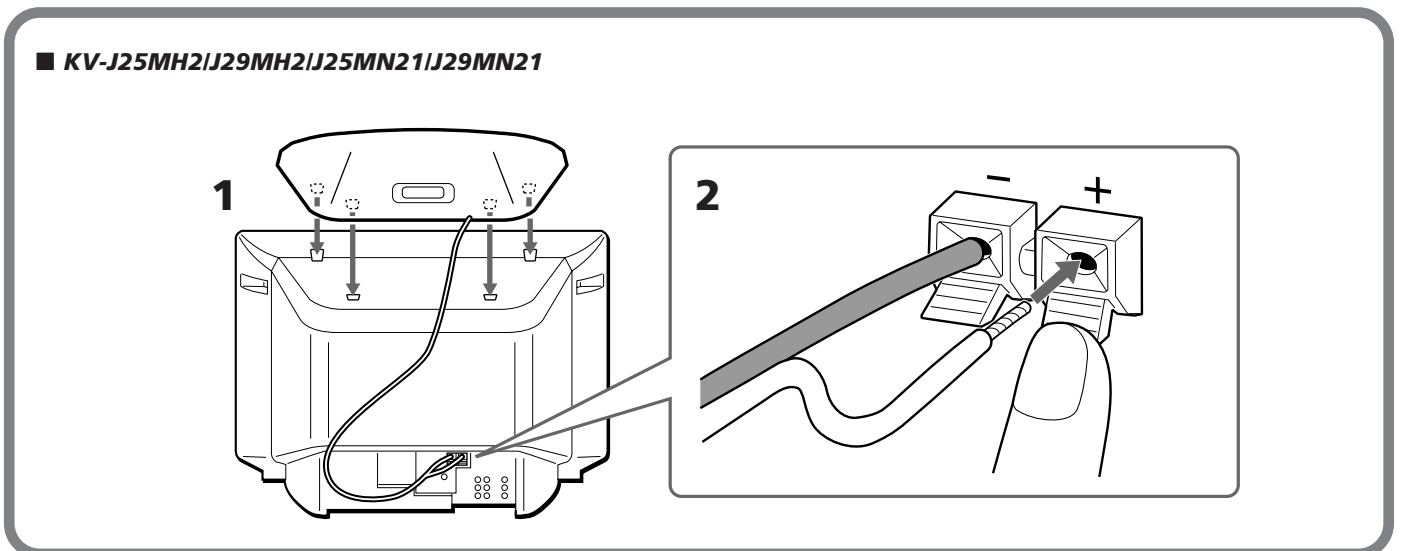
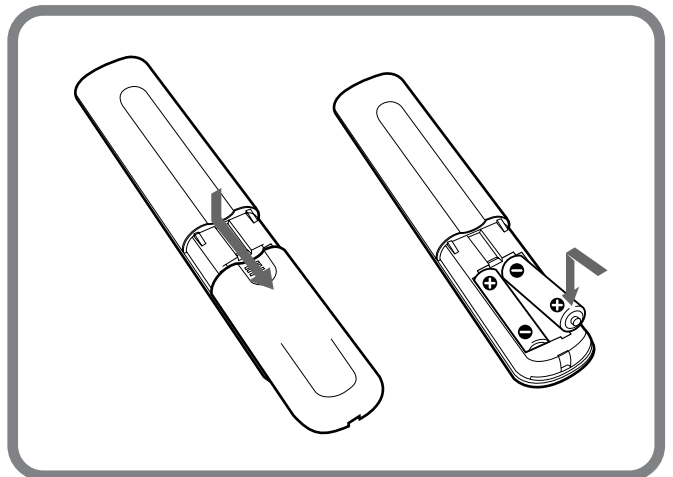
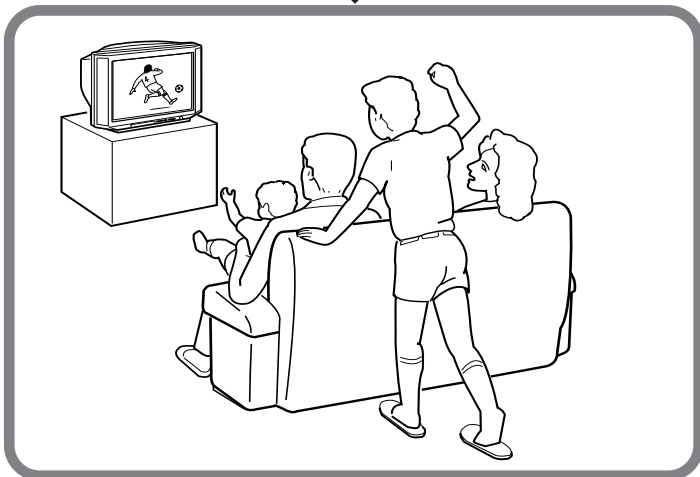
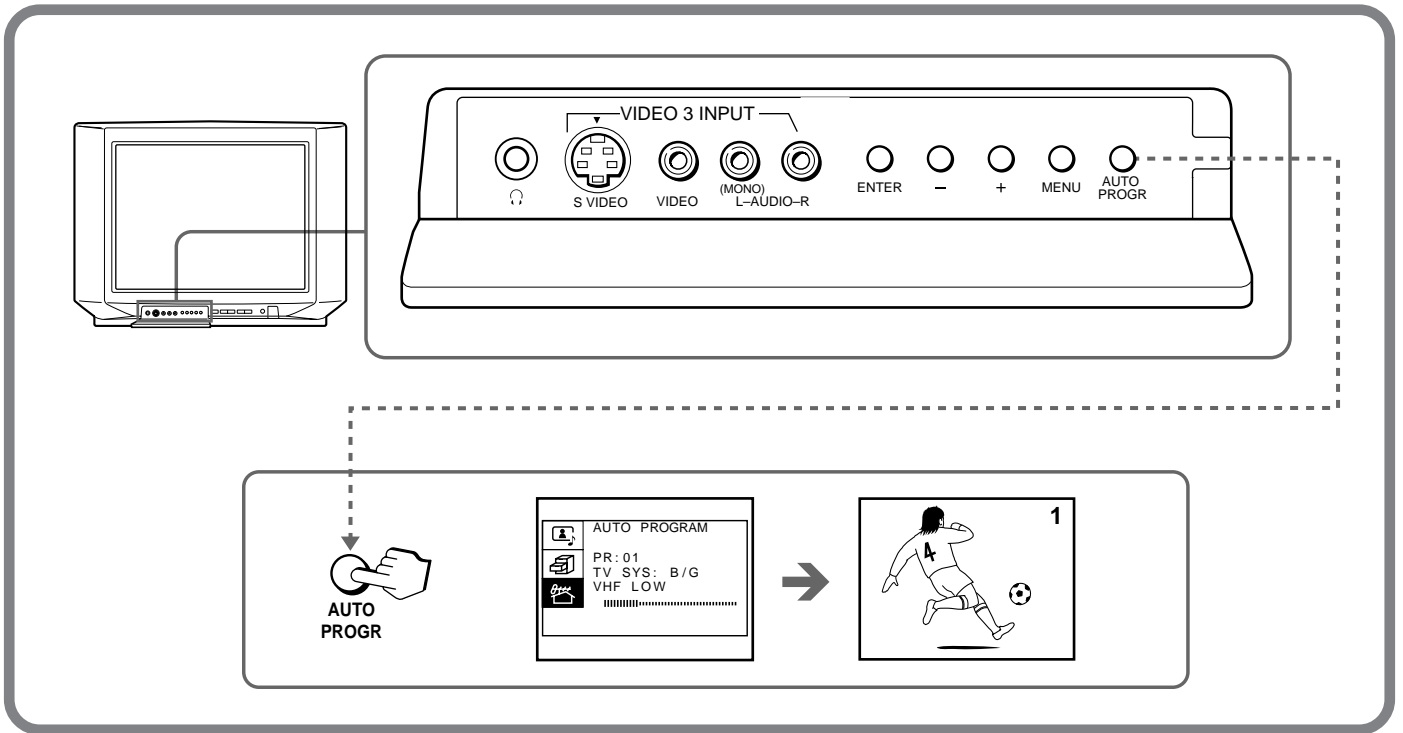

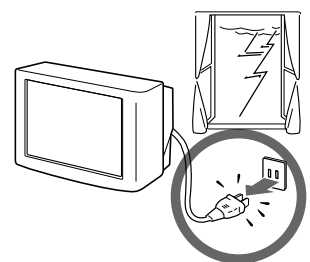
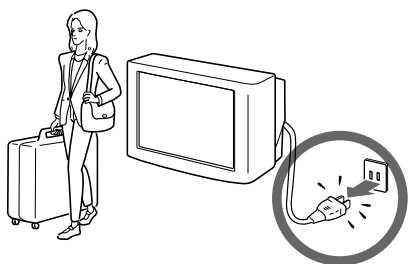
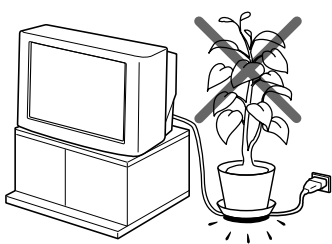
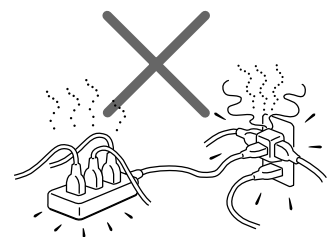
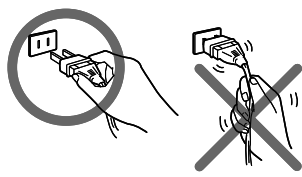
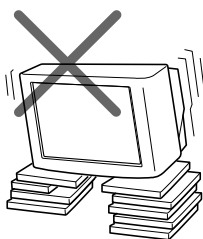
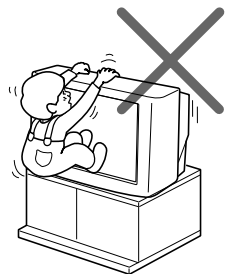
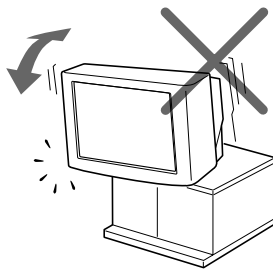
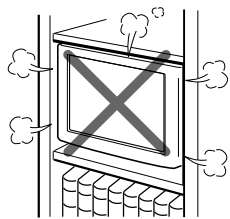
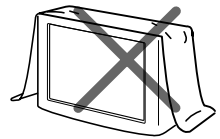
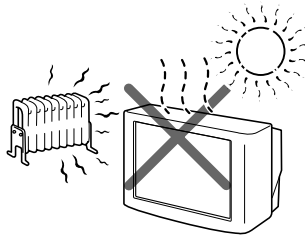
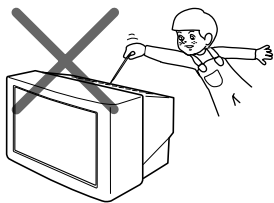
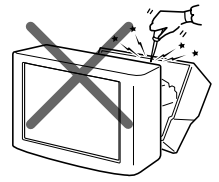
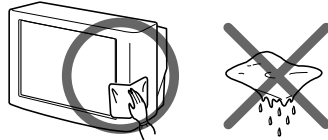
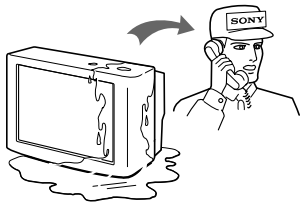
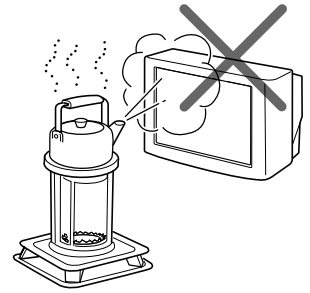
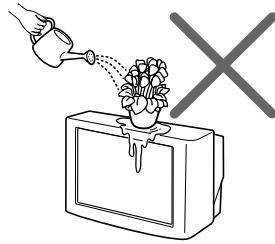
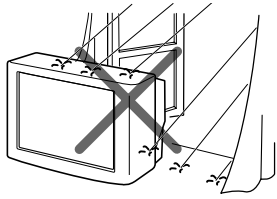

# WARNING

- Dangerously high voltages are present inside the TV.
- Operate the TV only at 110-240 V AC.
- Do not open the cabinet and the rear cover of the TV. Refer servicing to qualified personnel.
- To prevent fire or shock hazard, do not expose the TV to rain or moisture.
- Do not operate the TV if any liquid or solid object falls into it. Have it checked immediately by qualified personnel only.
- Do not block the ventilation openings.
- Do not install the appliance in a confined space, such as a bookcase or built-in cabinet.
- Do not install the TV in hot, humid or excessively dusty places.
- Do not install the TV where it may be exposed to mechanical vibrations.
- Do not keep the TV plugged in if you are not going to use it for several days.
- Do not pull the power cord to disconnect the TV. Pull it out by the plug.
- Use only the supplied screws (as shown on page 2) to fasten the TV to the TV stand or to stabilize the TV against a wall or a pillar. Use of other screws may damage the TV.

## Note on the TV Illustrations

- The TV illustrations of the KV-J25MF1/J29MF1 models have been used for the illustration purposes in this manual. Any difference in operations between models is clearly indicated in the text for example, "KV-J25MH2/J29MH2/J25MN21/J29MN21 only."

## Note on the remote commander

- The supplied remote commander is used on several models of the TV. If you do not find instructions for some controls that are on the remote commander, that means your TV does not employ the features of those controls, e.g. TEXT.

## Notes

- When you turn on the TV, you may hear the "boon" sound that is caused by the demagnetization of the TV. This does not indicate a malfunction.
- The picture color may become abnormal if you change the direction of your TV. To obtain the normal picture color, press POWER on the TV to turn off the TV for five minutes and then turn it on again.

# Table of contents

---

## Getting Started

- 6 Connections
- 8 Introducing the menus
- 9 Changing the menu language
- 10 Presetting channels

---

## Operations

- 12 Watching the TV
- 15 Adjusting the picture and sound
- 17 Listening to the woofer sound (3D WOOFER)
- 18 Listening to the surround sound (SURROUND)
- 19 Selecting a stereo or bilingual program
- 20 Viewing Teletext
- 22 Customizing the TV

---

## Additional Information

- 23 Troubleshooting
- Back Specifications cover

All contents are subject to change without notice. Design and specifications are subject to change without notice.

# Connections

## Connecting the 3D WOOFER

■ *KV-J25MH2/IJ29MH2/IJ25MN21/IJ29MN21 only*

- 1 Attach the 3D WOOFER into the footholds on the top of the TV.**
- 2 Connect the wires to the 3D WOOFER (8Ω) terminals at the rear of the TV.**  
The red wire should be connected to the ⊕ red terminal and the black wire to the ⊖ black terminal.

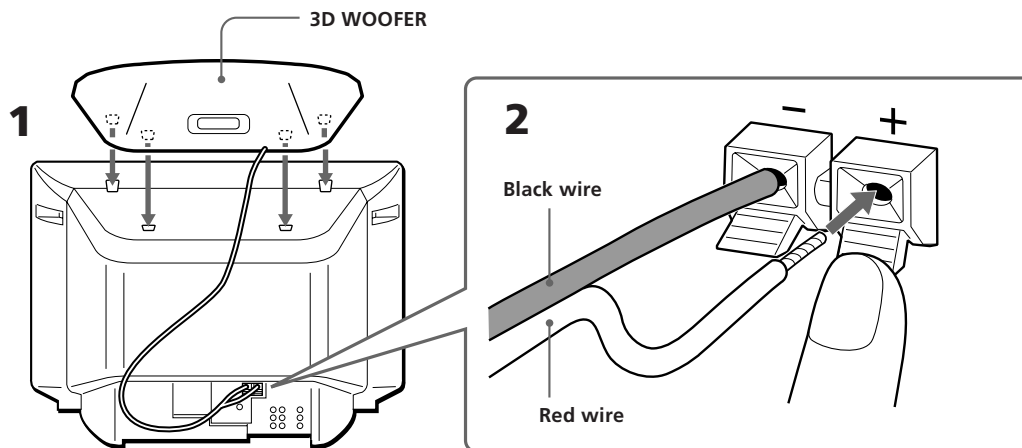

### Notes

- Connect only the supplied 3D WOOFER; otherwise the TV may malfunction.
- Unplug the TV from the wall outlet when connecting the 3D WOOFER.
- Make sure that none of the 3D WOOFER wire strands stick out, making contact with the neighbouring speaker terminal, to prevent a malfunction caused by a short circuit of the terminals.

## Connecting a VHF antenna or a combination VHF/UHF antenna — 75-ohm coaxial cable (round)

Attach an optional IEC antenna connector to the 75-ohm coaxial cable. Plug the connector into the  $\Upsilon$  (antenna) socket at the rear of the TV.

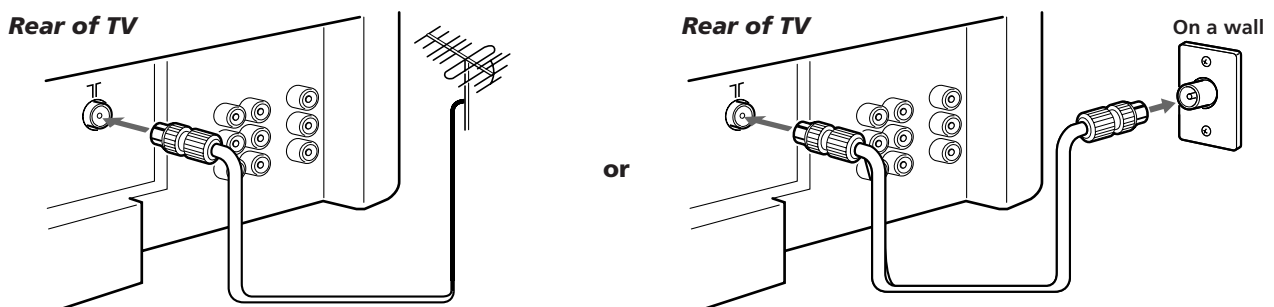

## Connecting optional equipment

You can connect optional audio/video equipment to your TV such as a VCR, multi disc player, camcorder, video game, or stereo system.

### Connecting video equipment using video input jacks

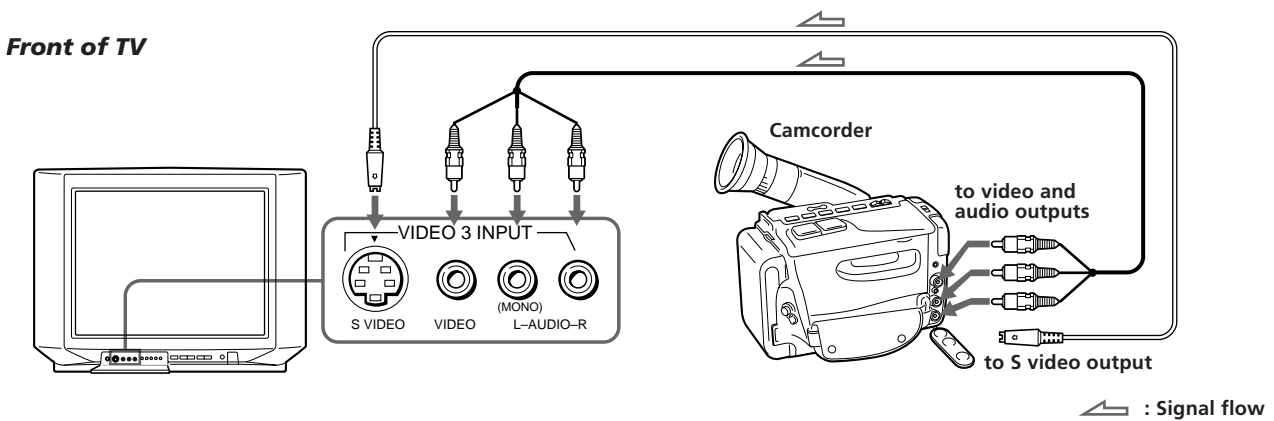
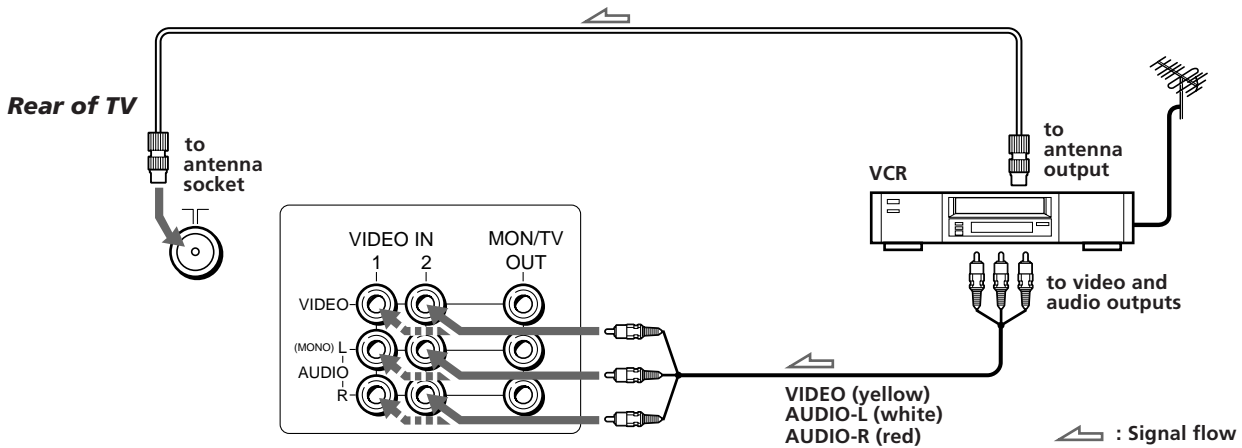

#### When connecting a monaural VCR

Connect the yellow plug to VIDEO and the black plug to AUDIO-L (MONO).

#### When connecting a VCR to the $\Pi$ (antenna) terminal

Preset the signal output from the VCR to the program position 0.

#### If both S Video and video signals are input simultaneously

The S Video input signal is selected. To view a video input signal, disconnect the S Video connection.

#### Note on the video input

When no signal is input, the screen becomes blue.

### Connecting audio/video equipment using MON/TV OUT jacks

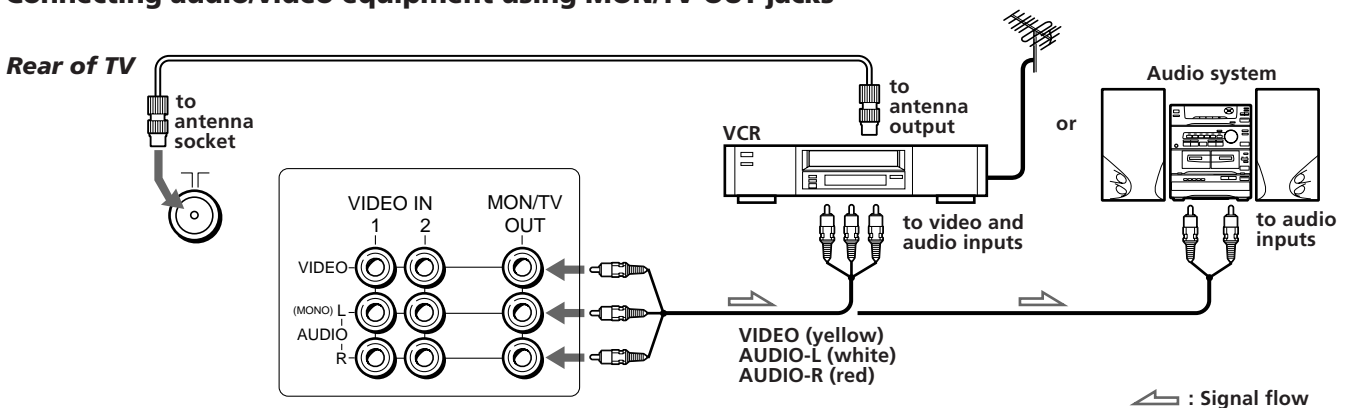

# Introducing the menus

You can preset TV channels, adjust the picture and sound qualities, and select some settings using the on-screen menus. You can use the buttons on both the remote commander and the TV to operate the menus.

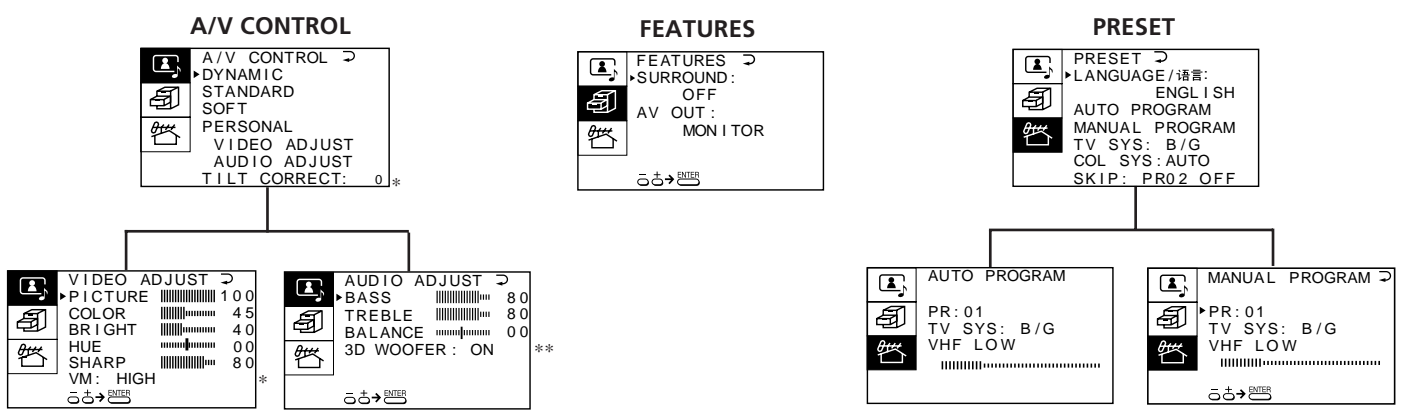

(\*KV-J29MF1/J29MF1S/J29MH2/J29MN21 only)  
(\*\*KV-J25MH2/J29MH2/J25MN21/J29MN21 only)

## Getting back to the previous menu (except for AUTO PROGRAM)

Press + or - to move the cursor (▶) to the first line (▸) of each menu, and press ENTER.

## Cancelling the menu screen

Press MENU.

## Notes (except for AUTO PROGRAM)

- When a menu is selected after pressing ENTER, the color of both the menu and the menu symbol change and the cursor (▶) appears beside the first item of the menu.
- When an item on the menu is selected after pressing ENTER, the color of the item changes.
- You can refer to the guide (◀▶→ENTER) at the bottom of the menus (except for the A/V CONTROL and PRESET menus) for the basic operations of the menu.
- If more than approximately 60 seconds elapse after you press a button, the menu screen disappears automatically.



# Changing the menu language

If you prefer Chinese to English, you can change the menu language. You can use buttons on the remote commander or the TV.

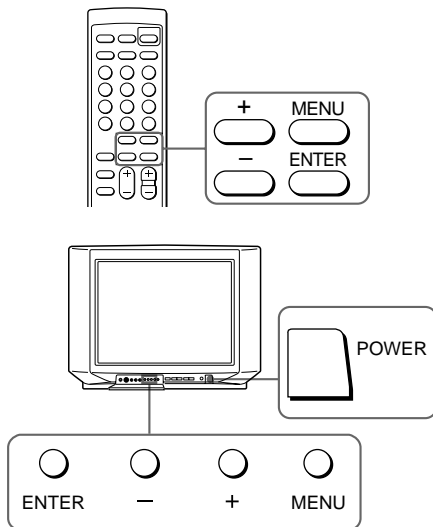

**1 Press POWER to turn on the TV.**

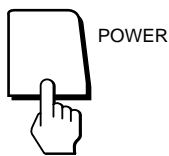

**2 Press MENU.**

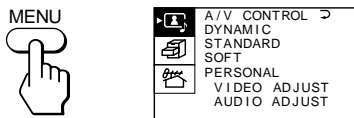

**3 Press + or - to move the cursor (▶) to the PRESET menu (🏠), and press ENTER.**

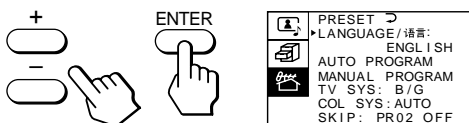

**4 Make sure the cursor (▶) appears beside LANGUAGE/ ###, and press ENTER.**

**5 Press + or - to select ###, and press ENTER.**

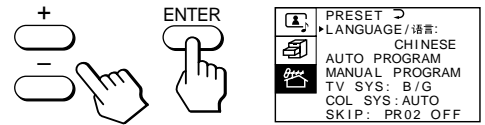

All of the menus change to Chinese.

**6 Press MENU to return to the normal screen.**

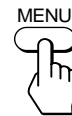

# Presetting channels

You can preset TV channels easily by storing all the receivable channels automatically. You can also preset channels manually or disable program positions (see page 11).

## Presetting channels automatically

You can preset up to 100 TV channels in numerical sequence from the program position 1. You can preset channels automatically using the button on the TV or the menu.

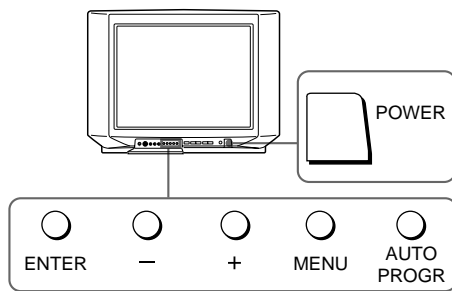

### 1 Press POWER to turn on the TV.

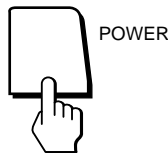

### 2 Press AUTO PROGR.

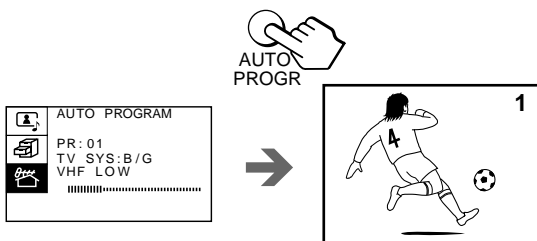

The TV starts scanning and presetting channels automatically. When all of the receivable channels are stored, the first preset TV program appears on the screen.

## To preset channels automatically using the menu

- 1 Press **MENU**.
- 2 Press **+** or **-** to move the cursor (▶) to the **PRESET** menu (📺), and press **ENTER**.
- 3 Press **+** or **-** to move the cursor (▶) to **AUTO PROGRAM**, and press **ENTER**.

## Presetting channels manually

To change the program position for a channel or to receive a channel with a weak signal which you cannot receive by automatic presetting, preset the channel manually.

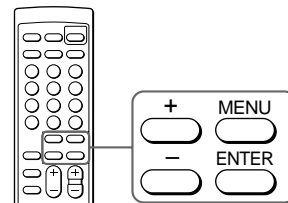

### 1 Press MENU.

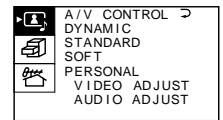

### 2 Press + or - to move the cursor (▶) to the PRESET menu (📺), and press ENTER.

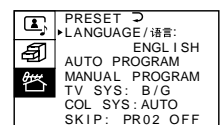
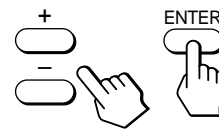

### 3 Select your local TV system.

- (1) Press **+** or **-** to move the cursor (▶) to **TV SYS**, and press **ENTER**.
- (2) Press **+** or **-** until your local TV system appears on the menu, and press **ENTER**.

### 4 Press + or - to move the cursor (▶) to MANUAL PROGRAM, and press ENTER.

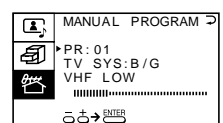
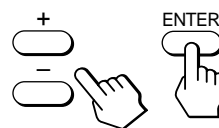

## 5 Select the program position to which you want to preset a channel.

- (1) Make sure the cursor (▶) appears beside PR, and press ENTER.
- (2) Press + or – until the program position you want appears on the menu, and press ENTER.

## 6 Select the desired channel.

- (1) Press + or – to move the cursor (▶) to VHF LOW, and press ENTER.
- (2) Press + or – until the desired channel picture appears on the TV screen, and press ENTER.

## 7 Press MENU to return to the normal screen.

### If the TV system is not properly selected

The picture color may be poor and/or the sound may be noisy. In this case, select the appropriate TV system.

- 1 Press PROGR +/- or the number buttons to select the program position.
- 2 Display the PRESET menu.
- 3 Press + or – to move the cursor (▶) to TV SYS, and press ENTER.
- 4 Press + or – until the appropriate TV system appears, and press ENTER.

### Notes

- The TV system setting is memorized for each program position.
- If you do not know your local TV system, consult your nearest Sony dealer or authorized service center.

---

## Disabling program positions

By disabling unused or unwanted program positions, you can skip those positions when you press PROGR +/-.

### 1 Press MENU.

### 2 Press + or – to move the cursor (▶) to the PRESET menu ( ), and press ENTER.

### 3 Press + or – to move the cursor (▶) to SKIP, and press ENTER.

### 4 Press + or – until the unused or unwanted program position appears on the menu, and press ENTER.

### 5 Press + or – to select ON, and press ENTER.

### 6 To disable other program positions, repeat steps 4 and 5.

### 7 Press MENU to return to the normal screen.

### To cancel the skip setting

- 1 Display the PRESET menu.
- 2 Press + or – to move the cursor (▶) to SKIP, and press ENTER.
- 3 Press + or – until the program position you want to cancel the skip setting appears, and press ENTER.
- 4 Press + or – to select OFF, and press ENTER.

# Watching the TV

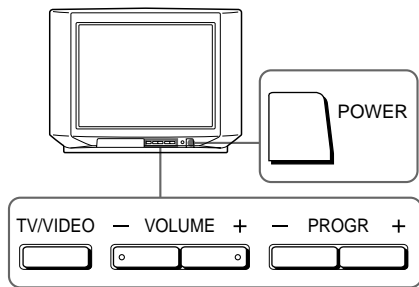

**1 Press POWER to turn on the TV.**

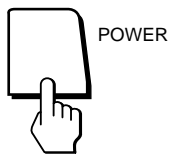

When the TV is turned on in the standby mode after pressing POWER on the TV, press POWER on the remote commander.

**2 Select the TV program you want to watch.**

**To select a program position directly**  
Press the number button.

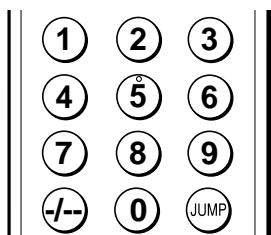

To select a two-digit program position, press “-/-” before the number buttons.

For example: to select program position 25, press “-/-,” then “2” and “5.”



**To scan through program positions**

Press PROGR +/- on the remote commander or the TV until the program position you want appears.

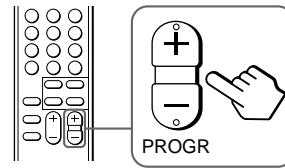

**3 Press VOL +/- on the remote commander or VOLUME +/- on the TV to adjust the volume.**

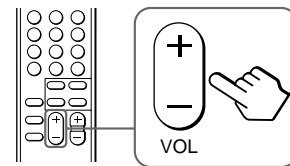

## Turning off the TV

**To turn off the TV temporarily**

Press POWER on the remote commander. The standby indicator lights up.

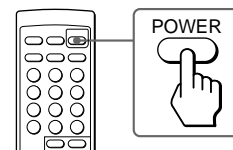

**To turn off the TV completely**

Press POWER on the TV.

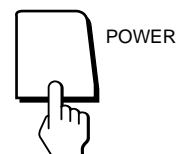

## Watching the video input

Press VIDEO/HOLD on the remote commander or TV/VIDEO on the TV.

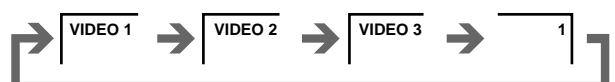
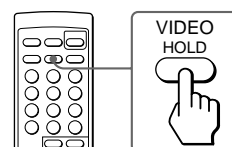

### To watch TV

Press TV on the remote commander or TV/VIDEO on the TV.

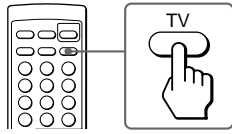

### Switching back quickly to the previous channel

Press JUMP.

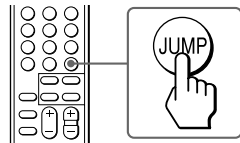

### Muting the sound

Press MUTING.

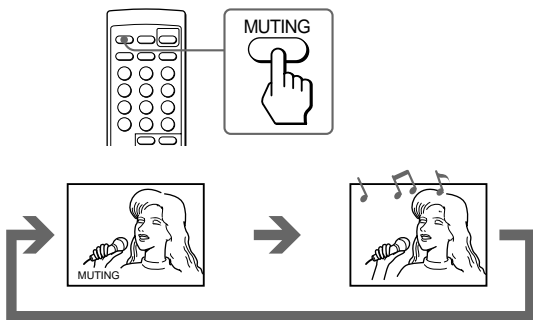

### Displaying the on-screen information

Press DISPLAY/REVEAL.

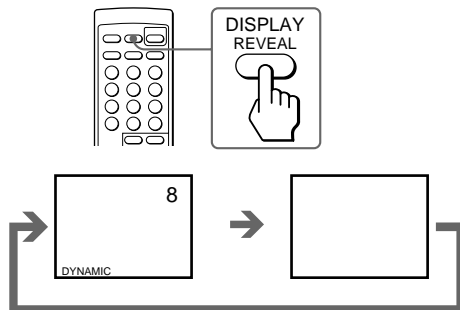

#### Note

- The on-screen display shows the program position or the video mode and the picture and sound information. The on-screen display for the picture and sound information disappear after being displayed for approximately three seconds.

### Setting the Wake Up Timer

You can set the TV to turn on automatically after the period of time you want.

#### 1 Press WAKE UP/INDEX repeatedly to set the timer.

The on-screen display appears.

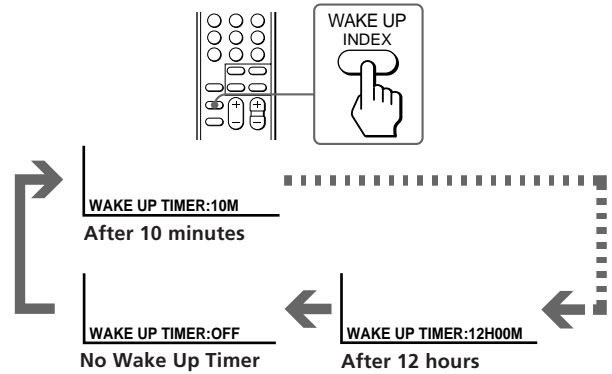

#### 2 If you want a particular TV program or video mode to be displayed using the Wake Up Timer, select the TV program or video mode.

#### 3 Press POWER on the remote commander or set the Sleep Timer to turn off the TV in the standby mode.

The WAKE UP indicator lights up in amber color.

To cancel the Wake Up Timer, press WAKE UP / INDEX repeatedly until "WAKE UP TIMER: OFF" appears, or turn off the main power of the TV.

#### Notes

- The Wake Up Timer starts immediately after the on-screen display disappears.
- The last TV program position or video mode just before the TV turns into the standby mode will appear when the TV is turned on using the Wake Up Timer.
- If no buttons or controls are pressed for more than two hours after the TV is turned on using the Wake Up Timer, the TV automatically turns into the standby mode. If you want to continue watching the TV, press any button or control on the TV or remote commander.

---

## Setting the Sleep Timer

You can set the TV to turn off automatically after the period of time you want.

**Press SLEEP.**

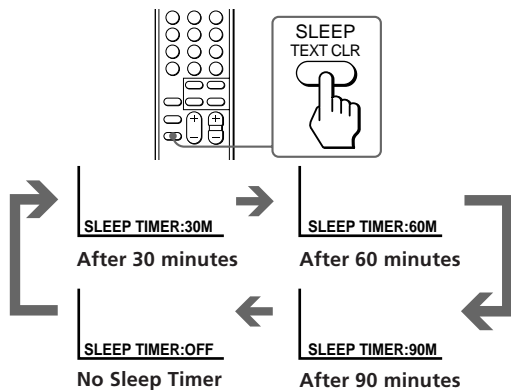

To cancel the Sleep Timer, press SLEEP repeatedly until "SLEEP TIMER: OFF" appears, or turn the TV off.

# Adjusting the picture and sound

## Selecting the picture and sound modes

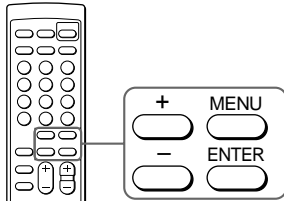

### 1 Press MENU.

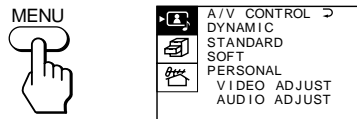

### 2 Make sure the cursor (▶) appears in the A/V CONTROL menu (A), and press ENTER.

### 3 Press + or - to move the cursor (▶) to DYNAMIC, STANDARD, SOFT, or PERSONAL, and press ENTER.

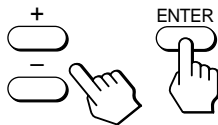

Select	To
DYNAMIC	Receive high contrast picture with powerful sound.
STANDARD	Receive normal contrast picture with medium listening sound.
SOFT	Receive mild picture with soft sound.
PERSONAL	Receive the last picture and sound settings that are adjusted using VIDEO ADJUST and AUDIO ADJUST.

### 4 Press MENU to return to the normal screen.



## Adjusting the picture settings (VIDEO ADJUST)

You can adjust the picture settings to suit your taste with the VIDEO ADJUST option. The adjusted settings are stored in the PERSONAL option.

### 1 Press MENU.

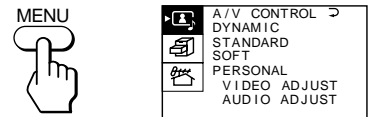

### 2 Make sure the cursor (▶) appears in the A/V CONTROL menu (A), and press ENTER.

### 3 Press + or - to move the cursor (▶) to VIDEO ADJUST, and press ENTER.



### 4 Press + or - to move the cursor (▶) to the item you want to adjust, and press ENTER.

### 5 Press + or - to adjust the selected item, and press ENTER.

For details on each item, see “Description of adjustable items” below.

### 6 To adjust other items, repeat steps 4 and 5.

### 7 Press MENU to return to the normal screen.

#### Description of adjustable items

Item	Press -	Press +
PICTURE	Decrease picture contrast.	Increase picture contrast.
COLOR	Decrease color intensity.	Increase color intensity.
BRIGHT	Darken the picture.	Brighten the picture.
HUE	Make picture tones become reddish.	Make picture tones become greenish.
SHARP	Soften the picture.	Sharpen the picture.
VM	Decrease emphasis on picture edges.	Increase emphasis on picture edges.

#### Notes

- You can adjust VM for the KV-J29MF1, KV-J29MF1S, KV-J29MH2, and KV-J29MN21 models only.
- You can adjust HUE for the NTSC color system only.

**If the picture is slightly snowy  
(for KV-J29MF1/J29MF1S/J29MH2/J29MN21  
only)**

You may try to improve the picture by changing the VM setting as described below:

- 1 Display the VIDEO ADJUST menu.
- 2 Press + or - to move the cursor (▶) to VM, and press ENTER.
- 3 Press + or - to select LOW, and press ENTER.

**If the picture color is abnormal when receiving programs through the ㊦ (antenna) terminal**

Change the color system or the TV system from the PRESET menu as described below until the color becomes normal.

- 1 Display the PRESET menu.
- 2 Press + or - to move the cursor (▶) to COL SYS or TV SYS, and press ENTER.
- 3 Press + or - to change the color system or the TV system until the color becomes normal, and press ENTER.

**Note**

- Normally set the color system (COL SYS) to AUTO.

**Adjusting the sound settings  
(AUDIO ADJUST)**

You can adjust the sound settings to suit your taste with the AUDIO ADJUST option. The adjusted settings are stored in the PERSONAL option.

**1 Press MENU.**

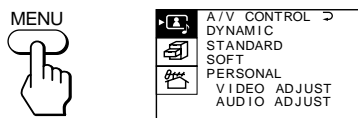

**2 Make sure the cursor (▶) appears in the A/V CONTROL menu ( ㊦ ), and press ENTER.**

**3 Press + or - to move the cursor (▶) to AUDIO ADJUST, and press ENTER.**

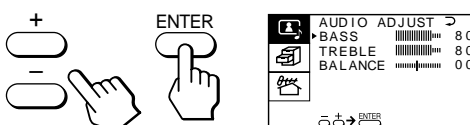

**4 Press + or - to move the cursor (▶) to the item you want to adjust, and press ENTER.**

**5 Press + or - to adjust the selected item, and press ENTER.**

For details on each item, see “Description of adjustable items” below.

**6 To adjust other items, repeat steps 4 and 5.**

**7 Press MENU to return to the normal screen.**

**Description of adjustable items**

Item	Press -	Press +
BASS	Decrease the bass sound.	Increase the bass sound.
TREBLE	Decrease the treble sound.	Increase the treble sound.
BALANCE	Increase the left speaker's volume	Increase the right speaker's volume.

**If the sound is distorted or noisy when receiving programs through the ㊦ (antenna) terminal**

Change the TV system from the PRESET menu as described below until the sound becomes normal.

- 1 Display the PRESET menu.
- 2 Press + or - to move the cursor (▶) to TV SYS, and press ENTER.
- 3 Press + or - to change the TV system until the sound becomes normal, and press ENTER.



# Listening to the woofer sound (3D WOOFER)

## ■ KV-J25MH2/J29MH2/J25MN21/J29MN21 only

The 3D WOOFER enhances bold, dynamic and clear sounds that spread over a large area and lets you enjoy the thrills, horrors, and suspense of movies or music. The initial setting of the 3D WOOFER is **ON**, and it is ready for your listening when you turn on the TV.

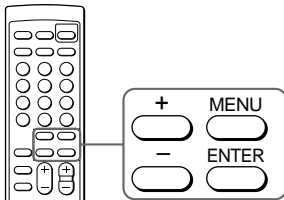

### Notes

- To listen to the woofer sound, make sure that the 3D WOOFER is properly connected to the TV (see page 6).
- You can also disconnect the 3D WOOFER from the TV to turn off the woofer sound.

## To turn off the woofer sound

### 1 Press MENU.

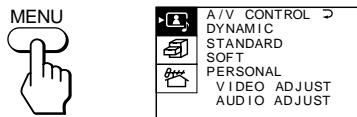

### 2 Make sure the cursor (▶) appears in the A/V CONTROL menu (A), and press ENTER.

### 3 Press + or - to move the cursor (▶) to AUDIO ADJUST, and press ENTER.

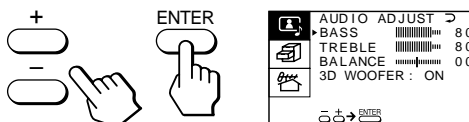

### 4 Press + or - to move the cursor (▶) to 3D WOOFER, and press ENTER.

### 5 Press + or - to select OFF, and press ENTER.

### 6 Press MENU to return to the normal screen.

# Listening to the surround sound (SURROUND)

The SURROUND feature enables you to enjoy a surround sound effect that is like being in a large hall or live concert when receiving stereo signals.

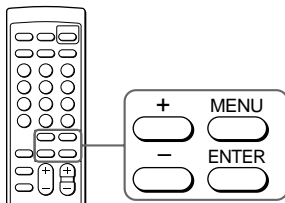

## Description of adjustable items

Select	To
HALL<SRS>	Listen to a sound that spreads out over a large area.
LIVE<SRS>	Listen to the sound that gives the feeling of being at a live concert.
SPACE	Listen to a monaural sound that gives a stereo-like effect.
OFF	Turn off the surround sound.

### Note

- The (●)® SRS (SOUND RETRIEVAL SYSTEM) is manufactured by Sony Corporation under license from SRS Labs, Inc. It is covered by U.S. Patent No. 4,748,669. The word "SRS" and the SRS symbol (●) are registered trademarks of SRS Labs, Inc.

### 1 Press MENU.

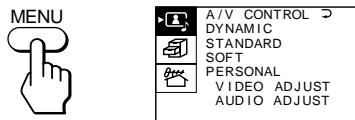

### 2 Press + or - to move the cursor (▶) to the FEATURES menu (FEATURES), and press ENTER.

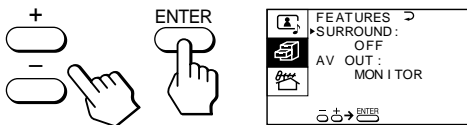

### 3 Make sure the cursor (▶) appears beside SURROUND, and press ENTER.

### 4 Press + or - to select HALL<SRS>, LIVE<SRS>, or SPACE, and press ENTER.

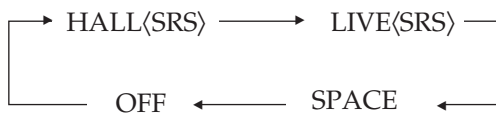

For details on each item, see "Description of adjustable items" below.

### 5 Press MENU to return to the normal screen.

# Selecting a stereo or bilingual program

## ■ KV-J25MH2/J29MH2/J25MN21/J29MN21 only

You can enjoy stereo sound or bilingual programs of NICAM and A2 (German) stereo systems.

### Press A/B/ENLARGE repeatedly until you receive the sound you want.

The on-screen display changes corresponding to the selected sound, and the STANDBY/STEREO/WAKE UP indicator also lights up.

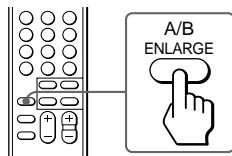

## Receiving area for NICAM and A2 (German) programs

System	Receiving area
NICAM	Hong Kong, Singapore, New Zealand, etc.
A2 (German)	Australia, Malaysia, Thailand, etc.

### Notes

- If the signal is very weak, the sound becomes monaural automatically.
- If the stereo sound is noisy when receiving a NICAM program, select "MONO." The sound becomes monaural, however, the noise will be reduced.

## When receiving a NICAM program

Broadcasting	On-screen display (Selected sound)
NICAM stereo	NICAM (Stereo sound) → MONO (Regular sound)
NICAM bilingual	NICAM MAIN (Main sound) → NICAM SUB (Sub sound) → MONO (Regular sound)
NICAM monaural	NICAM MAIN (Main sound) → MONO (Regular sound)

## When receiving an A2 (German) program

Broadcasting	On-screen display (Selected sound)
A2 (German) stereo	STEREO (Stereo sound)
A2 (German) bilingual	MAIN (Main sound) → SUB (Sub sound)

# Viewing Teletext

## ■ KV-J25MN21/IJ29MN21 only

TV stations broadcast an information service called Teletext via a TV channel. Teletext service allows you to receive various information such as market shares, weather forecasts or news at any time.

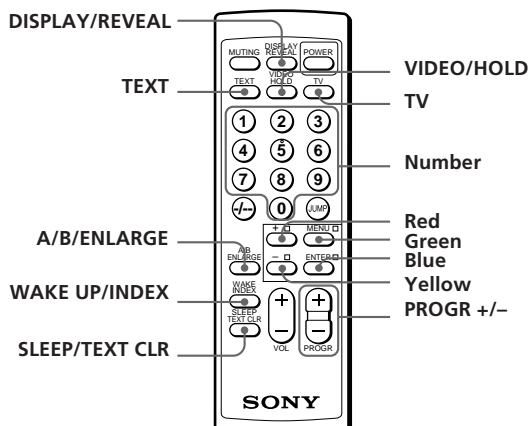

## Displaying Teletext

- 1 Select a TV channel that carries the Teletext broadcast you want to watch.**
- 2 Press TEXT to display the Teletext.**

A Teletext page (normally the index page) is displayed. If there is no Teletext broadcast, "100" is displayed at the top left corner of the screen.

### To turn off Teletext

Press TV.

## Superimposing a Teletext page on the TV picture

### Press TEXT.

Each time you press TEXT, the screen changes as follows:



## Checking the contents of a Teletext service (INDEX)

Press WAKE UP/INDEX to display an overview of the Teletext contents and page numbers.

## Using FASTEXT

This feature allows you to quickly access a Teletext page that uses FASTEXT. When a FASTEXT program is broadcasted, the colored menus appear at the bottom of the screen. The colors of the menus correspond to the red (+), green (MENU), yellow (-), and blue (ENTER) color-coded buttons on the remote commander.

### To access a FASTEXT menu

Press the color-coded button on the remote commander that corresponds to the colored menu which appears at the bottom of the screen.

The menu page appears on the screen after several seconds.

## Selecting a Teletext page

Press the number buttons to enter the three-digit page number of the Teletext page you want.

If you make a mistake, re-enter the correct page number.

### To access the next or previous page

Press PROGR +/-.

You can also access a Teletext page of any page numbers that appear in the colored column at the bottom of the screen using the corresponding color-coded button on the remote commander.

## Holding a Teletext page (HOLD)

A Teletext page may consist of several subpages. You can stop the page scrolling in order to read the text at your own pace.

### Press VIDEO/HOLD.

The HOLD symbol "Ⓜ" appears at the top left corner of the screen.

### To resume normal Teletext operation

Press VIDEO/HOLD again or TEXT.

---

## Revealing concealed information (REVEAL)

The REVEAL option lets you disclose concealed information, such as an answer to a quiz that you find on some of the Teletext pages.

Press **DISPLAY/REVEAL**.

### To conceal the information

Press **DISPLAY/REVEAL** again.

---

## Enlarging the Teletext display (ENLARGE)

Press **A/B/ENLARGE**.

Each time you press **A/B/ENLARGE**, the Teletext display changes as follows:

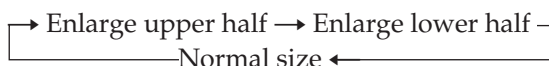

---

## Waiting for a Teletext page while watching a TV program (TEXT CLEAR)

- 1** Key in the page number of the Teletext that you want to watch, then press **SLEEP/TEXT CLR**.
- 2** When the page number is displayed on the screen, press **TEXT** to turn on the Teletext.

# Customizing the TV

## Using the AV OUT (advanced rec-out) terminal

You can select the output signal from the MON/TV OUT jacks at the rear of the TV. However, the signal of the Teletext broadcast cannot be output even though MONITOR is selected (for KV-J25MN21/J29MN21 only).

### 1 Press MENU.

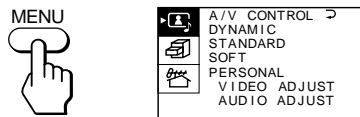

### 2 Press + or - to move the cursor (▶) to the FEATURES menu (FEATURES), and press ENTER.

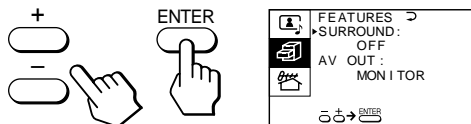

### 3 Press + or - to move the cursor (▶) to AV OUT, and press ENTER.

### 4 Press + or - to select the output signal, and press ENTER.

Select	To
TV	Output the signal of the TV broadcast.
MONITOR	Output the signal of the picture you are watching as a main picture.

#### Note

- Do not change the channel while recording with a VCR through the MON/TV OUT jacks. If you change the channel, it also changes the channel you are recording.

## Adjusting the picture tilt

### ■ KV-J29MF1/J29MF1S/J29MH2/J29MN21 only

You can adjust the picture tilt if it is not aligned to the TV screen. This may happen due to the direction of the earth's magnetic fields in relation to the TV position.

### 1 Press MENU.

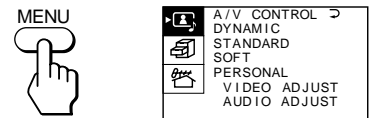

### 2 Make sure the cursor (▶) appears in the A/V CONTROL menu (A/V CONTROL), and press ENTER.

### 3 Press + or - to move the cursor (▶) to TILT CORRECT, and press ENTER.

### 4 Press + or - to select the most suitable value to adjust the picture tilt, and press ENTER.

TILT CORRECT:

-5 ← -4 ← -3 ← -2 ← -1 ← 0 → +1 → +2 → +3 → +4 → +5  
Press - Press +

# Troubleshooting

If you have any problems, read this manual again and check the countermeasure for each of the symptoms listed below.

If the problem persists after trying the methods below, contact your nearest Sony dealer or authorized service center.

## Snowy picture Noisy sound

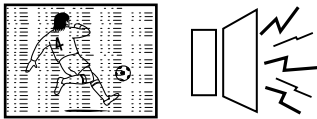

- Check the antenna.
- Check the antenna connection on the TV and on the wall.
- Check the TV system (TV SYS) setting.

## Dotted lines or stripes



- This may be caused by local interference (e.g. cars, neon signs, hair dryers, etc.). Adjust the antenna for minimum interference.

## Double images or "ghosts"



- This may be caused by reflections from nearby mountains or buildings. A highly directional antenna may improve the picture.

## Good picture Noisy sound

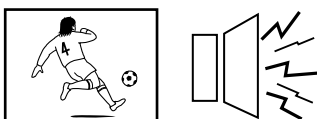

- Check the TV system (TV SYS) setting.

## No picture No sound

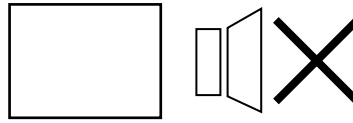

- Press POWER.
- Press POWER to turn off the TV for about five seconds and then turn it on again.
- Check the power cord connection.
- Check the antenna connection.
- Check the VCR connections.

## Good picture No sound

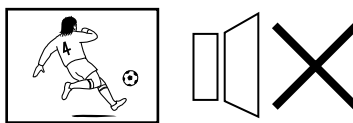

- Press VOL +.
- Press MUTING.
- Press A/B/ENLARGE (KV-J25MH2/J29MH2/J25MN21/J29MN21).

## No color



- Adjust the COLOR level in the VIDEO ADJUST menu of the PERSONAL option.
- Check the color system (COL SYS) setting.

## No sound from 3D WOOFER (KV-J25MH2/J29MH2/J25MN21/J29MN21 only)

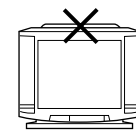

- Check the connection of the 3D WOOFER .

## TV cabinet creaks

- Even if the picture or the sound is normal, changes in the room temperature sometimes make the TV cabinet expand or contract, making a noise. This does not indicate a malfunction.

# Specifications

	<b>KV-J25MF1, KV-J25MF1S, KV-J25MH2, KV-J25MN21</b>	<b>KV-J29MF1, KV-J29MF1S, KV-J29MH2, KV-J29MN21</b>	<b>Note</b>
<b>Power requirements</b>	110-240 V AC, 50/60 Hz		
<b>Power consumption (W)</b>	Indicated on the rear of the TV		
<b>Television system</b>	B/G, I, D/K, M		
<b>Color system</b>	PAL, PAL 60, SECAM, NTSC4.43, NTSC3.58		
<b>Stereo system</b>	NICAM Stereo B/G, I; A2 Stereo (German) B/G		KV-J25MH2/J29MH2/ J25MN21/J29MN21
<b>Teletext language</b>	English, German, Swedish, Italian, French, Spanish		KV-J25MN21/J29MN21
<b>Channel coverage</b>			
<b>B/G</b>	VHF : E2 to E12 / UHF : E21 to E69 / CATV : S01 to S03, S1 to S41		
<b>I</b>	UHF : B21 to B68 / CATV : S01 to S03, S1 to S41		
<b>D/K</b>	VHF : C1 to C12, R1 to R12 / UHF : C13 to C57, R21 to R60 / CATV: Z1 to Z39, S01 to S03, S1 to S41		
<b>M</b>	VHF : A2 to A13 / UHF : A14 to A79/ CATV: A-8 to A-2, A to W+4, W+6 to W+84		
<b>Antenna</b>	75-ohm external terminal for VHF/UHF		
<b>Audio output (speaker)</b>	5 W + 5 W + 15 W (3D WOOFER)		KV-J25MH2/J29MH2/ J25MN21/J29MN21
	6 W + 6 W		KV-J25MF1/J29MF1/ J25MF1S/J29MF1S
<b>Number of terminal</b>			
<b>Video</b>	Input : 3 Output : 1		Phono jacks; 1 Vp-p, 75ohms
<b>Audio</b>	Input : 3 Output : 1		Phono jacks; 500 mVrms
<b>S Video</b>	Input : 1		Y: 1 Vp-p, 75 ohms, unbalanced, sync negative C: 0.286 Vp-p, 75 ohms
<b>Headphone</b>	Output : 1		Minijack
<b>3D WOOFER</b>	Output : 1		KV-J25MH2/J29MH2/ J25MN21/J29MN21
<b>Picture tube</b>	Super Trinitron (25 in.)	Super Trinitron Plus (29 in.)	
<b>Tube size (cm)</b>	64	72	Measured diagonally
<b>Screen size (cm)</b>	60	68	Measured diagonally
<b>Dimensions (w/h/d, mm)</b>	712 x 521 x 520		KV-J25MF1/J25MF1S
	712 x 550 x 520		KV-J25MH2/J25MN21
	780 x 577 x 542		KV-J29MF1/J29MF1S
	780 x 601 x 542		KV-J29MH2/J29MN21
<b>Mass (kg)</b>	33		KV-J25MF1/J25MF1S
	36		KV-J25MH2/J25MN21
	43		KV-J29MF1/J29MF1S
	46		KV-J29MH2/J29MN21
<b>Accessory (optional)</b>	TV stand (SU-25H)	TV stand (SU-29H)	

Design and specifications are subject to change without notice.