

Trinitron® Color Video CD TV

Operating Instructions _____	EN
#### _____	C##
#### _____	RF
#### _____	A



f



KVD-C21MF1

WARNING



To prevent fire or shock hazard, do not expose the unit to rain or moisture.

To avoid electrical shock, do not open the cabinet. Refer servicing to qualified personnel only.

The following caution label is located inside of the unit.

CAUTION	; INVISIBLE LASER RADIATION WHEN OPEN. AVOID EXPOSURE TO BEAM.
ADVARSEL	; USYNLIG LASERSTRÅLING VED ÅBNING NÅR SIKKERHEDSAFBRYDERE ER I GÆLDFUNKTION. UNDGÅ UDSÆTTELSE FOR STRÅLING.
VARO!	; AVATTAESSA JA SUOJALUKITUS OHITETTAESSA DLET ALTIINA LASERSÄTEILYLLE.
VARNING	; LASERSTRÅLING NÅR DENNA DEL ÅR ÖPPNAD OCH SPÄRREN ÅR URKOPPLAD.
ADVARSEL	; USYNLIG LASERSTRÅLING NÅR DEKSEL ÅPNEES. UNNGÅ EKSPONERING FOR STRÅLEN.

This unit can play following discs:

	Audio CDs	CD-G (CD graphics)	VIDEO CDs
Disc logo			
Contents	Audio	Audio + Video (still pictures)	Audio + Video (moving pictures)
Disc size	12cm/8cm (CD single)	12cm/8cm	12cm/8cm
Play time	74 min./20 min.	74 min./20 min.	74 min./20 min.

Note on VIDEO CDs

This TV conforms to Ver. 1.1 and Ver. 2.0 of VIDEO CD standards. You can enjoy two kinds of playback according to the discs.

Disc type	You can
VIDEO CDs without PBC* (Ver. 1.1 discs)	Enjoy video playback (moving pictures) as well as music.
VIDEO CDs with PBC* (Ver. 2.0 discs)	Play interactive software using menu screens displayed on the TV screen, in addition to the video playback function of Ver 1.1 discs.

* PBC: Playback control

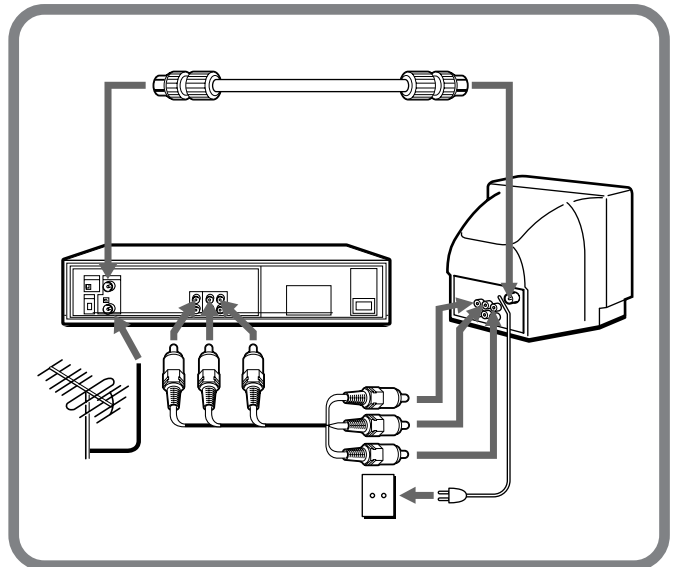
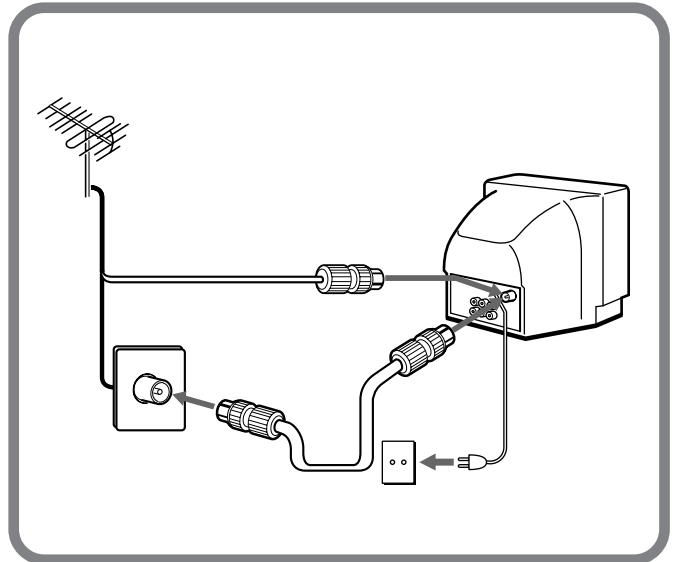

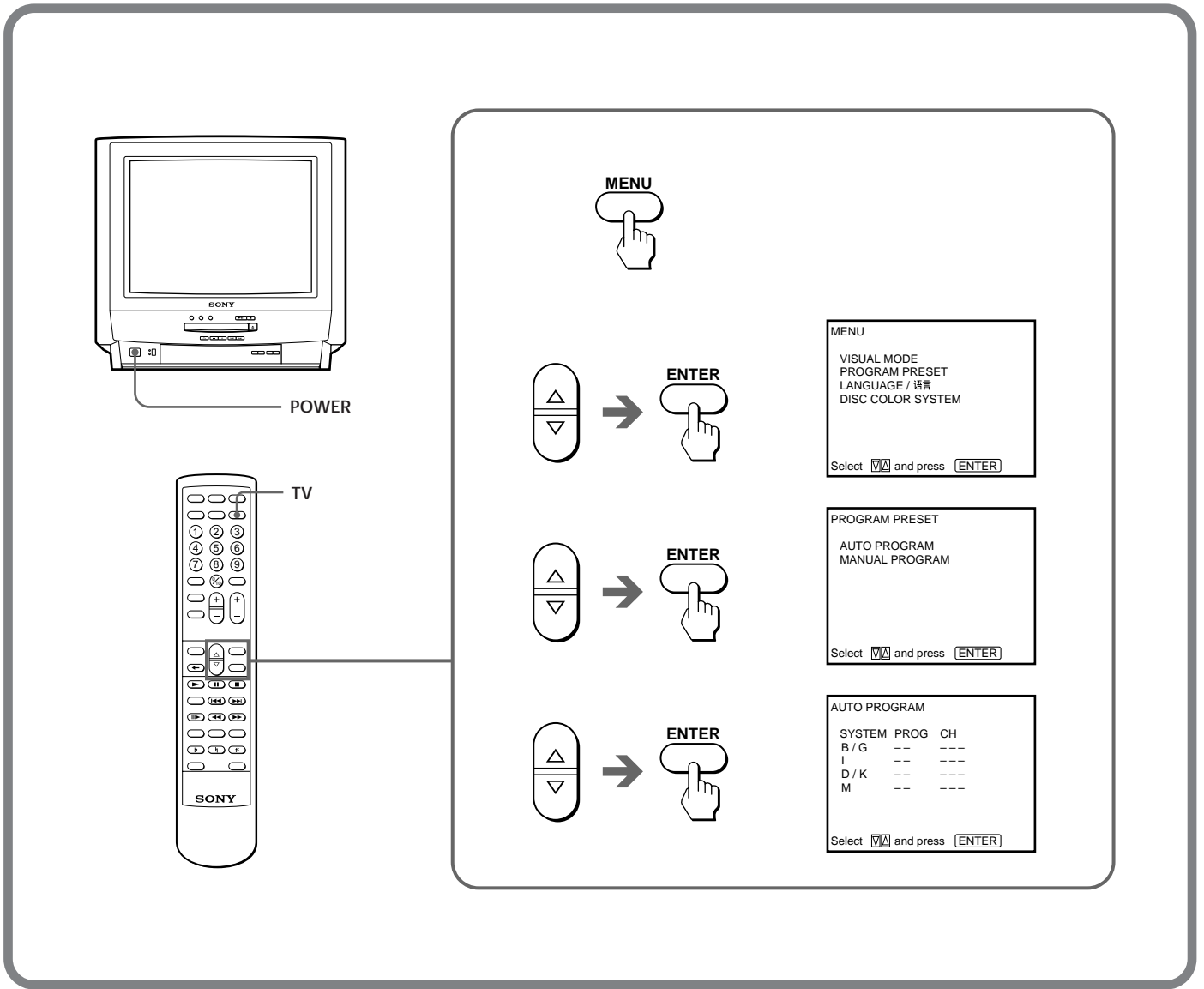

EN

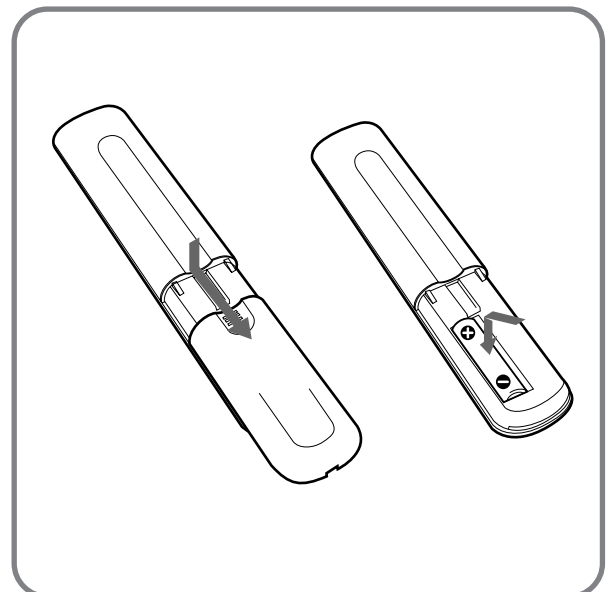
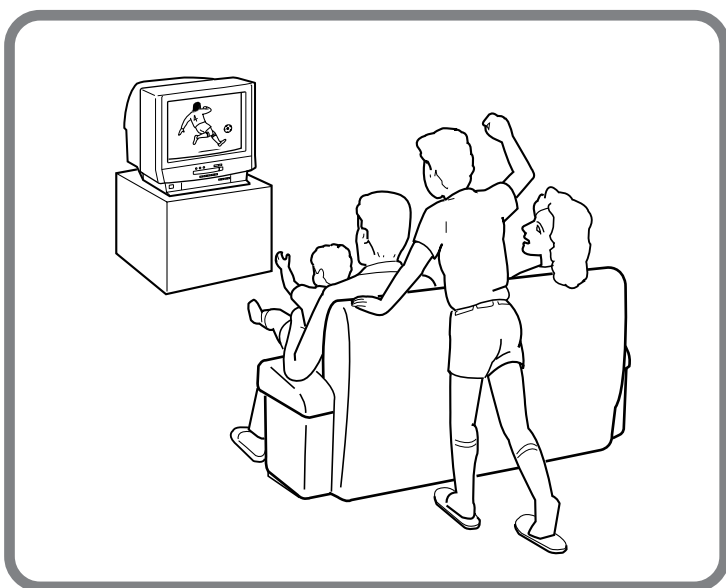

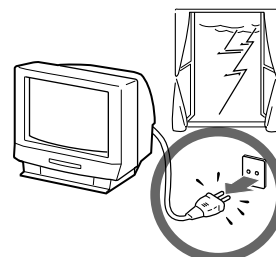
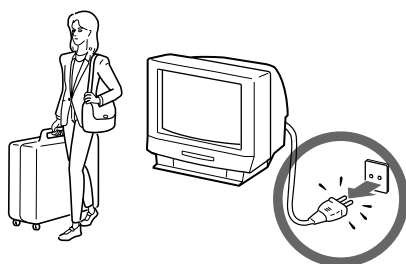
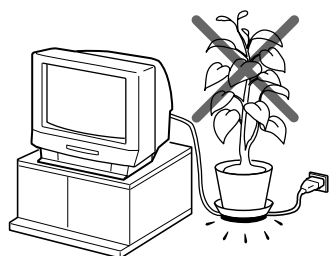
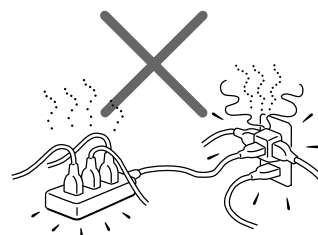
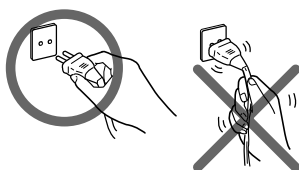
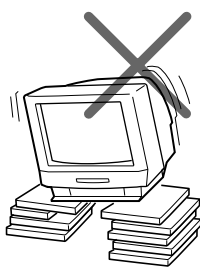
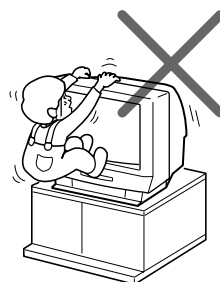
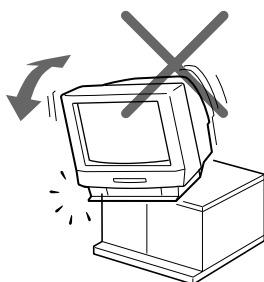
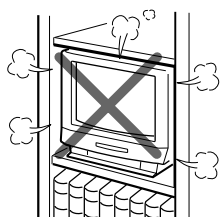
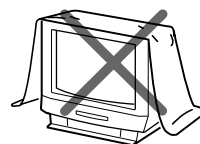
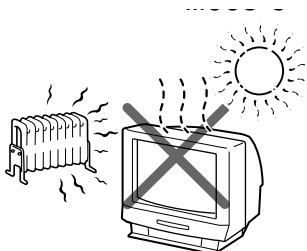
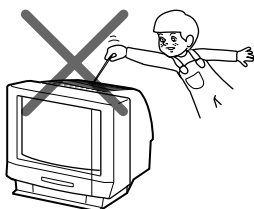
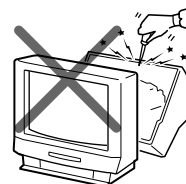
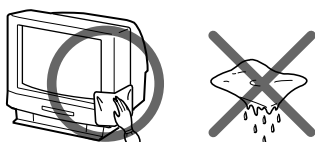
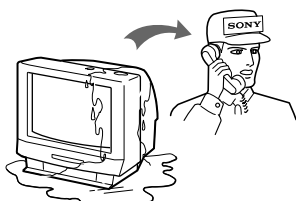
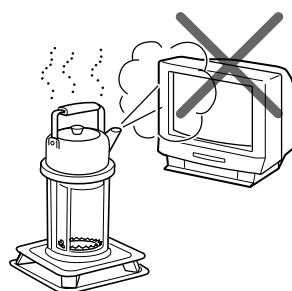
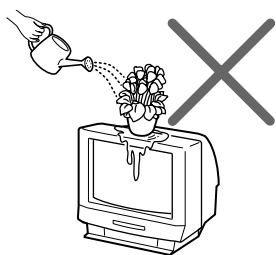
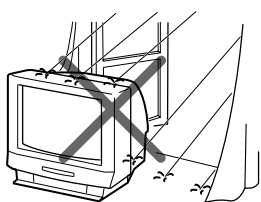

Precautions

- Operate the TV only at 110-240 V AC.
- Do not operate the TV if any liquid or solid object falls into it. Have it checked immediately by qualified personnel only.
- Do not block the ventilation openings.
- Do not install the TV in a confined space, such as a bookcase or built-in cabinet.
- Do not install the TV in an inclined position.
- Do not install the TV in locations where it is;
 - Extremely hot or cold
 - Dusty or dirty
 - Very humid
 - Vibrating
 - Subject to direct sunlight
- Do not keep the TV plugged in if you are not going to use it for several days.
- Do not pull the power cord to disconnect the TV. Pull it out by the plug.

Table of Contents

Getting Started

- 6 Connections
- 8 Presetting channels

TV Operations

- 11 Watching the TV

CD Operations

- 13 Playing CDs

Karaoke Operations

- 17 Karaoke sing-along

Additional Operations

- 19 Using the Sleep Timer
- 19 Using the Wake Up timer
- 20 Adjusting the picture mode
- 21 Muting the sound
- 21 Listening with headphones

Additional Information

- 22 Troubleshooting
- 23 Notes on CDs
- 24 Receivable channels and channel display
- 24 Specifications
- 25 Index to parts and controls

Connections

Connecting a VHF antenna or a combination VHF/UHF antenna — 75-ohm coaxial cable (round)

Attach an optional IEC antenna connector to the 75-ohm coaxial cable.
Plug the connector into the ~ (antenna) socket at the rear of the TV.

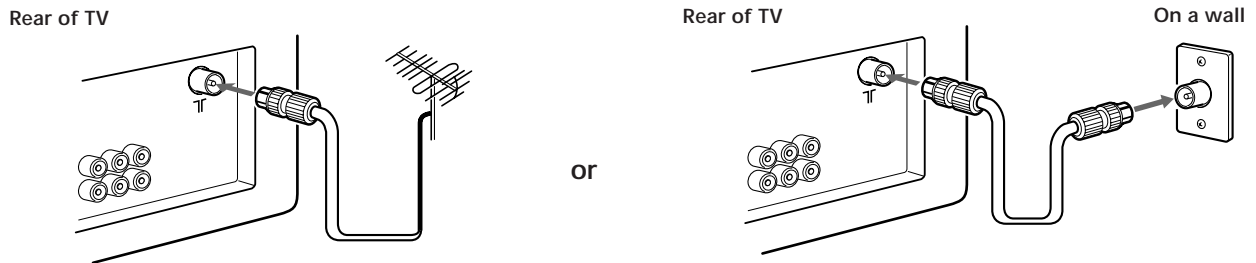

Connecting optional equipment

You can connect optional audio/video equipment to your TV such as a VCR, multi disc player, camcorder, video game or stereo system.

Connecting video equipment using video input jacks

Rear of TV

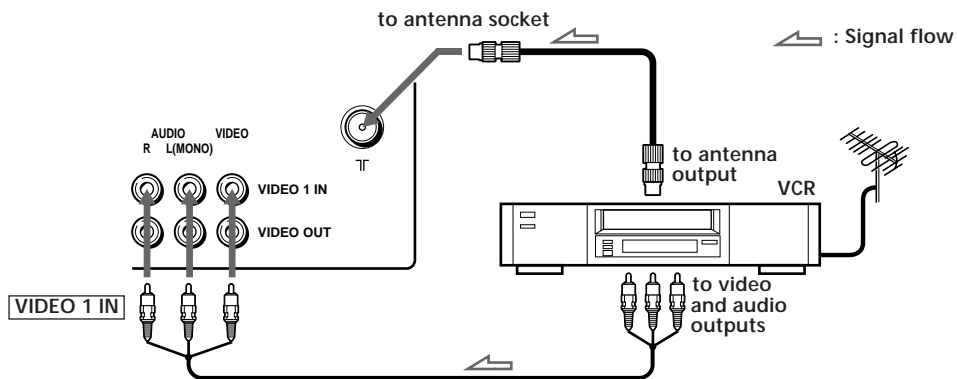

When connecting a monaural VCR

Connect the yellow plug to VIDEO and the black plug to AUDIO-L (MONO).

Front of TV

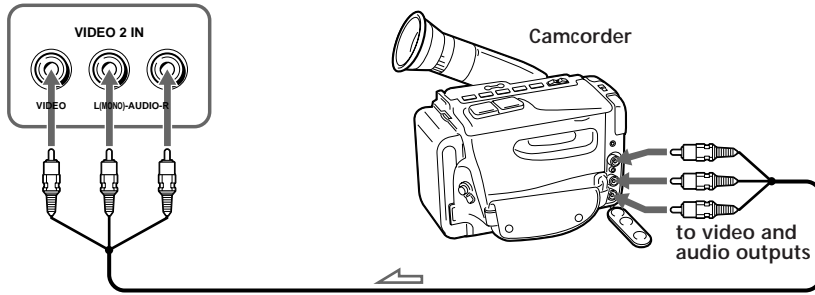

↗ : Signal flow

Connecting audio/video equipment using VIDEO OUT jacks

Rear of TV

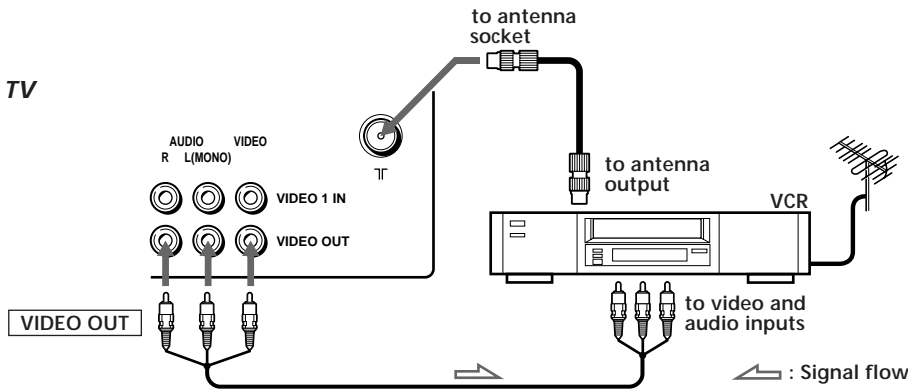

↗ : Signal flow

EN

When recording through the VIDEO OUT jacks

If you change the channel or video input while recording with a VCR, the channel or video input you are recording also will be changed.

To prevent the TV from falling

Stabilize the TV in either of the following ways.

- With the supplied screws, attach the band to the TV stand and to the rear of the TV using the hole provided on the TV.
- Put the cord or chain through the clamps to stabilize the TV against a wall or pillar.

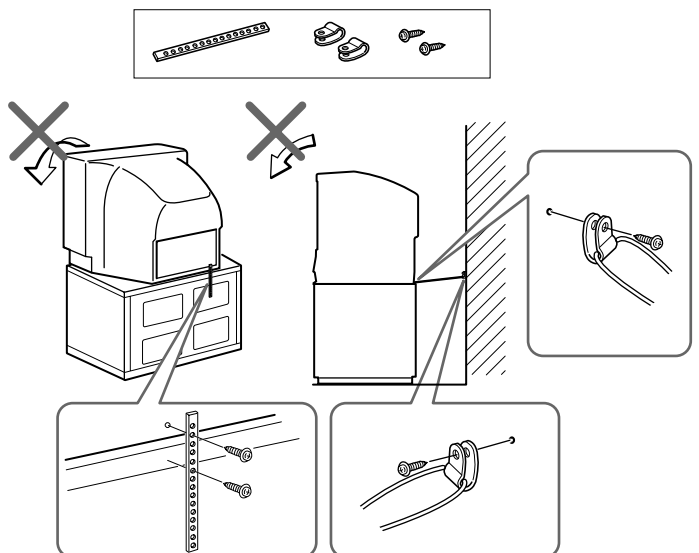

Presetting channels

Presetting channels automatically

You can preset 80 TV channels in numerical sequence from program position 1.

Front of TV

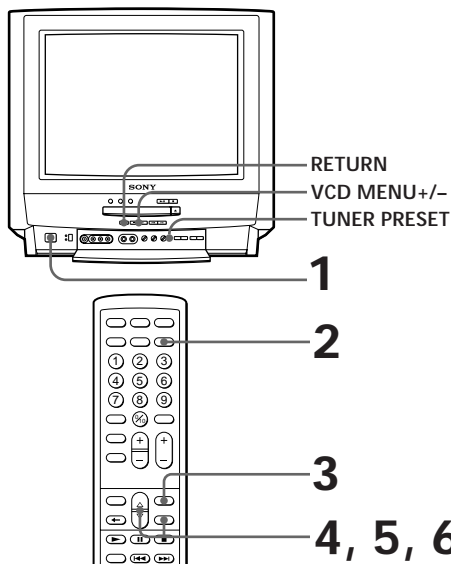

1 Press **POWER**.



When the TV is in standby mode after pressing **POWER**, press **POWER** on the remote commander.

2 Press **TV**.

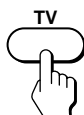

3 Press **MENU**.
The main menu appears.



8-EN | Getting Started

4 Press **>** or **⏪** to select **"PROGRAM PRESET"** and press **ENTER**.

The **PROGRAM PRESET** menu appears.

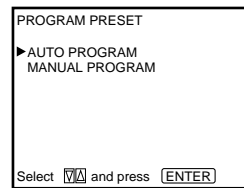

5 Press **>** or **⏪** to select **"AUTO PROGRAM"** and press **ENTER**.

The **AUTO PROGRAM** menu appears.

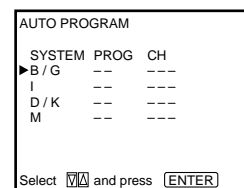

6 Press **>** or **⏪** to select the TV system (**B/G**, **I**, **D/K** or **M**) of the channels which you want to preset, and press **ENTER**.

Presetting starts from program position 1. The preset program and channel numbers are displayed on the screen in sequence.

When presetting is finished, the program position from which presetting starts appears. All available channels are now stored on successive number buttons.

To preset channels automatically using the TUNER PRESET button on the TV.

1 Press **POWER** to switch it on.

2 Press **TUNER PRESET** with a pointed object.
The following display appears.

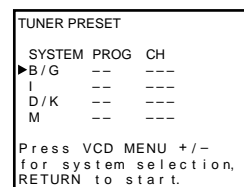

3 Using **VCD MENU +/-**, move the cursor (") to the TV system (**B/G**, **I**, **D/K** or **M**) of the channels which you want to preset.

4 Press **RETURN**.

Presetting starts from program position 1.

When presetting is finished, the program position from which presetting starts appears.

Presetting channels manually

To change the channel for a particular program position or to receive a channel with a weak signal, preset the channel manually.

1 Press MENU.
The main menu appears.

2 Press \triangleright or \oslash to select "PROGRAM PRESET" and press ENTER.
The PROGRAM PRESET menu appears.

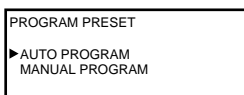

3 Press \triangleright or \oslash to select "MANUAL PROGRAM" and press ENTER.
The MANUAL PROGRAM menu appears.

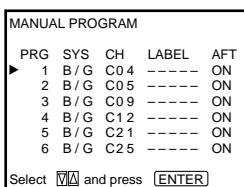

4 Press \triangleright or \oslash to select the program position (number button) to which you want to preset a channel, and press ENTER.
The "SYS" position turns red.

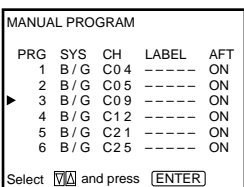

For program positions beyond 6
This display scrolls by pressing \triangleright repeatedly.

5 Select the TV broadcast system (B/G, I, D/K or M) with \triangleright or \oslash , and press ENTER.
The CH number turns red.

6 Search for the channel with \triangleright (down) or \oslash (up).
The channel number starts counting up or down. When a channel is found, it stops. If you want to preset this channel, press ENTER. If not, press with \triangleright or \oslash to search for another channel. You can also select the channel number directly with the number buttons. Press C (once for regular channels, twice for cable channels), number buttons (e.g. For 06 press 0 and 6), then ENTER.

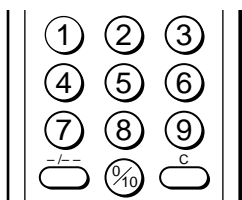

7 Repeat steps 4 to 6 to preset other channels.

8 After you finish presetting, press MENU to go back to the original screen.

If you have made a mistake
Press ? to go back to the previous position.

Skipping program positions

You can skip unused program positions when selecting program with the PROGR +/- buttons. However, the skipped programs may still be called up when you select them with the number buttons.

1 Press MENU.
The main menu appears.

2 Press \triangleright or \oslash to select "PROGRAM PRESET" and press ENTER.
The PROGRAM PRESET menu appears.

3 Press \triangleright or \oslash to select "MANUAL PROGRAM" and press ENTER.
The MANUAL PROGRAM menu appears.

4 Press \triangleright or \oslash to select the program position which you want to skip and press ENTER.
The "SYS" position turns red.

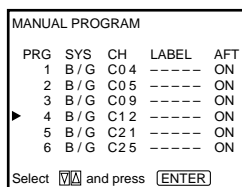

5 Press \triangleright or \oslash until "---" appears in the "SYS" position and press ENTER.

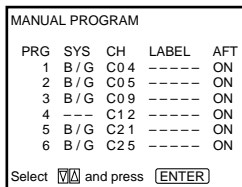

When you select programs using the PROGR +/- buttons, the program position is skipped.

6 Repeat steps 4 and 5 to skip other program positions.

7 Press MENU to go back to the original screen.

Manual fine-tuning

Normally, the automatic fine-tuning (AFT) is already working. However, if the picture of a program is distorted, you can use the manual fine-tuning function to obtain better picture reception.

- 1 Press MENU.**
The main menu appears.
- 2 Press \triangleright or ϕ to select "PROGRAM PRESET" and press ENTER.**
The PROGRAM PRESET menu appears.
- 3 Press \triangleright or ϕ to select "MANUAL PROGRAM" and press ENTER.**
The MANUAL PROGRAM menu appears.
- 4 Press \triangleright or ϕ to select the program position corresponding to the channel which you want to manually fine-tune, and press ENTER repeatedly until the AFT position turns red.**

MANUAL PROGRAM					
PRG	SYS	CH	LABEL	AFT	
1	B/G	C04	-----	ON	
2	B/G	C05	-----	ON	
3	B/G	C09	-----	ON	
4	B/G	C12	-----	ON	
5	B/G	C21	-----	ON	
6	B/G	C25	-----	ON	

Select \triangleright and press ϕ and press ENTER

- 5 Fine-tune the channel with \triangleright or ϕ so that you get the best TV reception. As you press these buttons, the frequency changes from -15 to +15.**

MANUAL PROGRAM					
PRG	SYS	CH	LABEL	AFT	
1	B/G	C04	-----	ON	
2	B/G	C05	-----	ON	
3	B/G	C09	-----	ON	
4	B/G	C12	-----	ON	- 3
5	B/G	C21	-----	ON	
6	B/G	C25	-----	ON	

Select \triangleright and press ϕ and press ENTER

- 6 After fine-tuning, press ENTER.**
The cursor appears beside the program position. Now the fine-tuned level is stored.
- 7 Repeat steps 4 to 6 to fine-tune other channels.**
- 8 Press MENU to go back to the original screen.**

Captioning a station name

You can name a channel using up to five characters (letters or numbers) to be displayed on the TV screen (e.g. MTV). Using this function, you can easily identify which channel you are watching.

- 1 Press MENU.**
The main menu appears.
- 2 Press \triangleright or ϕ to select "PROGRAM PRESET" and press ENTER.**
The PROGRAM PRESET menu appears.
- 3 Press \triangleright or ϕ to select "MANUAL PROGRAM" and press ENTER.**
The MANUAL PROGRAM menu appears.

MANUAL PROGRAM					
PRG	SYS	CH	LABEL	AFT	
1	B/G	C04	-----	ON	
2	B/G	C05	-----	ON	
3	B/G	C09	-----	ON	
4	B/G	C12	-----	ON	
5	B/G	C21	-----	ON	
6	B/G	C25	-----	ON	

Select \triangleright and press ϕ and press ENTER

- 4 Press \triangleright or ϕ to select the program position you want to caption and press ENTER repeatedly until the first element of the "LABEL" position turns red.**
- 5 Select a letter or number with \triangleright or ϕ and press ENTER.**
The next element turns red. Select other characters in the same way. For the element you want to leave blank, select "-" and press ENTER.

MANUAL PROGRAM					
PRG	SYS	CH	LABEL	AFT	
1	B/G	C04	-----	ON	
2	B/G	C05	-----	ON	
3	B/G	C09	MTV--	ON	
4	B/G	C12	-----	ON	
5	B/G	C21	-----	ON	
6	B/G	C25	-----	ON	

Select \triangleright and press ϕ and press ENTER

- 6 After selecting all the characters, press ENTER repeatedly until the cursor appears again. Now the caption you chose is stored.**
- 7 Repeat steps 4 to 6 to caption other channels.**
- 8 Press MENU to go back to the original screen.**

Watching the TV

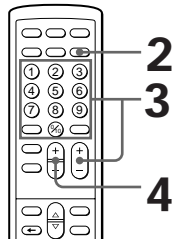
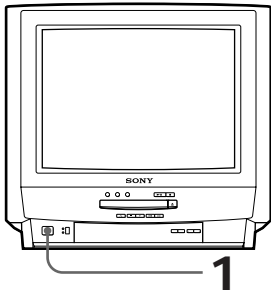

1 Press **POWER** to turn the TV on.



When the TV is in standby mode after pressing **POWER**, press **POWER** on the remote commander.

2 Press **TV**.



3 Select the TV channel you want to watch.

To select a channel directly

Press a number button.

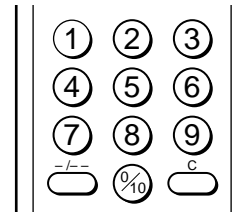

To select a two-digit channel, press “-/- -,” before the number buttons.

For example: to select channel 25, press “-/- -,” and then “2” and “5.”



To scan through channels

Press **PROGR +/-** until the channel you want appears.



4 Press **VOL +/-** to adjust the volume.



Switching off the TV

To switch off the main power, press **POWER** on the remote commander.

The TV enters standby mode and the **STANDBY** lamp on the front of the TV lights in red.

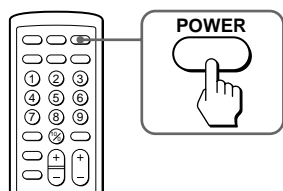

To switch off the TV completely, press **POWER** on the TV.

The **STANDBY** lamp lights in amber.



Watching the video input

Press **VIDEO**.

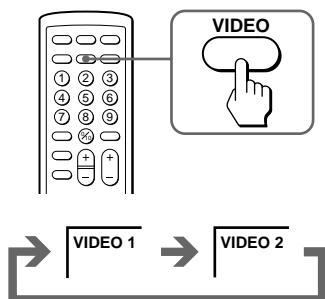

To watch TV, press **TV**.

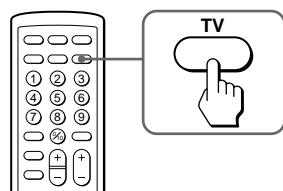

Using the on-screen display (TV mode)

Press **DISPLAY**.

The station name, program position, and CH number are displayed on the screen.

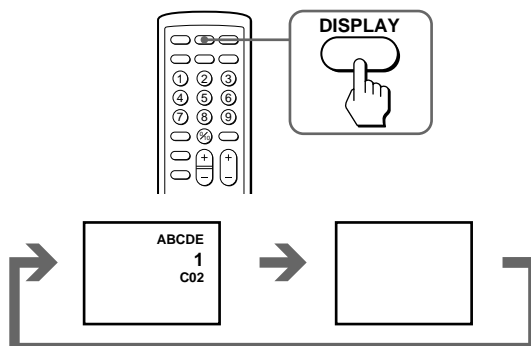

Changing the on-screen display language

You can change the on-screen display language.

EN

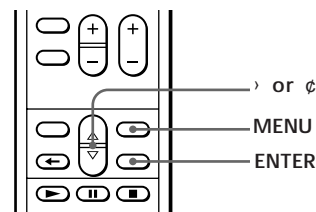

- 1 Press **MENU**.
The main menu appears.

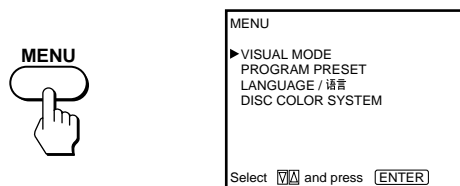

- 2 Press **▶** or **◂** to select "LANGUAGE/语言" and press **ENTER**.
- 3 Press **▶** or **◂** to select "ENGLISH/英文" or "CHINESE/中文" and press **ENTER**.

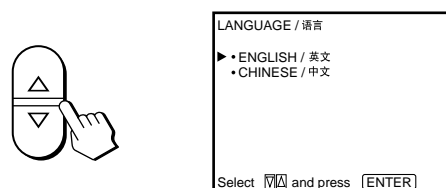

Playing CDs

Playing a VIDEO CD without PBC

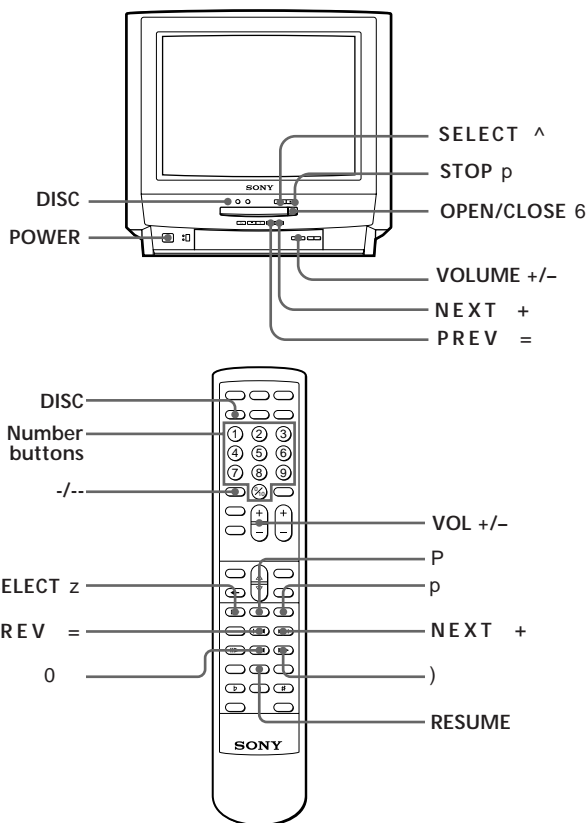

1 Press POWER.

When the TV is in standby mode after pressing POWER, press POWER on the remote commander.



2 Press DISC.



3 Press OPEN/CLOSE 6, and place the disc on the disc tray.



4 Press SELECT z on the remote commander or SELECT ^ on the TV.



5 Press VOL +/- on the remote commander or VOLUME +/- on the TV to adjust the volume.

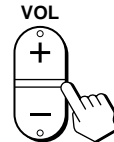

To stop playback

Press p.



When you want to	Press
Pause	P (on the remote commander) SELECT ^ (on the TV)
Resume play after pause	SELECT z, P (on the remote commander) SELECT ^ (on the TV)
See the next frame	7 (on the remote commander)
Go to the next track	NEXT +* ¹
Go back to the preceding track	PREV =* ¹
Stop play	p
Resume play after stop	RESUME (on the remote commander)
Scan forward) (on the remote commander) NEXT +* ² (on the TV)
Scan back	0 (on the remote commander) PREV =* ² (on the TV)
Select a track number	Number buttons* ³ (on the remote commander)

*¹ For operation on the TV, press the NEXT+ /PREV= button once.

*² For operation on the TV, keep pressing the NEXT+ /PREV= button.

*³ To select a track with a number over 10, press -/-- before the number buttons.

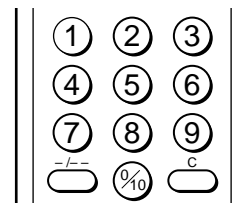

Note

- It may take a few seconds after the OPEN/CLOSE 6 button is pressed to open the disc tray.

Playing a Video CD with PBC

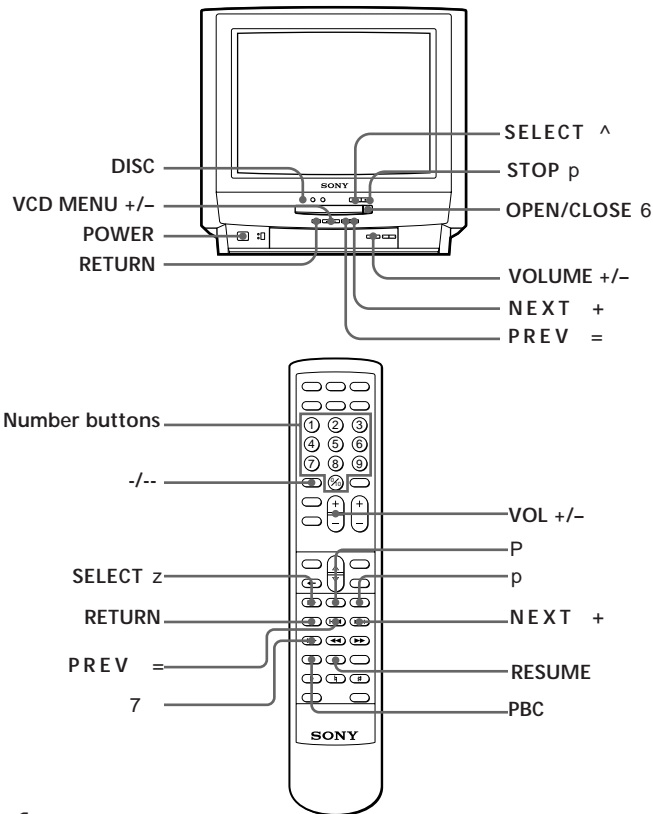

1 Press POWER.
When the TV is in standby mode after pressing POWER, press POWER on the remote commander.

2 Press DISC.



3 Press OPEN/CLOSE 6, and place the disc on the disc tray.

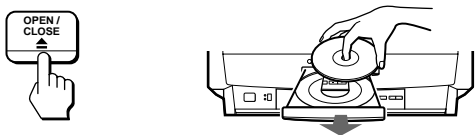

4 Press SELECT z on the remote commander or SELECT ^ on the TV.



5 Select the desired item in the menu screen with the number buttons.

on the remote commander



on the TV

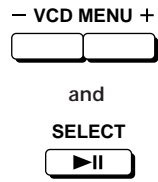

Repeat this procedure, following the instructions displayed in the menu screen.

6 Press VOL +/- on the remote commander or VOLUME +/- on the TV to adjust the volume.



To stop playback

Press p.

When you want to	Press
See the next page of the menu	NEXT + *
See the preceding page of the menu	PREV = *
Stop play	p
Go back to the preceding menu	RETURN
Resume play after pause	SELECT z, P (on the remote commander)
Resume play after stop	RESUME (on the remote commander)

* For operation on the TV, press NEXT+/PREV= button once.

Note

- It may take a few seconds after the OPEN/CLOSE 6 button is pressed to open the disc tray.

To switch the PBC functions



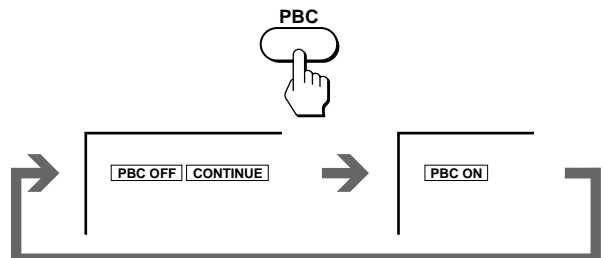

Press PBC.



Notes

- You cannot switch on or off the PBC function during the playing of the disc.
- The 0/, P, and 7 button may not work temporarily at some portions while playing the disc with the PBC function set to ON.
- When the unoperable button is pressed while playing the disc with the PBC function set to ON, the " " mark appears.

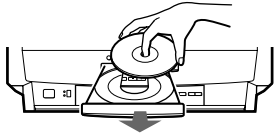
Playing a CD-G

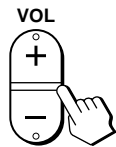
- 1 Press **POWER**.
When the TV is in standby mode after pressing **POWER**, press **POWER** on the remote commander.
- 2 Press **DISC**.

- 3 Press **OPEN/CLOSE 6**, and place the disc on the disc tray.
 
- 4 Press **SELECT z** on the remote commander or **SELECT ^** on the TV.

- 5 Press **VOL +/-** on the remote commander or **VOLUME +/-** on the TV to adjust the volume.

To stop playback

Press **p**.



When you want to	Press
Pause	P (on the remote commander) SELECT ^ (on the TV)
Resume play after pause	SELECT z, P (on the remote commander) SELECT ^ (on the TV)
Go to the next track	NEXT +* ¹
Go back to the preceding track	PREV =* ¹
Stop play	p
Select a track number	Number buttons* ²





*¹ For operation on the TV, press the NEXT+/PREV= button once.

*² To select a track with a number over 10, press -/-- before the number buttons.

Notes

- It may take a few seconds after the **OPEN/CLOSE 6** button is pressed to open the disc tray.
- The picture may be disturbed when:
 - **RESUME** is pressed after stop.
 - **)** or **0** is pressed during playing back.
 - **NEXT+** or **PREV=** on the TV is pressed continuously during playing back.

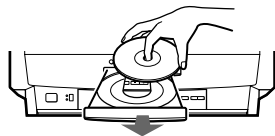
Playing an audio CD

- 1 Press **POWER**.
When the TV is in standby mode after pressing **POWER**, press **POWER** on the remote commander.
- 2 Press **DISC**.

- 3 Press **OPEN/CLOSE 6**, and place the disc on the disc tray.
 
- 4 Press **SELECT z** on the remote commander or **SELECT ^** on the TV.

- 5 Press **VOL +/-** on the remote commander or **VOLUME +/-** on the TV to adjust the volume.

To stop playback

Press **p**.

When you want to	Press
Pause	P (on the remote commander) SELECT ^ (on the TV)
Resume play after pause	SELECT z, P (on the remote commander) SELECT ^ (on the TV)
Go to the next track	NEXT +* ¹
Go back to the preceding track	PREV =* ¹
Stop play	p
Resume play after stop	RESUME (on the remote commander)
Scan forward) (on the remote commander) NEXT +* ² (on the TV)
Scan back	0 (on the remote commander) PREV =* ² (on the TV)
Select a track number	Number buttons* ³ (on the remote commander)

*¹ For operation on the TV, press the NEXT+/PREV= button once.

*² For operation on the TV, keep pressing the NEXT+/PREV= button.

*³ To select a track with a number over 10, press -/-- before the number buttons.

Note

- It may take a few seconds after the **OPEN/CLOSE 6** button is pressed to open the disc tray.

Selecting the disc color system

You can select the color system for the disc you want to play back.

1 Press MENU.

The main menu appears.

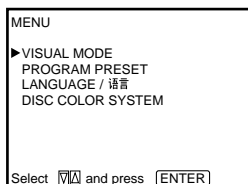

2 Press \triangleright or ϕ to select "DISC COLOR SYSTEM" and press ENTER.

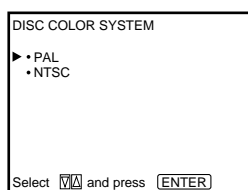

3 Press \triangleright or ϕ to select the DISC COLOR SYSTEM PAL or NTSC.

The color system and the picture size are changed.

4 Press MENU to go back to the original screen.

Note

- You cannot change the color system during the playing of the disc.

Using the on-screen display (DISC) mode

You can check the operating status and the information on the TV screen.

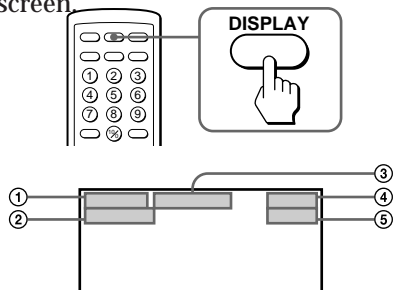

Press DISPLAY.

- Track number/Scene number
- REPEAT mode, PBC ON/OFF, SELECT and number
- Time number
- Playing status, Disc type
- STEREO L or R, Karaoke PON

Playing repeatedly

You can play tracks repeatedly in any play mode.

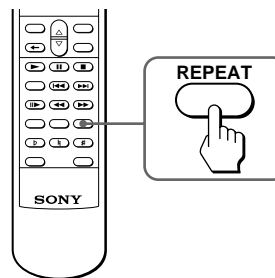

CONTINUE b REPEAT 1 b REPEAT ALL
└────────── AUTO PAUSE ─────────┘

Press REPEAT in stop or playback mode until "REPEAT 1" or "REPEAT ALL" or "AUTO PAUSE" appears in the TV screen.

REPEAT 1: The unit repeats the selected 1 track.

REPEAT ALL: The unit repeats all tracks.

AUTO PAUSE: The unit pauses at the start of every track.

To cancel repeat play

Press REPEAT repeatedly until "CONTINUE" appears.

Note

- You cannot change the repeat operation mode with the PBC function set to ON.

EN

Selecting the disc sound

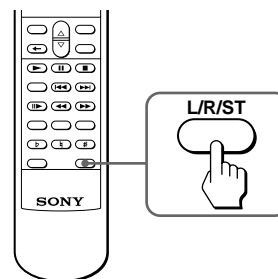

Press L/R/ST.

Each time you press L/R/ST, the screen changes as follows.

STEREO b L b R
└──────────┘

Note

- When you select L (or R), the sound of the left (or right) channel is output from both speakers.

Karaoke sing-along

You can play karaoke (sing along) with CDs.

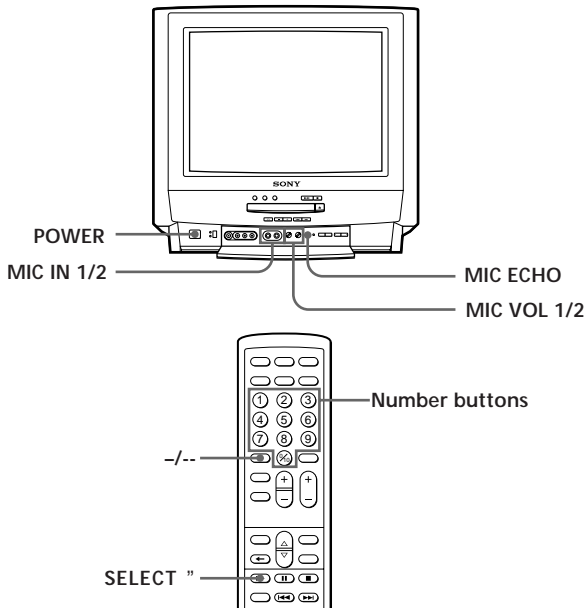

1 Press **POWER**.



2 Press **DISC**.



3 Set the **MIC VOL 1** and **2** control on the unit to **MIN**, then plug the microphone into the **MIC IN 1** or **2** jack.

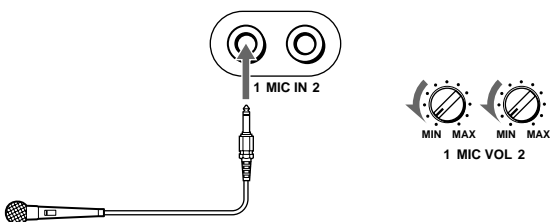

4 Press **OPEN/CLOSE 6**, and place the disc on the disc tray.

5 Press **SELECT "**.



6 Turn the **MIC VOL 1/2** control to adjust the microphone volume.



7 Turn the **ECHO VOL** control to adjust the strength of echo.



To reduce the vocal

Press the **L/R/ST** button to reduce a vocal while playing a multiplex disc.

Note

- It may take a few seconds after the **OPEN/CLOSE 6** button is pressed to open the disc tray.

Changing the pitch (Key Control)

While you are singing, you can change the pitch of the song in half tone pitch.

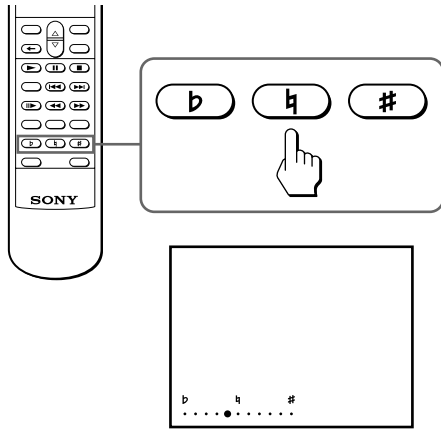

Press n or ~ on the remote repeatedly to set the pitch you want.
The pitch you set appears on the TV screen.

To return the original key

Press N.

Note

- Stereo effect is reduced when the pitch is changed.

Singing along with non-karaoke discs (Karaoke Pon)

You can enjoy karaoke with a stereo recorded disc, even if it is a non-karaoke disc, by reducing the singer's voice.

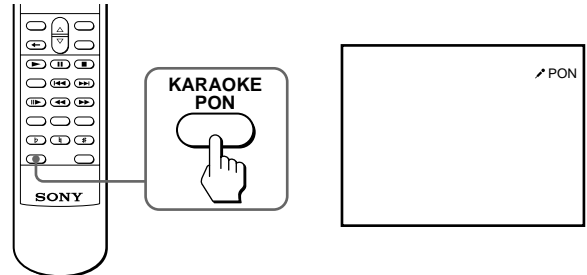

Press KARAOKE PON.

“ / PON” appears on the TV screen.

The singer's voice is reduced so that you can enjoy karaoke. However, the stereo effect is also reduced.

To cancel Karaoke Pon

Press KARAOKE PON again.

Notes

- The singer's voice and instruments are reduced for monaural recorded source.
- The singer's voice may not be reduced completely even in the stereo recorded source for the following reasons;
 - Only a few instruments are playing
 - A duet is being played
 - The source has strong echoes or chorus
 - The singer's voice on the source deviates from the center

EN

Using the Sleep Timer

You can set the TV to turn off automatically after the period of time you want.

Press **SLEEP**.

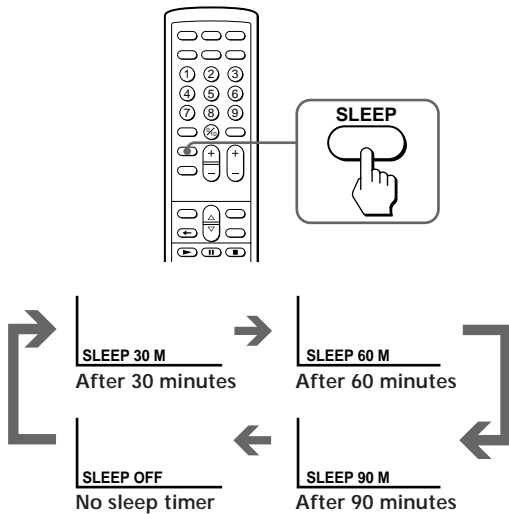

One minute before the TV switches into standby mode a message “Good night” is displayed on the screen. To cancel the Sleep Timer, press SLEEP repeatedly until “SLEEP OFF” appears, or turn the TV off.

Using the Wake Up Timer

You can set the TV to turn on automatically after the period of time you want.

1 Press **WAKE UP**.

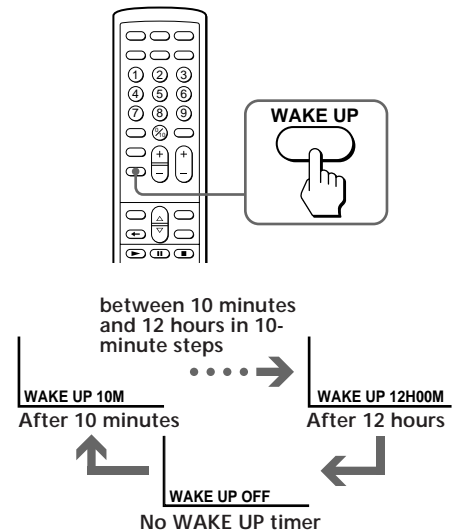

2 Press **POWER** on the remote commander. After the selected period of time, the TV is turned on and a message “Hello” is displayed on the screen. When no operation is done for 2 hours after the TV is turned on, the TV is set in standby mode.

To erase the message
Press any button on the TV or the remote commander.

To cancel the wake up timer
Press WAKE UP repeatedly until “WAKE UP OFF” appears.

Adjusting the picture mode

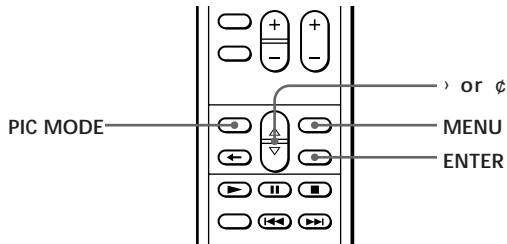

Selecting the picture mode

Press PIC MODE until the mode you want appears.

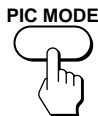

Each time you press PIC MODE, the screen changes as follows:

The adjusted picture control levels are stored. High contrast picture Less contrast picture Soft picture (good for video games)

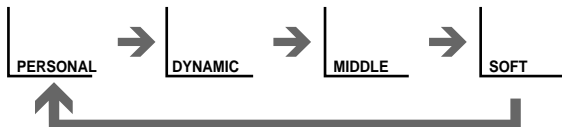

You can also select the mode from the menu.

- 1 Press **MENU**.
The main menu appears.
- 2 Press › or ◂ to select “VISUAL MODE” and press **ENTER**.

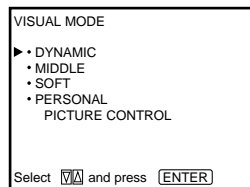

- 3 Press › or ◂ to select the desired **VISUAL mode** and press **ENTER**.

Note

- If you change the picture mode after the following adjustments, the adjustment changes in accordance with the picture mode.

Additional Operations

Adjusting the picture mode settings

- 1 Press **MENU**.
The main menu appears.

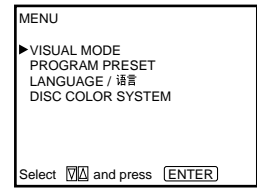

- 2 Press › or ◂ to select “VISUAL MODE” and press **ENTER**.

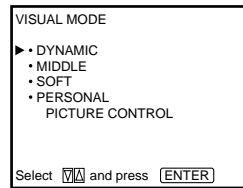

- 3 Press › or ◂ to select “PICTURE CONTROL” and press **ENTER**.

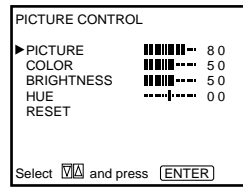

- 4 Press › or ◂ to adjust the item and press **ENTER**.

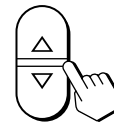

- 5 Adjust the picture with › or ◂ and press **ENTER**. With each press the vertical bars increase or decrease and the figure at the right margin changes to show the control level.

- 6 To adjust other items, repeat steps 4 and 5.

- 7 Press **MENU** to go back to the original screen.

Effect of each control

PERSONAL ADJUSTMENT	Effect
PICTURE	Less [Bar Chart] More
COLOR	Less [Bar Chart] More
BRIGHTNESS	Darker [Bar Chart] Brighter
HUE*	Reddish [Bar Chart] Greenish
RESET	Resets all the items to the factory preset levels.

* The HUE adjustment is available only for the NTSC color system.

The adjusted control levels are stored in “PERSONAL.”

Muting the sound

Press **MUTING**.

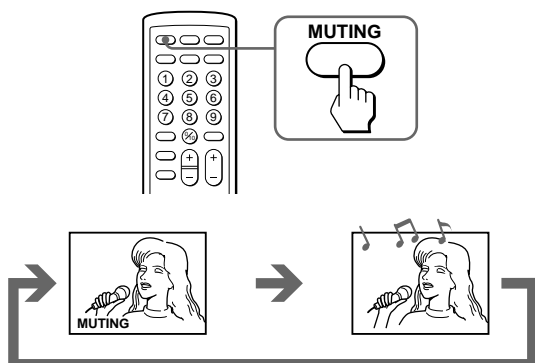

Listening with headphones

Plug the headphones (not supplied) to the 2 (headphones) jack inside the front panel on the TV. The sound from the speaker is shut off.

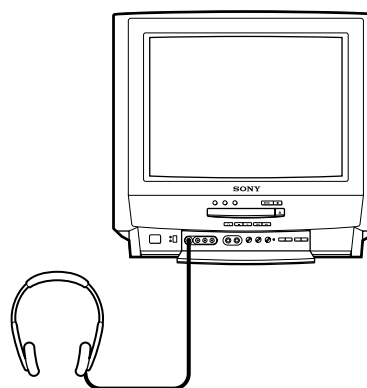

EN

Troubleshooting

If you have any problems, read this manual again and check the countermeasure for each of the symptoms listed below.

If the problem persists, contact your nearest authorized service center or dealer.

Snowy picture Noisy sound

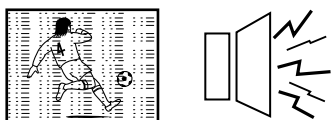

- / Check the antenna.
- / Check the antenna connection on the TV and on the wall.
- / Check the TV SYSTEM setting.

Dotted lines or stripes

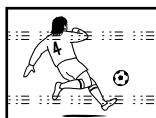

- / This may be caused by local interference (e.g. cars, neon signs, hair dryers, etc.). Adjust the antenna for minimum interference.

Double images or "ghosts"



- / This may be caused by reflections from nearby mountains or buildings. A highly directional antenna may improve the picture.

Good picture Noisy sound

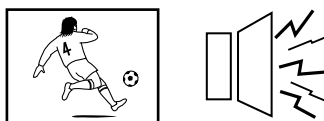

- / Check the TV SYSTEM setting.

No picture No sound

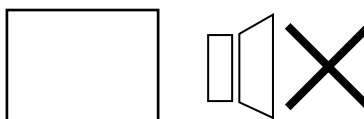

- / Press POWER.
- / Check the antenna connection.
- / Check the VCR connections.
- / Check the power cord connection.
- / Check the standby mode.

Good picture No sound

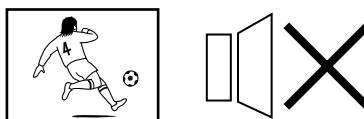

- / Press VOLUME +.
- / Press MUTING.
- / Check the 2 (headphones) jack.

No color



- / Adjust the COLOR level in the on-screen display.

TV cabinet creaks

- / Even if the picture or the sound is normal, changes in the room temperature sometimes make the TV cabinet expand or contract, making a noise. This does not indicate a malfunction.

The CD doesn't play

- / There's no disc inside ("Please load a disc" appears).
- / Insert the disc with the label side up on the disc tray correctly.
- / Clean the disc.
- / Be sure that the disc can be played with this unit.
- / Moisture has condensed inside the unit. Leave the unit for more than one hour with the disc tray open.

No sound from the microphone

- / Switch the microphone on.
- / Turn the MIC VOL 1 or 2 control clockwise.

Howling

- / Move the microphone away from the speakers.
- / Lower the volume.
- / Lower the microphone volume or echo level.

The remote control doesn't function.

- / Remove the obstacles in the path of the remote and the TV.
- / Point the remote at the remote sensor on the TV.
- / Replace the battery in the remote control with a new one if it is weak.

The Video CD picture size is wrong.

- / Check the DISC COLOR SYSTEM.

Notes on CDs

On handling CDs

- To keep the disc clean, handle the disc by its edge. Do not touch the surface.
- Do not stick paper or tape on the disc.

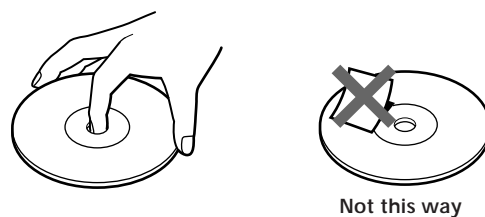

- Do not expose the disc to direct sunlight or heat sources such as hot air ducts, nor leave it in a car parked in direct sunlight as there can be considerable rise in temperature inside the car.
- After playing, store the disc in its case.

On cleaning

- Before playing, clean the disc with a cleaning cloth. Wipe the disc from the center out.

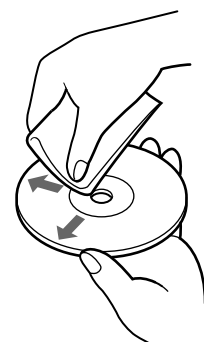

- Do not use solvents such as benzine, thinner, commercially available cleaners or anti-static spray intended for vinyl LPs.

EN

Receivable channels and channel display

Specifications

System	Area	Channel coverage	Channel display	
B/G, H	Middle East /Asia	E-2 to E-12	C02 to C12	
		E-21 to E-69	C21 to C69	
	Indonesia	1A	C01	
		2 to 11	C03 to C12	
	Morocco	M-4 to M-7	C70 to C73	
	M-8 to M-10	C08 to C10		
CATV	S-01 to S-05	S42 to S46		
	S-1 to S-41	S01 to S41		
I	Hong Kong/ United Kingdom	B-21 to B-69	C21 to C69	
	Ireland	A, B, C,.....J	C01 to C09	
	South Africa	4 to 13	C04 to C13	
		21 to 68	C21 to C68	
	Angola	1	C00	
		2 to 3	C02 to C03	
CATV	S-01 to S-05	S42 to S46		
	S-1 to S-41	S01 to S41		
D/K,K1	East European countries	R-1 to R-2	C01 to C12	
		R-21 to R-60	C21 to C60	
	China	C-1	C01	
		C-2	C02	
		C-3	C13	
		C-4	C03	
		C-5	C04	
		C-6	C14	
		C-7 to C-12	C06 to C11	
		C-13 to C-24	C21 to C32	
		C-25 to C-47	C38 to C60	
		C-48 to C-57	C61 to C70	
		Ivory Coast	1 to 3	C71 to C73
		CATV	S-1 to S-39	S01 to S39
M	America	A-2 to A-13	C02 to C13	
		A-14 to A-83	C14 to C83	
CATV	A-8	S01		
	A-7	S05		
	A-6	S06		
	A-5 to A-1	S95 to S99		
	A to E	S14 to S18		
	F to W+28	S19 to S64		
	W+29 to W+58	S65 to S94		

TV section

Television system	B/G, I, D/K, M
Color system	PAL/SECAM/NTSC ^{3.58} / NTSC ^{4.43}
Channel coverage	See "Receivable channels and channel display"
Picture tube	Trinitron 21 inches (approx. 54.5 cm measured diagonally)
Antenna in	75-ohm antenna socket for VHF/ UHF
Speaker	3.5W × 2

Disc section

Laser	Semiconductor laser
Wavelength	760 - 800 nm
Disc format	Audio CD/CD-G/Video CD (PAL, NTSC)

Input and outputs

AUDIO OUT	Phono jacks, load impedance over 47 kilohms
VIDEO OUT	Phono jack, 1 Vp-p, load impedance 75 ohms, unbalanced, sync negative
Headphones	Stereo minijack
VIDEO 1/2 IN	Phono jacks, 1 Vp-p, input impedance 75 ohms, unbalanced, sync negative
AUDIO IN	Phono jacks, input impedance over 47 kilohms
MIC IN 1/2	Standard jacks

General

Power requirements	110-240 V, 50/60 Hz
Power consumption	115 W
Operating temperature	-10°C to 40°C (14°F to 104°F)
Storage temperature	-20°C to 60°C (-4°F to 140°F)
Dimensions	Approx. 550 × 525 × 480 mm (w/h/d) incl. projecting parts
Mass	Approx. 24 kg
Supplied accessories	Remote commander (1) Battery R6 (size AA) (1) Band (1) Clamps (2) Wood screws (2)

Design and specifications are subject to change without notice.

Index to parts and controls

- ! Ⓢ VOLUME +/- buttons
- ! Ⓜ PROGR (program) +/- buttons
- ! Ⓢ PREV (previous) = button
- ! Ⓜ NEXT + button
- ! • OPEN/CLOSE 6 button
- ! Ⓜ STOP p button
- @° SELECT ^ button

Front panel

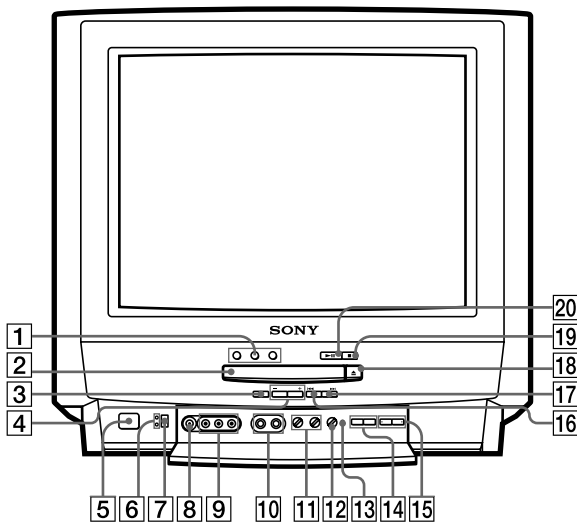

- 1 Function buttons
- 2 Disc tray
- 3 RETURN button
- 4 VCD (Video CD) MENU +/- buttons
- 5 POWER switch
- 6 Lamps
- 7 Remote sensor
- 8 2 (headphones) jack
- 9 VIDEO 2 IN (VIDEO/AUDIO) jacks
- 0 MIC IN 1/2 jacks
- ! Ⓜ MIC VOL 1/2 controls
- !™ MIC ECHO control
- ! Ⓢ TUNER PRESET button

Rear panel

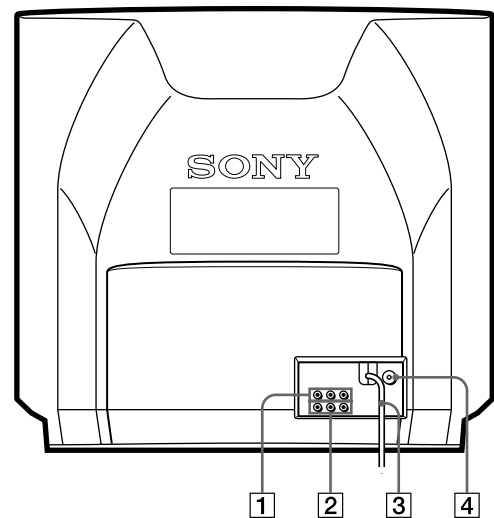

- 1 VIDEO 1 IN (VIDEO/AUDIO) jacks
- 2 VIDEO OUT (VIDEO/AUDIO) jacks
- 3 Power cord
- 4 VHF/UHF antenna terminal

EN

Remote Commander

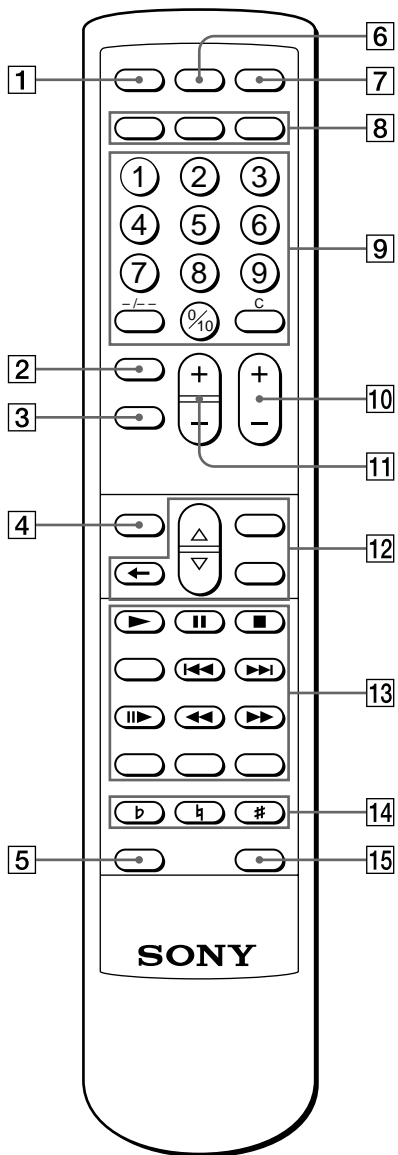

- 1 MUTING button
- 2 SLEEP button
- 3 WAKE UP button
- 4 PIC (picture) MODE button
- 5 KARAOKE PON button
- 6 DISPLAY button
- 7 POWER switch
- 8 Function buttons
- 9 Number buttons
- 0 PROGR (program) +/- buttons
- ! j VOL (volume) +/- buttons
- !™ Menu operation buttons
- ! £ CD operation buttons
- ! ¢ KEY CONTROL buttons
- ! L/R/ST button

