

WARNING

To reduce the risk of fire or electric shock, do not expose this apparatus to rain or moisture.

To reduce the risk of electrical shock, do not open the cabinet. Refer servicing to qualified personnel only.

You are cautioned that any changes or modifications not expressly approved in this manual could void your authority to operate this equipment.

The validity of the CE marking is restricted to only those countries where it is legally enforced, mainly in the countries EEA (European Economic Area).

Owner's Record

The model number is located at the front side of the battery box.

The serial number is located in the battery box.

Record these numbers in the spaces provided below. Refer to them whenever you call upon your Sony dealer regarding this product.

Model No. MDR-NC22 _____
Serial No. _____

Features

- Noise canceling headphones reduce ambient noise, and provide a quieter environment to enhance audio entertainment. Ambient sound is reduced by synthesizing with a sound in opposite phase produced by the noise canceling circuit.
- Ultra compact headphones fits comfortably in the ears and closed type headphone structure delivers deep bass sound.
- 3 sizes soft silicon rubber earbuds are used for stable and comfortable fit in the ears.
- Operates as passive headphones when noise canceling circuit is not activated.
- Built-in monitor function to hear surrounding sound without taking off the headphones.
- Plug adaptor is supplied to connect directly to stereo or dual jack of in-flight music services.

Installing a battery

- Open the lid on the rear of the battery box.

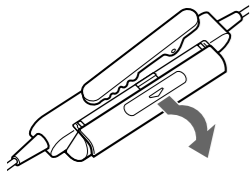

- Insert one R03 (size AAA) battery, matching the + and – on the battery to the + and – in the battery compartment.

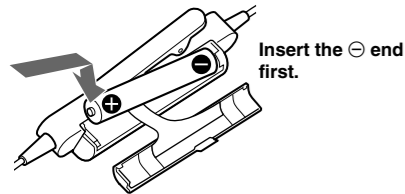

- Correctly align the lid and battery box, then slide to click shut.

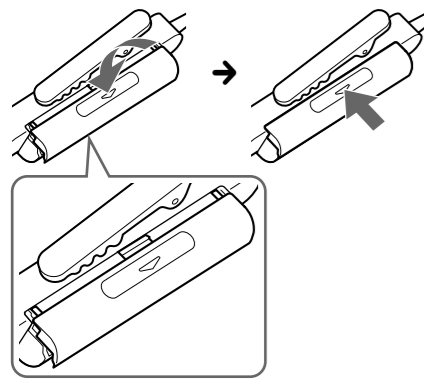

Note

If the lid is forcibly pushed down after the claw of the lid is inserted in the battery box, it may be damaged.

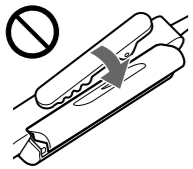

Removing the battery

- Open the lid.

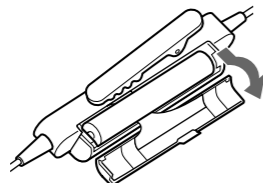

- Pull the lid lightly in the direction of the arrow.

Note

The battery may jump out when the lid is pulled. Pull the lid while placing a finger on the battery.

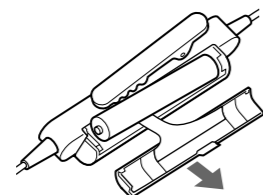

- Correctly align the lid and battery box, then slide to click shut.

Note

Store the ribbon in the battery compartment to prevent it being pinched by the lid.

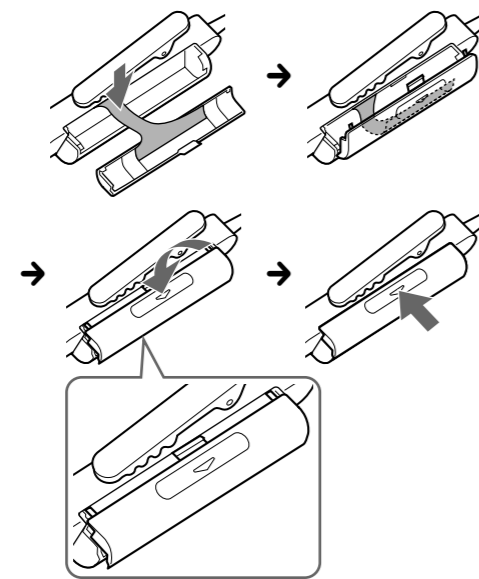

Note

If the lid is forcibly pushed down after the claw of the lid is inserted in the battery box, it may be damaged.

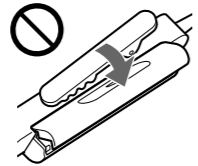

Battery life	
Battery	Approx. hours*1
Sony alkaline battery LR03 SIZE AAA	50 hours*2
Sony manganese battery R03 SIZE AAA	22 hours*2

*1 1 kHz, 1 mW + 1 mW input

*2 Time stated above may vary, depending on the temperature or conditions of use.

When to replace the battery

Replace the battery with a new one when the POWER indicator dims.

Selecting the earbuds

If the earbuds do not fit your ears correctly, low-bass sound may not be heard. To enjoy better sound quality, change the earbuds to another size, or adjust the earbuds position to sit on your ears comfortably and fit your ears snugly. The M size earbuds are attached to the headphones before shipment. If you feel the M size earbuds do not suit your ears, replace them with the supplied S or L size earbuds. When you change the earbuds, turn to install them firmly on the headphones to prevent the earbud from detaching and remaining in your ear.

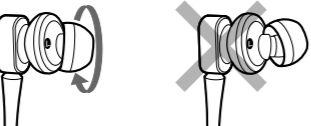
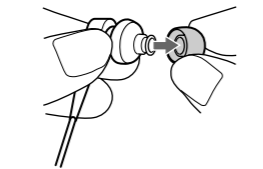

Listening to music

- Connect the headphones to the AV equipment.

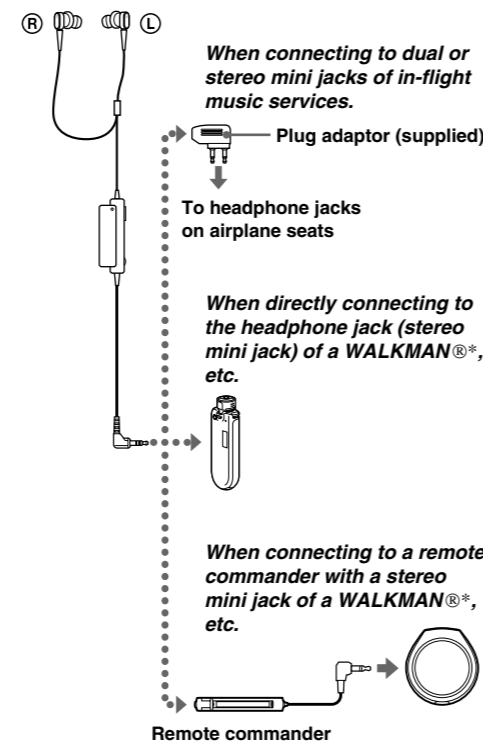

- Wear the headphones marked **R** in your right ear and the one marked **L** in your left ear. Push the earbud into your ear carefully so that the earbud fits the hole of your ear snugly.

Note

Unless the earbuds correctly fit your ears, noise canceling will not function.

Adjust the earbuds position to sit on your ear comfortably so that they fit your ears snugly.

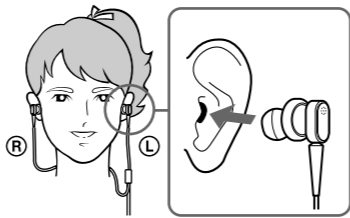

- Turn on the power of the headphones. The power indicator lights in red. The power switch is located on the battery box. When power is turned on, ambient noise is reduced, and you can listen to music more clearly at a lower volume.

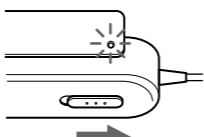

- Turn on the power of the AV equipment.

* "WALKMAN" and "WALKMAN" logo are registered trademarks of Sony Corporation.

To hear ambient sound for safety

When the power switch is set to on, noise canceling can be deactivated while the MONITOR button is pressed so that you can hear ambient sound.

MONITOR button

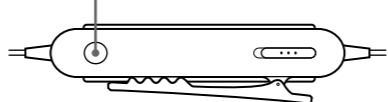

Notes on using on the airplane

- The supplied plug adaptor can be connected to the dual or stereo mini jacks of in-flight music services.

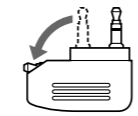
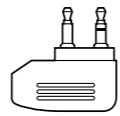

- Do not use the headphones when use of electronic equipment is prohibited or when use of personal headphones for in-flight music services is prohibited.

If you have any questions or problems concerning the system that are not covered in this manual, please consult the nearest Sony dealer.

After listening to music

Turn off the power of the headphones.

Notes

- The noise canceling function is only effective for noise in the low frequency band. Although noise is reduced, it is not canceled completely.
- Do not cover the microphone of the headphones with your hands. The noise canceling function may not work properly.

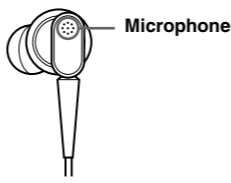

- The noise canceling function may not work properly unless the headphones are put on firmly.
- You can use the headphones even without turning on the power. In this case, the noise canceling function is not active, and the headphones operate as passive headphones.
- After you turn on the power of the headphones, you may hear a slight hiss. This is the operating sound of the noise canceling function, not a malfunction.
- In a quiet place, or depending on certain noises, you may feel that the noise canceling function is not effective, or that noise is accentuated. In this case, turn off the power of the headphones.
- Interference noise can occur from nearby cellular phones. Should this occur, locate the headphones further away from the cellular phone(s).

Using the clip

You can fasten the battery box by its clip on a shirt pocket.

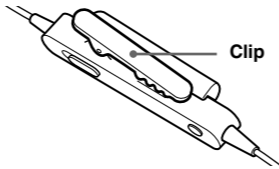

When carrying the headphones

The headphones and the battery box can also be separately stored in the partitioned carrying case (supplied).

Precautions

- Clean the headphones with a soft dry cloth.
- Do not leave the jack plug dirty otherwise the sound may be distorted.
- Be sure to bring the headphones to the Sony dealer when requiring a change of earbuds or repair work.
- Do not leave the headphones in a location subject to direct sunlight, heat or moisture.
- Do not subject the headphones to excessive shock.
- Handle the driver units carefully.
- To clean the earbuds, first remove them from the headphones, and then clean them with water and mild detergent. After cleaning, dry each earbud carefully before use.
- The earbuds will need to be replaced from time to time. If they are worn out by daily use or longtime storage, replace them with new ones.
- If you fell drowsy or sick while using these headphones, stop use immediately.
- Install the earbuds firmly onto the headphones. If an earbud accidentally detaches and is left in your ear, it may cause injury.

Notes on headphones

Preventing hearing damage

Avoid using headphones at high volume. Hearing experts advise against continuous, loud and extended play. If you experience a ringing in your ears, reduce the volume or discontinue use.

Do not use headphones while driving and cycling, etc.

As headphones reduce outside sounds, they may cause a traffic accident. Also, avoid listening with your headphones in situations where hearing must not be impaired, for example, a railroad crossing, a construction site, etc.

Note on static electricity

In particularly dry air conditions, mild tingling may be felt on your ears. This is a result of static electricity accumulated in the body, and not a malfunction of the headphones.

The effect can be minimized by wearing clothes made from natural materials.

Troubleshooting

No sound

- Check the connection of the headphones and the AV equipment.
- Check that the connected AV equipment is turned on.
- Turn up the volume of the connected AV equipment.
- Replace the battery.

Muffled sound

- Turn down the volume of the connected AV equipment.
- Replace the battery.

Specifications

General

Type	dynamic, closed
Driver units	13.5 mm, dome type (CCAW adopted)
Power handling capacity	50 mW
Impedance	20 Ω at 1 kHz (when the power is on) 8.5 Ω at 1 kHz (when the power is off)
Sensitivity	102 dB/mW (when the power is on) 100 dB/mW (when the power is off)
Frequency response	8 – 22,000 Hz
Frequency range of active noise attenuation	50 – 1,500 Hz more than 12 dB at 200 Hz
Cord	1.5 m (59 1/8 in) OFC litz cord, neck-chain (including battery box)
Plug	Gold-plated L type stereo mini plug
Power source	DC 1.5 V, 1 × R03 (size AAA) battery
Mass	Approx. 39 g (1.4 oz) including battery box, cord, and battery

Supplied accessories

Sony R03 (size AAA) battery (1)

Earbuds (S × 2, M × 2, L × 2)

Carrying pouch (1)

Plug adaptor for in-flight use* (single/dual) (1)

Operating Instructions (1)

* May not be compatible with some in-flight music services.

Design and specifications are subject to change without notice.