

# FM/AM Clock Radio

## Operating Instructions

## DREAM MACHINE

Dream Machine is a trademark of Sony Corporation.

### ICF-C205

© 2006 Sony Corporation

Printed in China

<http://www.sony.net/>



Printed on 100% recycled paper using VOC (Volatile Organic Compound)-free vegetable oil based ink.

## WARNING

To reduce the risk of fire or electric shock, do not expose this apparatus to rain or moisture.

To avoid electrical shock, do not open the cabinet. Refer servicing to qualified personnel only.

Do not install the appliance in a confined space, such as a bookcase or built-in cabinet.

To reduce the risk of fire or electric shock, do not place objects filled with liquids, such as vases, on the apparatus.

Connect the apparatus to an easily accessible AC outlet. Should you notice an abnormality in the apparatus, disconnect the main plug from the AC outlet immediately.

## Features

- 0.7 inch green LED display
- Single alarm
- Power back-up to keep the clock during a power interruption, using a 6F22 battery (not supplied).

## Precautions

- Operate the unit on the power sources specified in "Specifications".
- The name plate indicating operating voltage, etc. is located on the bottom of the unit.
- To disconnect the power cord (mains lead), pull it out by the plug, not by the cord.
- The unit is not disconnected from the AC power source (mains) as long as it is connected to the wall outlet, even if the unit itself has been turned off.
- Do not leave the unit in a location near a heat source such as a radiator or air duct, or in all place subject to direct sunlight, excessive dust, mechanical vibration, or shock.
- Allow adequate air circulation to prevent internal heat build-up. Do not place the unit on a surface (a rug, a blanket, etc.) or near materials (a curtain) which might block the ventilation holes.
- Should any solid object or liquid fall into the unit, unplug the unit and have it checked by a qualified personnel before operating it any further.
- To clean the casing, use a soft cloth dampened with a mild detergent solution.

If you have any questions or problems concerning your unit, please consult your nearest Sony dealer.

### Disposal of Old Electrical & Electronic Equipment (Applicable in the European Union and other European countries with separate collection systems)



This symbol on the product or on its packaging indicates that this product shall not be treated as household waste. Instead it shall be handed over to the applicable collection point for the recycling of electrical and electronic equipment. By ensuring this product is disposed of correctly, you will help prevent potential negative consequences for the environment and human health, which could otherwise be caused by inappropriate waste handling of this product. The recycling of materials will help to conserve natural resources. For more detailed information about recycling of this product, please contact your local Civic Office, your household waste disposal service or the shop where you purchased the product.

## Specifications

### Time display:

12-hour system

### Frequency range:

FM: 87.5 - 108 MHz  
AM: 530 - 1 605 kHz

### Speaker:

Approx. 5.7 cm (2 ¼ inches) dia., 8 Ω

### Power output:

150 mW (at 10 % harmonic distortion)

### Power requirements:

230 V AC, 50 Hz

For the power back-up function: 9 V DC, one 6F22 battery

### Battery life:

Approx. 80 hours, using Sony 006P (6F22) battery

### Dimensions:

Approx. 143 × 54.5 × 117.5 mm (w/h/d)  
(5 ¾ × 2 ¼ × 4 ¾ inches) incl. projecting parts and controls

### Mass:

UK: Approx. 437 g (15.4 oz.) not incl. battery  
Australia: Approx. 396g (14.0 oz) not incl. battery

Design and specifications are subject to change without notice.



Lead-free solder is used for soldering. Halogenated flame retardants are not used in printed wiring boards.

There is a tactile dot beside **VOLUME** to show the direction to turn up the volume.

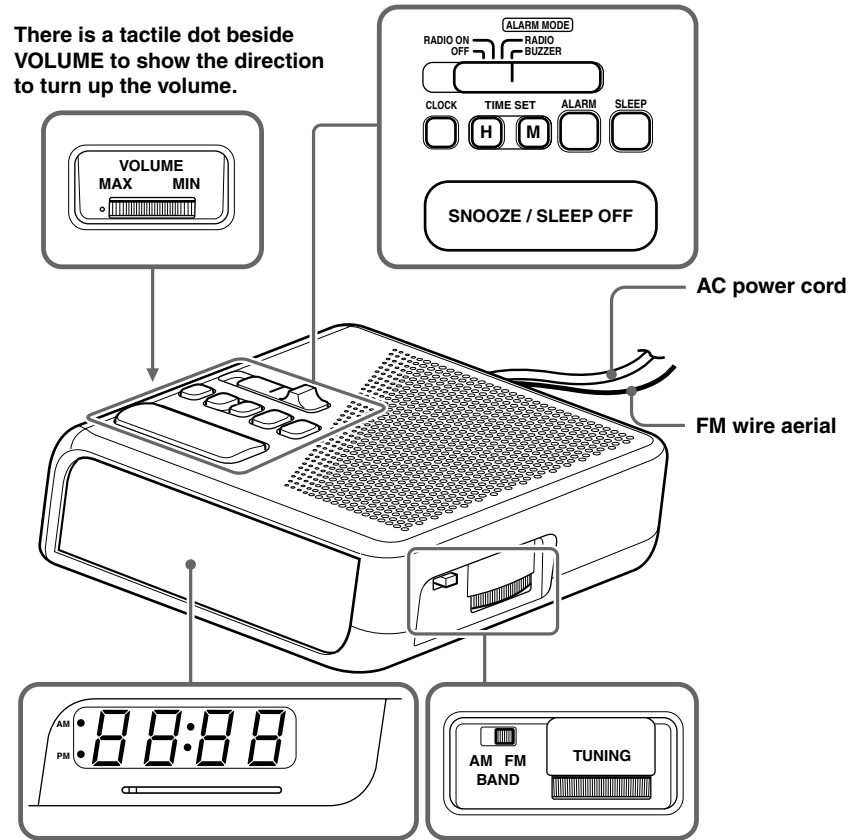

## Installing the battery

To keep good time, your Dream Machine needs one 6F22 battery (not supplied), in addition to house current. The battery keeps the clock operating in the event of a power interruption. Before setting the time on your Dream Machine, install the battery with correct polarity.

### Installing the battery (see Fig. A-①)

Clip the battery in place observing correct polarity, and insert it in the battery compartment until it clicks into position.

### Removing the battery (see Fig. A-②)

Turn the unit upside down and push the battery forward from the battery compartment.

- After a power interruption, the displayed time may not always be correct (it may gain or lose about 10 minutes per hour).

### Knowing when to replace the battery

To check battery power, unplug the AC power cord from the wall outlet and plug it in again after a few minutes. If the displayed time is incorrect, replace the battery with a new one.

### Battery warning

When the unit will be left unplugged for a long time, remove the battery to avoid undue battery discharge and damage to the unit from battery leakage.

## Setting the Clock

- 1 Plug in the unit.  
The display will flash "AM 12:00".
- 2 To set the hour, while holding down **CLOCK**, press **TIME SET H**. When the correct hour appears in the display, release **CLOCK**.
- 3 To set the minute, while holding down **CLOCK**, press **TIME SET M**. When the correct minute appears in the display, release **CLOCK**.  
The clock will begin to operate when you release **TIME SET M**.

- Each press on **TIME SET H** or **TIME SET M** advances the displayed number by one.
- The minute digits advance to "00" after "59". The hour digits do not advance by pressing **TIME SET M**.
- To adjust the time exactly to the second, set the time one minute behind the time you want to set. Press **TIME SET M** simultaneously with the time signal.

## Operating the Radio

- 1 Set the function selector to **RADIO ON** to turn on the radio and adjust **VOLUME**.
  - 2 Select **BAND** and tune in to a station using **TUNING**.
- To turn off the radio, set the function selector to **OFF**.

## Improving the reception

- FM:** Extend the FM wire aerial fully to improve reception.
- AM:** Rotate the unit horizontally for optimum reception. A ferrite bar aerial is built into the unit.

Do not operate the unit over a steel desk or metal surface, as this may lead to interference of reception.

## Setting the Alarm

To set the radio alarm, first tune in to a station and adjust the volume.

- 1 To set the hour for alarm, while holding down **ALARM**, press **TIME SET H**. When the desired hour appears in the display, release **ALARM**.
- 2 To set the minute for alarm, while holding down **ALARM**, press **TIME SET M**. When the desired minute appears in the display, release **ALARM**.
- 3 Set the function selector to **ALARM MODE • RADIO** or **ALARM MODE • BUZZER**.  
The alarm will come on at the preset time and automatically turn itself off after 119 minutes.

- To shut off the alarm, set the function selector to **OFF**.  
To sound the alarm at the preset time the next day, set the function selector to **ALARM MODE • RADIO** or **ALARM MODE • BUZZER** again.
- To deactivate the alarm, set the function selector to **OFF**.
- To doze a few more minutes, press **SNOOZE/SLEEP OFF**.  
The alarm will shut off but will come on again after about 9 minutes. You can use this function as many times as you like.
- To adjust the radio alarm volume, turn **VOLUME**.  
The buzzer volume is fixed.
- To check the preset time, press **ALARM**.

## Setting the Sleep Timer

Enjoy falling asleep to the radio using the built-in sleep timer that shuts off the radio automatically.

- 1 While listening to the radio, set the function selector to **OFF**.
  - 2 Press **SLEEP**.  
The radio turns on. It will go off after 59 minutes.
- To turn off the radio before the preset time, press **SNOOZE/SLEEP OFF**.
  - Every time you press **SLEEP**, the sleep timer is reset to 59 minutes.
  - When you set the function selector to **ALARM MODE • RADIO** or **ALARM MODE • BUZZER**, if the preset alarm time comes while the sleep timer is operating, the radio or buzzer sounds depending on which you set.

A

